

For Sale

Medical Office

\$1,500,000



17520 Old Jefferson Hwy

Prairieville, Louisiana
70769

For more information

Michael Cashio, CCIM

O: 225 295 0800 | C: 225 247 9812
mcashio@latterblum.com

Andrew D'Ostilio

O: 225 295 0800 | C: 225 678 8851
andrewdos@latterblum.com

Ty Gose, SIOR, CCIM

O: 225 295 0800 | C: 225 297 7808
ty@latterblum.com

Property Highlights

- 9,340 SF Medical Office in Prairieville
- 7,059 SF is turn-key and has been leased to Baton Rouge General Physicians since 2011
- Baton Rouge General vacating the space in the fall of 2020
- 2,281 SF is in shell condition. Can easily be connected to the existing suite or can remain as a separate unit
- Excellent location on Hwy 73 near the corner of Airline Hwy and Hwy 42
- 15+ exam rooms, 5 executive offices, large waiting room, laboratory 3 restrooms, kitchenette, and storage space

Sale Price

\$1,500,000



Property Details

PROPERTY ADDRESS:	17520 Old Jefferson Hwy Prairieville, LA 70769
PROPERTY TYPE:	Office/Medical Office
LOT SIZE:	1 Acre
BUILDING SIZE:	9,340 SF
BUILT-OUT SF:	7,059 SF
SHELL SPACE:	2,281 SF
PARKING SPACES:	65
PARKING RATIO:	6.94
EXAM ROOMS:	15+
EXECUTIVE OFFICES:	5
BATHROOMS:	3
NUMBER OF UNITS:	1-2



Additional Photos



Additional Photos



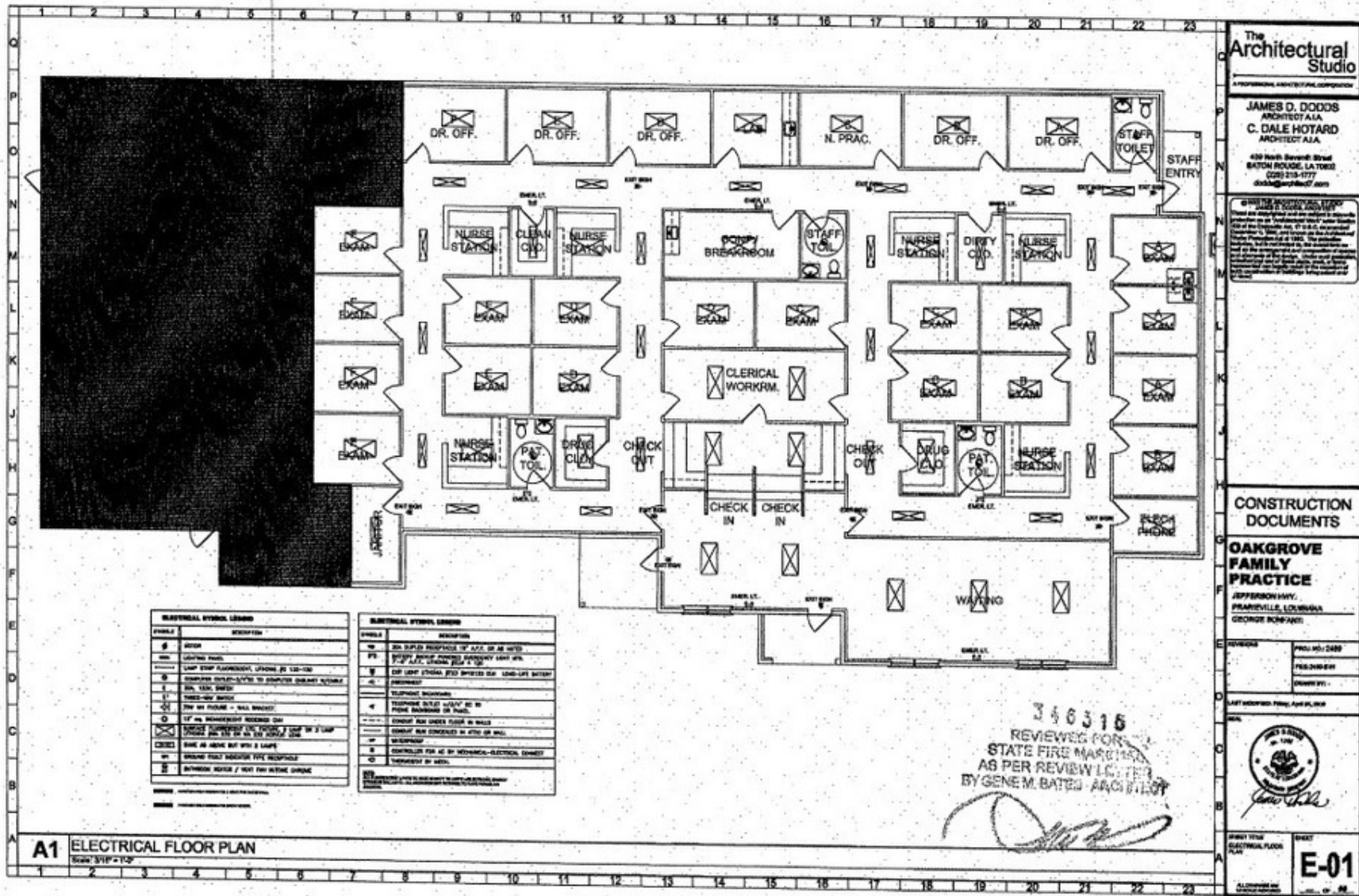

Location Maps

