

4 Acres of Land

193 Hartford Turnpike | Shrewsbury, MA

NAI Glickman Kovago & Jacobs



4 acres of land at signalized corner
for lease/build to suit

- Ideal bank/retail, fast food, gas - convenience store development
- Located directly across from proposed Edgemere Crossing at Flint Pond, a 145,000 sf Market Basket anchored retail development with 250 apartments
- Signalized intersection
- High traffic - commuter route from Rte. 9 and Rte. 140 to Mass Pike (I-90)
- ADT: 27,293 (2018)
- Underserved / higher income side of Shrewsbury
- Strong commercial base / daytime population

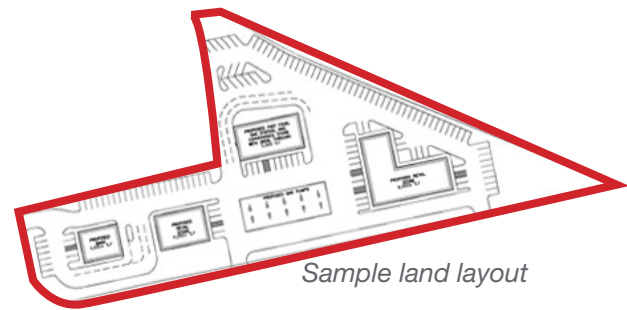

Sample land layout

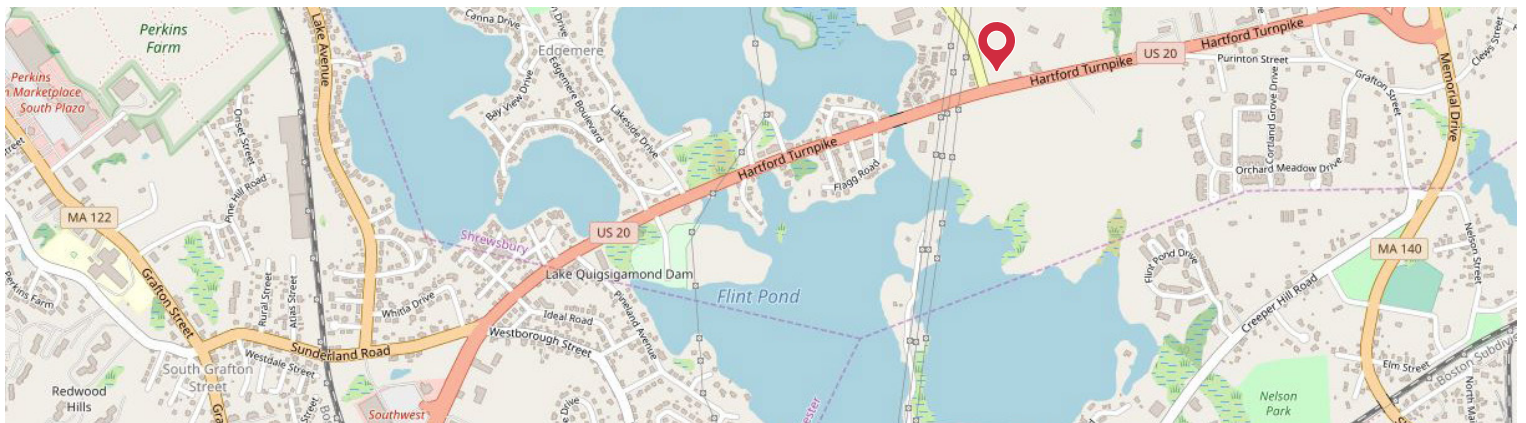

NAI Glickman Kovago & Jacobs

1 Mercantile Street Suite 510 | Worcester MA 01608

Michael Jacobs

774.230.3448

mjacobs@glickmankovago.com