



**19TH ST PATIO**

## JOIN THESE RETAILERS



**CHOPT**



## HIGH PROFILE RETAIL SPACE FOR LEASE IN DUPONT CIRCLE

- 2,165 SF of prominent retail space + 2,995 SF Lower Level available
- Large Outdoor Patio Available
- Space has frontage on both Connecticut Avenue and 19th Street, NW
- Directly atop DuPont Circle Metro Escalators (20,415 RDP)
- Prime visibility to Connecticut Avenue's 27,200 cars per day
- Strong seven day foot traffic
- Fantastic demographics with dense daytime and residential populations

**MATT SKALET**

m skalet@klnb.com | 202.420.7775

**STEVE COMBS**

scombs@klnb.com | 202.420.7776



**MATT SKALET**

m skalet@klnb.com | 202.420.7775

**STEVE COMBS**

scombs@klnb.com | 202.420.7776

# LOCATION

## 1350 CONNECTICUT AVENUE NW - DUPONT CIRCLE

WASHINGTON, DC 20007

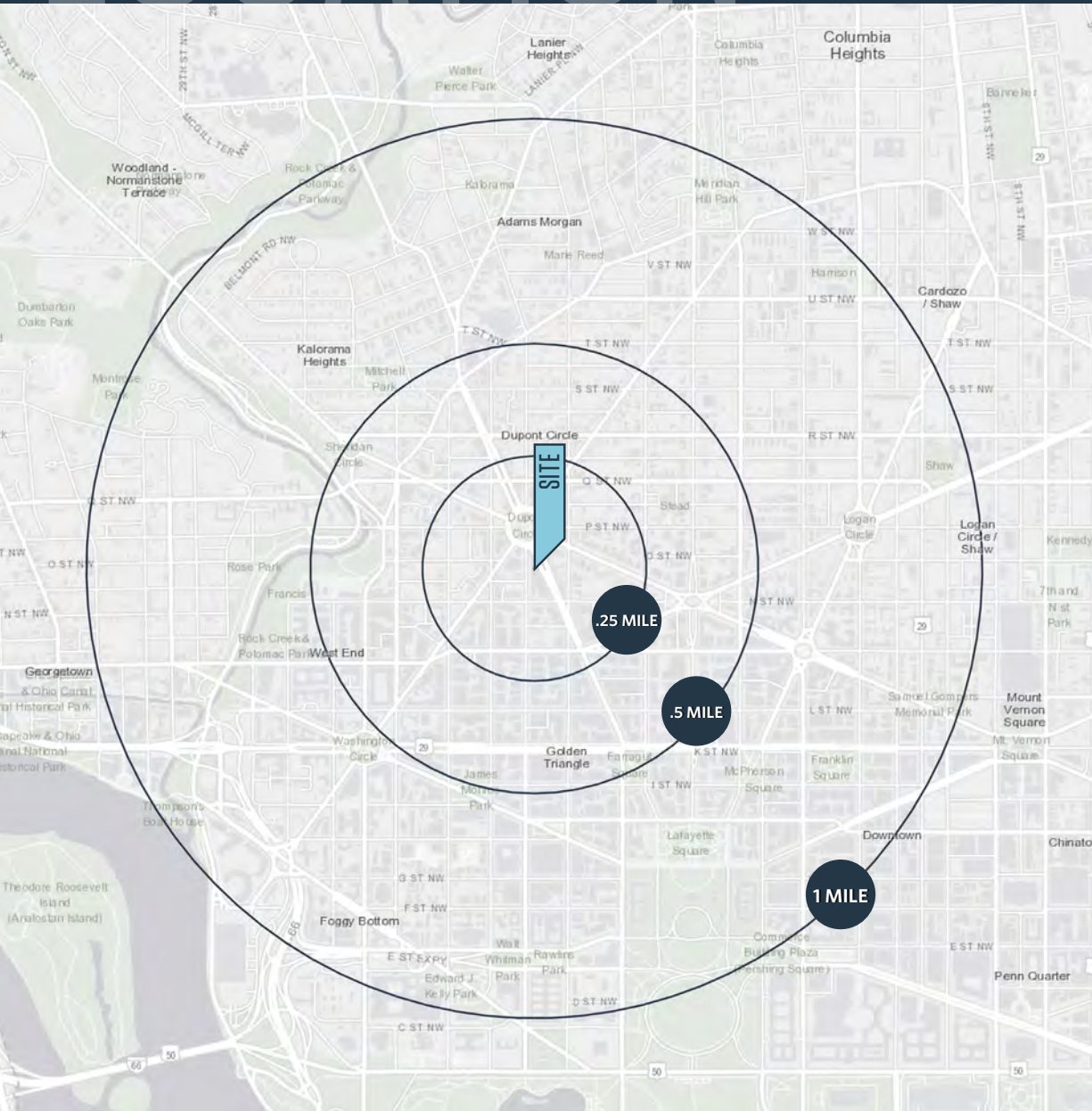

### AVAILABLE SPACE

SIZE	RATE	CONDITION	DELIVERY
2,165 SF Ground Floor	\$105.00 PSF*	Built Out Cafe Space	Immediate
2,995 SF Lower Level	\$30.00 PSF*	Built Out Prep Kitchen and Seating	Immediate

\*Triple Net Charges \$11.50 NNN PSF

### DEMOGRAPHICS | 2019:

	5 MIN	10 MIN	15 MIN	.25-MILE	.5-MILE	1-MILE
Population	4,315	16,420	41,698	4,736	19,044	82,814
Daytime Population	24,954	19,044	169,499	19,940	95,423	234,764
Households	2,969	10,873	26,363	3,249	12,598	47,014
Average HH Income	\$97,116	\$104,168	\$109,622	\$133,988	\$141,101	\$153,501
Food Away From Home	\$17,523,599	\$69,747,641	\$69,747,641	\$19,752,804	\$80,575,887	\$319,900,711

### TRAFFIC COUNTS | 2019:

Connecticut Ave NW	27,200 ADT
19th Street NW	12,600 ADT

**MATT SKALET**

maskalet@klnb.com | 202.420.7775

**STEVE COMBS**

scombs@klnb.com | 202.420.7776



# SITE PLAN

## 1350 CONNECTICUT AVENUE NW - DUPONT CIRCLE

WASHINGTON, DC 20007

### GROUND FLOOR

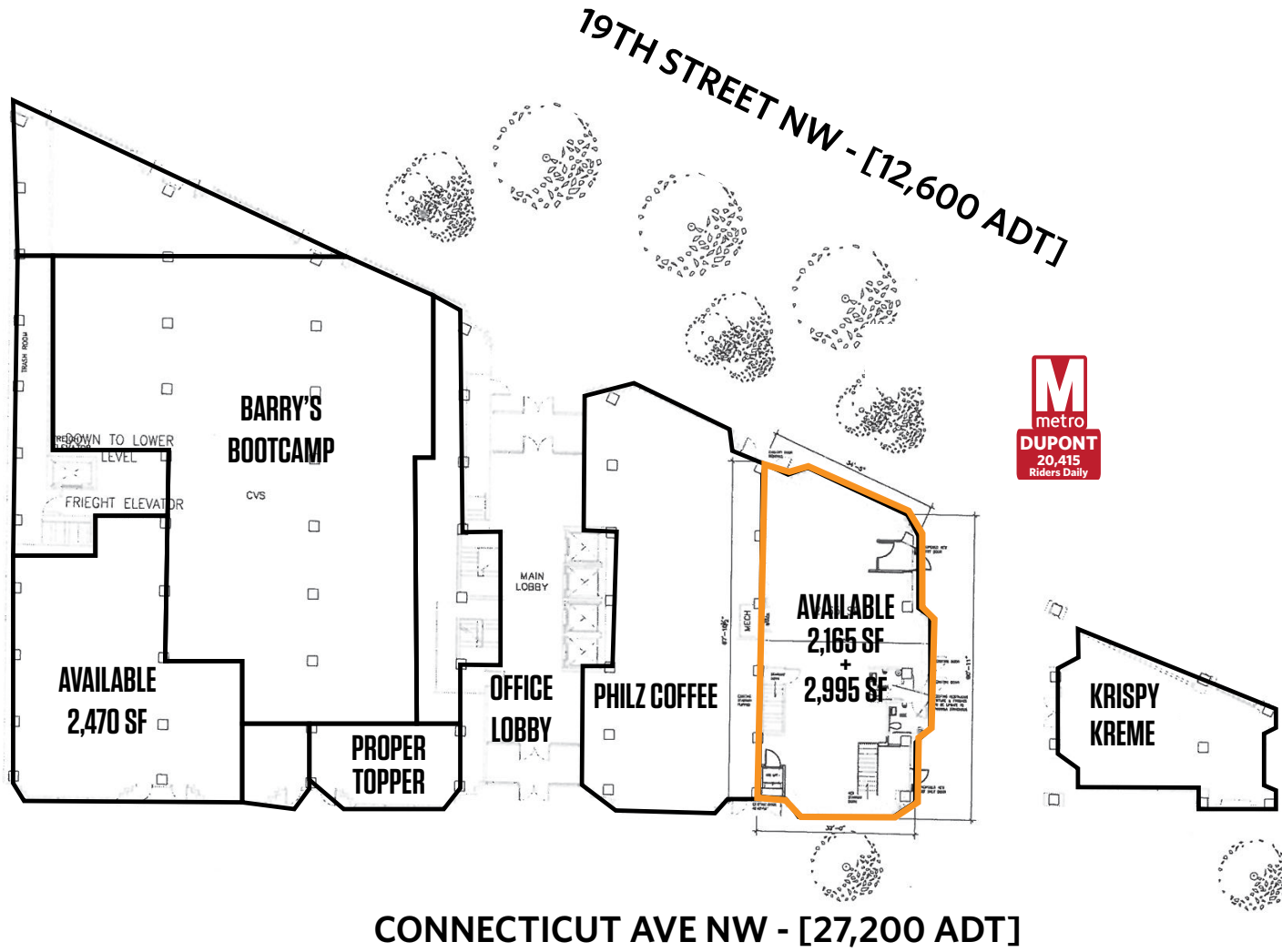

**MATT SKALET**

maskalet@klnb.com | 202.420.7775

**STEVE COMBS**

scombs@klnb.com | 202.420.7776



# SITE PLAN

## 1350 CONNECTICUT AVENUE NW - DUPONT CIRCLE

WASHINGTON, DC 20007

### LOWER LEVEL

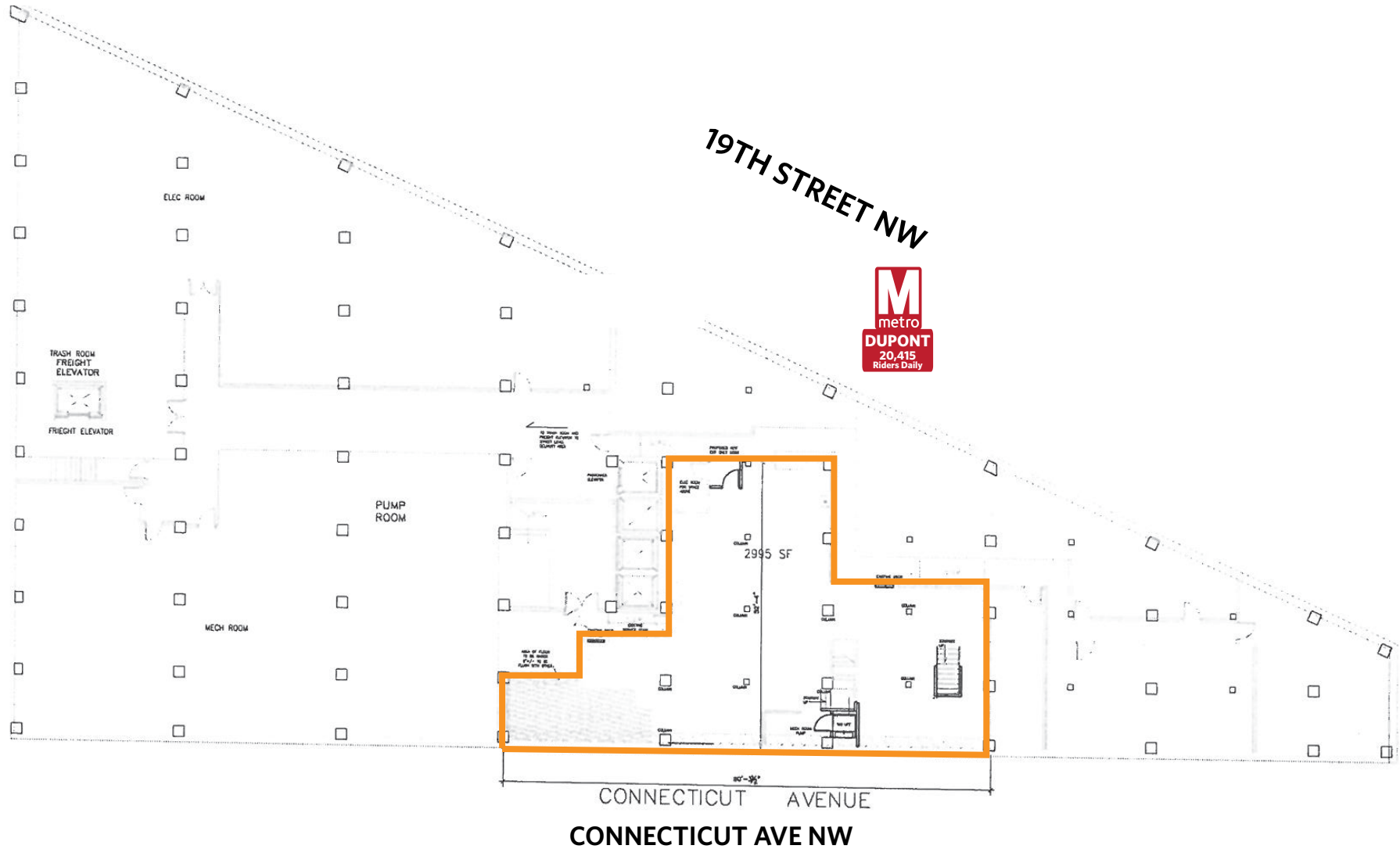

**MATT SKALET**

mkalet@klnb.com | 202.420.7775

**STEVE COMBS**

scombs@klnb.com | 202.420.7776

**klnb**

# PHOTOS

## 1350 CONNECTICUT AVENUE NW - DUPONT CIRCLE

WASHINGTON, DC 20007



MATT SKALET

m skalet@klnb.com | 202.420.7775

STEVE COMBS

scombs@klnb.com | 202.420.7776

klnb



**MATT SKALET**

maskalet@klnb.com | 202.420.7775

**STEVE COMBS**

scombs@klnb.com | 202.420.7776



**MATT SKALET**

mkalet@klnb.com | 202.420.7775

**STEVE COMBS**

scombs@klnb.com | 202.420.7776



**2,165 SF**  
**Street Level**  
**+**  
**2,995 SF**  
**Lower Level**



# 1350 CONNECTICUT AVE NW - DUPONT CIRCLE

WASHINGTON, DC 20036

## FOR MORE INFORMATION, PLEASE CONTACT:

### MATT SKALET

[mskalet@klnb.com](mailto:maskalet@klnb.com)

202-420-7775

### STEVE COMBS

[scombs@klnb.com](mailto:scombs@klnb.com)

202-420-7776

1130 Connecticut Avenue, Suite 600, Washington, DC 20036

.....

[klnb.com](http://klnb.com)



[CLICK TO VIEW PROPERTY WEBSITE](#)

While we have no reason to doubt the accuracy of any of the information supplied, we cannot, and do not, guarantee its accuracy. All information should be independently verified prior to a purchase or lease of the property. We are not responsible for errors, omissions, misuse, or misinterpretation of information contained herein and make no warranty of any kind, express or implied, with respect to the property or any other matters.