



Commerce Court 1230 'O' Street

Lincoln, NE

Property Features

- Full Service Gross Lease
- Connected to the Wells Fargo Center
- Amenities include: skywalk access, on-site security, free public Wi-Fi, & a secure and secluded courtyard,
- Located in the heart of downtown Lincoln
- Professionally managed
- Storage available

Available Space

Suite 121: 1,512 SF @ \$15.00/SF
Suite 120: 3,033 SF @ \$15.00/SF
Suite 130: 1,049 SF @ \$15.00/SF
Lower Level: 4,092 SF @ \$8.00/SF
Lower Level: 1,979 SF @ \$8.00/SF

For more information:

Richard Meginnis, SIOR

402 441 5828 • meginnis@naifma.com

Tom Graf, CCIM

402 441 5823 • tgraf@naifma.com

NO WARRANTY OR REPRESENTATION, EXPRESS OR IMPLIED, IS MADE AS TO THE ACCURACY OF THE INFORMATION CONTAINED HEREIN, AND THE SAME IS SUBMITTED SUBJECT TO ERRORS, OMISSIONS, CHANGE OF PRICE, RENTAL OR OTHER CONDITIONS, PRIOR SALE, LEASE OR FINANCING, OR WITHDRAWAL WITHOUT NOTICE, AND OF ANY SPECIAL LISTING CONDITIONS IMPOSED BY OUR PRINCIPALS NO WARRANTIES OR REPRESENTATIONS ARE MADE AS TO THE CONDITION OF THE PROPERTY OR ANY HAZARDS CONTAINED THEREIN ARE ANY TO BE IMPLIED.

Wells Fargo Center
1248 'O' Street, Ste. 550
Lincoln, NE 68508
402 441 5800

naifmarealty.com

For Lease
Commerce Court

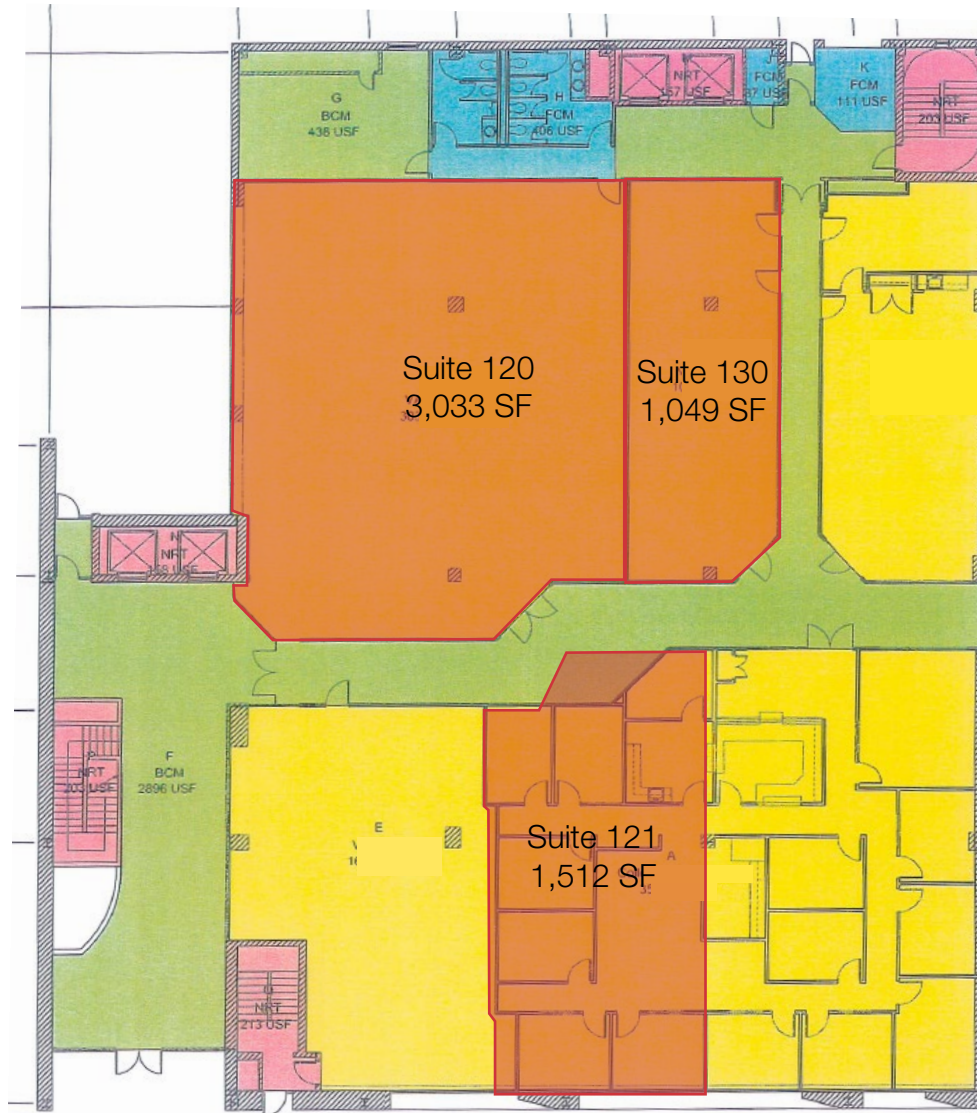

Wells Fargo Center
1248 'O' Street, Ste. 550
Lincoln, NE 68508
402 441 5800
naifmarealty.com

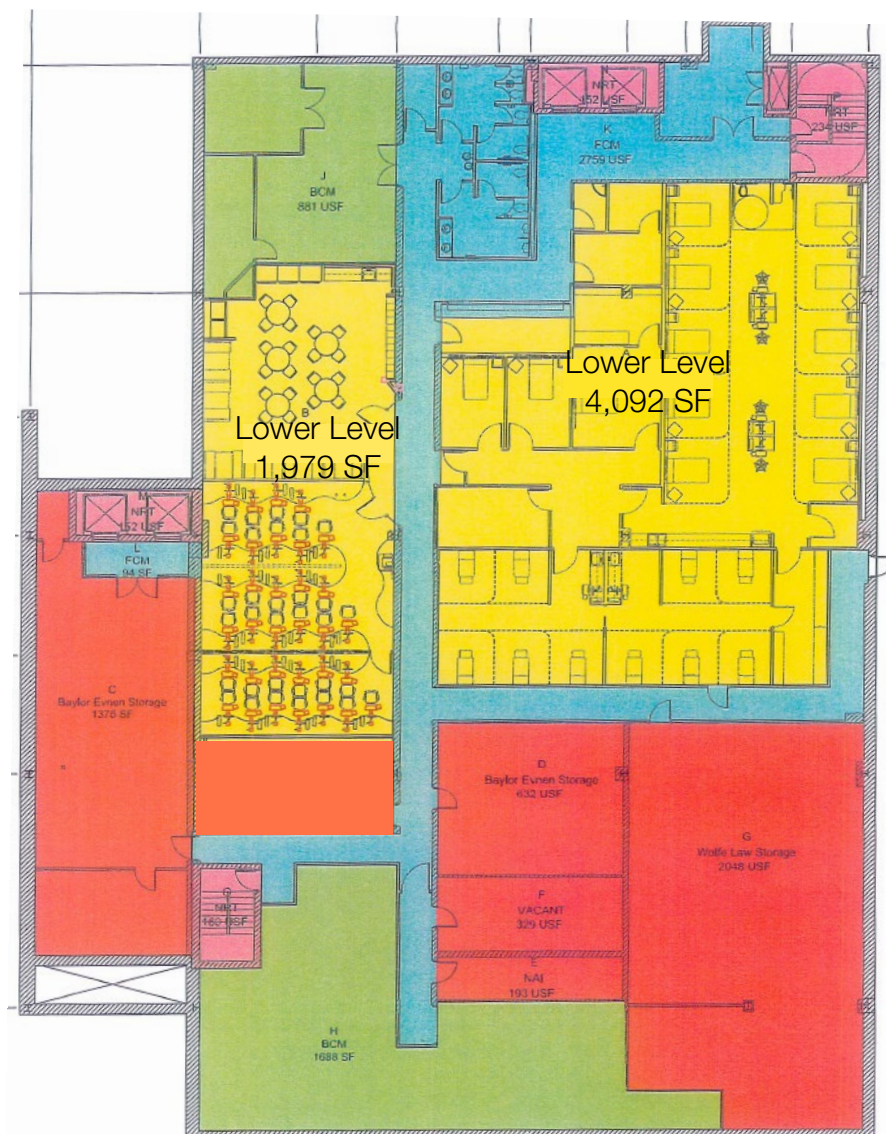

Wells Fargo Center
1248 'O' Street, Ste. 550
Lincoln, NE 68508
402 441 5800
naifmarealty.com