

FOR SALE

4,611 SF Building

48 Wyman Street, Stoughton, MA



Stephanie Deering | m. 781.608.5964 | sdeering@abgrealty.com

Anthony Odoardi | m. 508.843.2422 | aodoardi@abgrealty.com

307 Cambridge Street, Cambridge, MA | 617.492.9900 | www.abgrealty.com

PROPERTY DESCRIPTION

48 Wyman Street is a 4,611 sq. ft. commercial building located in Stoughton Center directly adjacent to the Stoughton Station Commuter Rail. Under new ownership as of 2016, the former Napa Auto Parts store has undergone substantial renovations and updates and has an \$85,000 grant available for facade improvements – making this build-out ready for any incoming business / owner occupier. Offering 18-foot ceilings with the opportunity to construct a 1,500 SF mezzanine by right, and with a liquor license available, the property would be perfect for a Brewery. Zoned CBD (Central Business District), and providing excellent street visibility and ample parking, the property would also be an ideal fit for a Physical Therapist, Chiropractor or Small Retail Shop.

HIGHLIGHTS



Building Size: 4,611 SF
Lot Size: 4,850 SF +/-



CBD Zoned

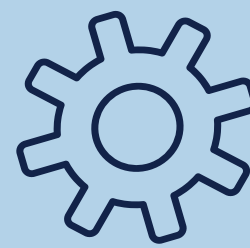

Gas Heat
New Overhead Door

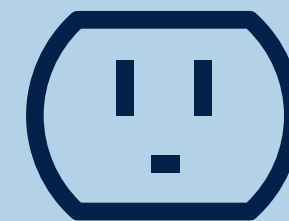

*Electrical 400
AMP Service*



Stephanie Deering | m. 781.608.5964 | sdeering@abgrealty.com

Anthony Odoardi | m. 508.843.2422 | aodoardi@abgrealty.com

307 Cambridge Street, Cambridge, MA | 617.492.9900 | www.abgrealty.com

FLOOR PLAN

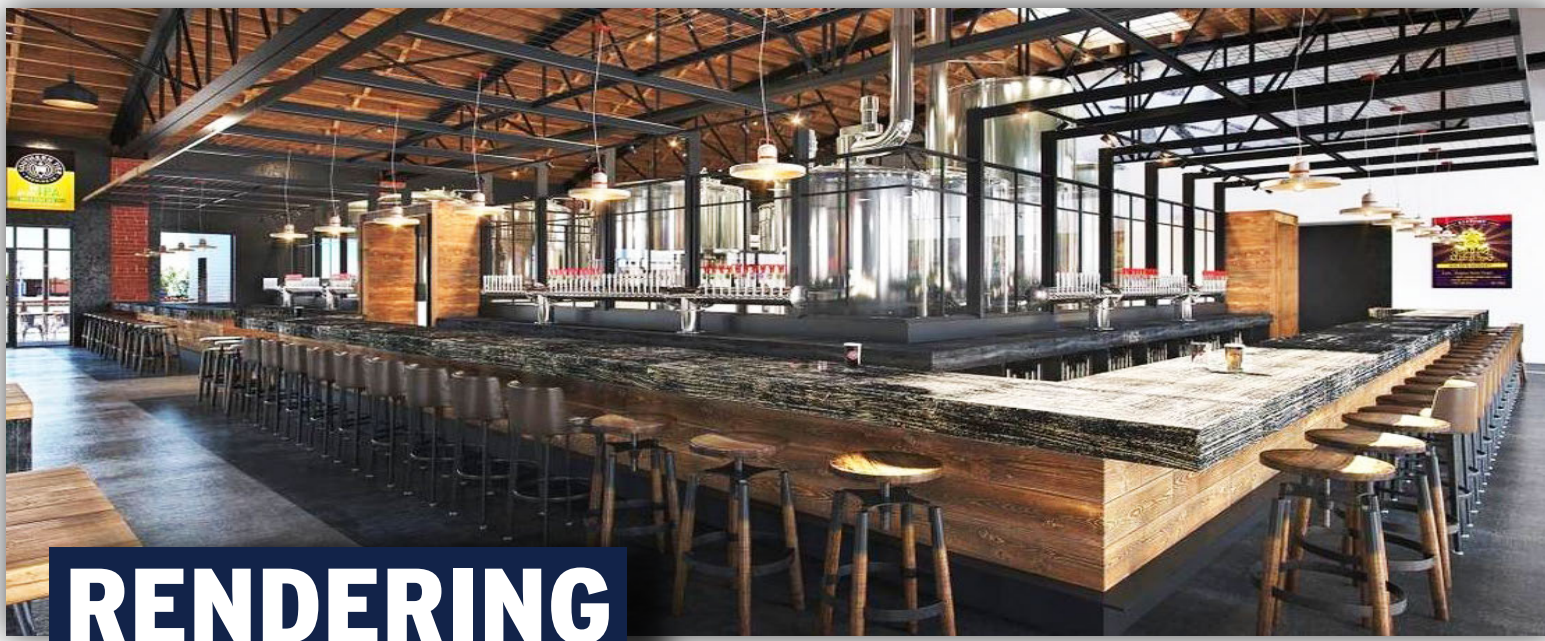
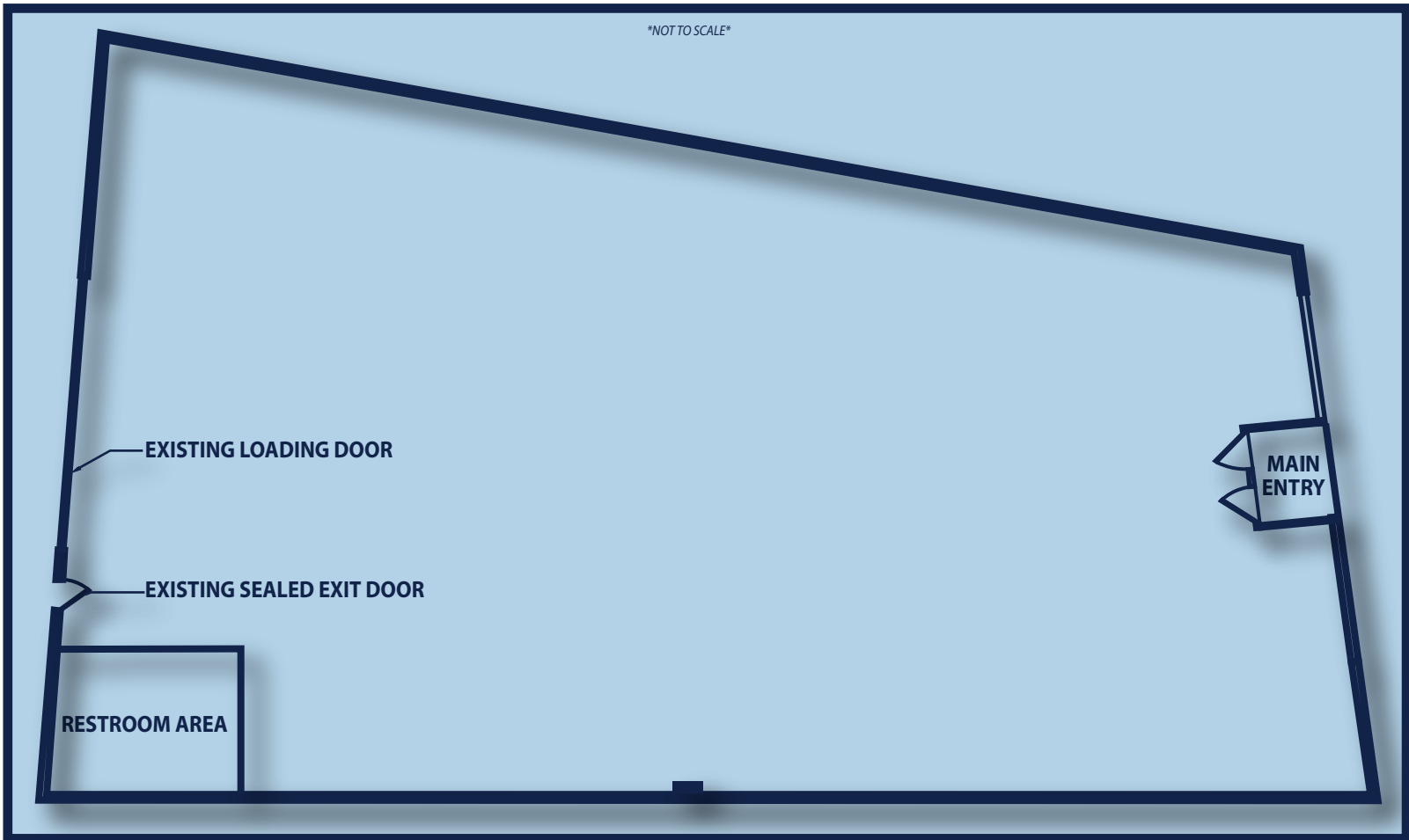

RENDERING

AREA MAP



Stephanie Deering | m. 781.608.5964 | sdeering@abgrealty.com
Anthony Odoardi | m. 508.843.2422 | aodoardi@abgrealty.com

307 Cambridge Street, Cambridge, MA | 617.492.9900 | www.abgrealty.com

All rights reserved. The information contained here has been obtained through sources deemed reliable but cannot be guaranteed as to its accuracy. Any information of special interest should be obtained through independent verification.