

FULLY LEASED

FOUNDRY
COMMERCIAL



1264 WEST WILLIAMS STREET
APEX, NORTH CAROLINA

FULLY LEASED

1264 WEST WILLIAMS STREET

FULLY LEASED



PROPERTY FEATURES

- Opportunity in highly-trafficked retail corridor — one of the last in this popular area
- Agreement in place for cross access to full movement traffic light
- Located across from Beaver Creek Commons and Beaver Creek Crossing
- Town of Apex shows promising growth with its proximity to RTP and downtown Raleigh business hubs
- Join Starbucks, Domino's, Tropical Smoothie Cafe, First Watch, Mezeh, and Mattress Warehouse

SITE FEATURES

AVAILABLE SF	Fully Leased
--------------	--------------

DEMOGRAPHICS

	1 MILE	3 MILES	5 MILES
2020 EST. POPULATION	12,957	75,997	148,437
2025 PROJ. POPULATION	14,175	82,868	161,743
EST. HOUSEHOLD INCOME	\$123,600	\$135,074	\$144,244

TRAFFIC COUNTS

WEST WILLIAMS STREET	26,000 VPD
US 64	43,000 VPD

For more information, please contact:

JAMES MATTOX

Principal, Retail Services
(919) 576 2696
james.mattox@foundrycommercial.com

FOUNDRY
COMMERCIAL

2301 Sugar Bush Road, Suite 220
Raleigh, NC 27612

foundrycommercial.com

Although the information contained herein was provided by sources believed to be reliable, Foundry Commercial makes no representation, expressed or implied, as to its accuracy and said information is subject to errors, omissions or changes.

1264 WEST WILLIAMS STREET

FULLY LEASED

CONCEPT PLAN

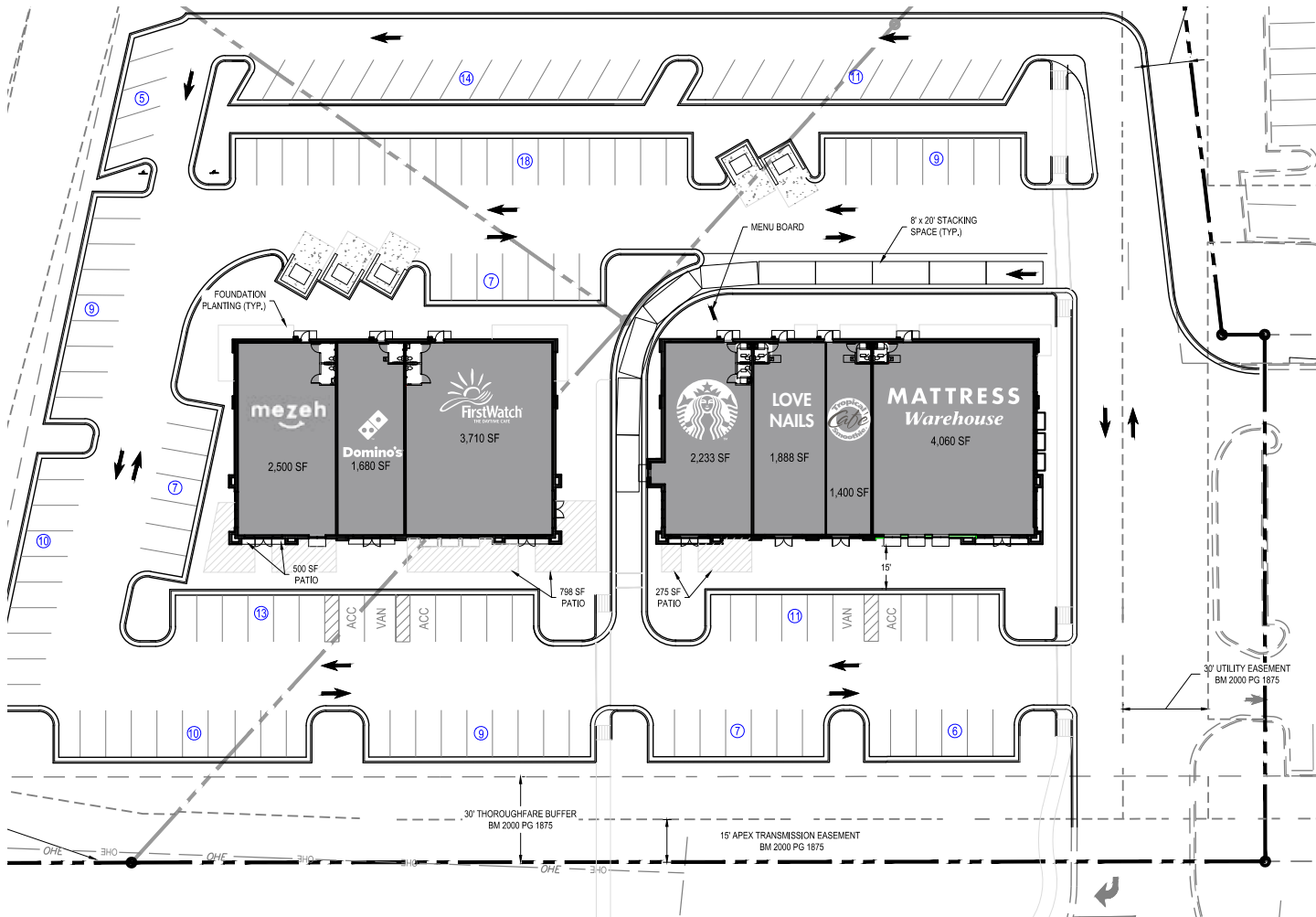

TENANT	SIZE
Mezeh	2,500 SF
Domino's	1,680 SF
First Watch	3,710 SF

TENANT	SIZE
Starbucks	2,233 SF
Love Nails	1,888 SF
Tropical Smoothie Cafe	1,400 SF
Mattress Warehouse	4,060 SF

For more information, please contact:

JAMES MATTOX
Principal, Retail Services
(919) 576 2696
james.mattox@foundrycommercial.com

FOUNDRY
COMMERCIAL

2301 Sugar Bush Road, Suite 220
Raleigh, NC 27612

foundrycommercial.com

Although the information contained herein was provided by sources believed to be reliable, Foundry Commercial makes no representation, expressed or implied, as to its accuracy and said information is subject to errors, omissions or changes.

1264 WEST WILLIAMS STREET

FULLY LEASED

ELEVATIONS



Front (South) Elevation

Side (West) Elevation



Rear (North) Elevation

Side (East) Elevation



Front (South) Elevation

Side (West) Elevation



Rear (North) Elevation

Side (East) Elevation

For more information, please contact:

JAMES MATTOX
Principal, Retail Services
(919) 576 2696
james.mattox@foundrycommercial.com

Although the information contained herein was provided by sources believed to be reliable, Foundry Commercial makes no representation, expressed or implied, as to its accuracy and said information is subject to errors, omissions or changes.

FOUNDRY
COMMERCIAL

2301 Sugar Bush Road, Suite 220
Raleigh, NC 27612

foundrycommercial.com