

FOR LEASE | OFFICE SPACE

# LAS CANTERAS BUSINESS PARK

10410 MEDICAL LOOP, LAREDO, TX 78045

**FORUM**   
COMMERCIAL REAL ESTATE



## PROPERTY SPECIFICATIONS

Total Building Size:	6,000 SF
Available SF:	5,111 SF
Suite 1A:	4,152 SF
Suite 1C:	959 SF
Space Use:	Office Building
Zoning:	B-3

## PROPERTY OVERVIEW

Two suites available for lease totaling 5,111 SF of office space inside a 6,000 SF building perfect for medical, attorney or professional office use. Located in a high traffic area near retail shops, banks, restaurants, hospital, schools and residential areas.

## LOCATION OVERVIEW

Located in north Laredo, Texas inside Las Canteras Business Park with immediate access to McPherson Rd. and Monarch Dr.

## DEMOGRAPHICS

	1 MILE	3 MILES	5 MILES
Total Households	1,158	12,358	26,140
Total Population	3,828	42,497	90,344
Average HH Income	\$77,137	\$80,185	\$70,562

**CARLO MOLANO, SIOR**  
carlom@forumcre.com  
M: 956.523.9403  
O: 956.717.9090

**BRIAN MANNING**  
brianm@forumcre.com  
M: 956.744.2085  
O: 956.717.9090

FOR LEASE | OFFICE SPACE

# LAS CANTERAS BUSINESS PARK

10410 MEDICAL LOOP, LAREDO, TX 78045

**FORUM**  
COMMERCIAL REAL ESTATE

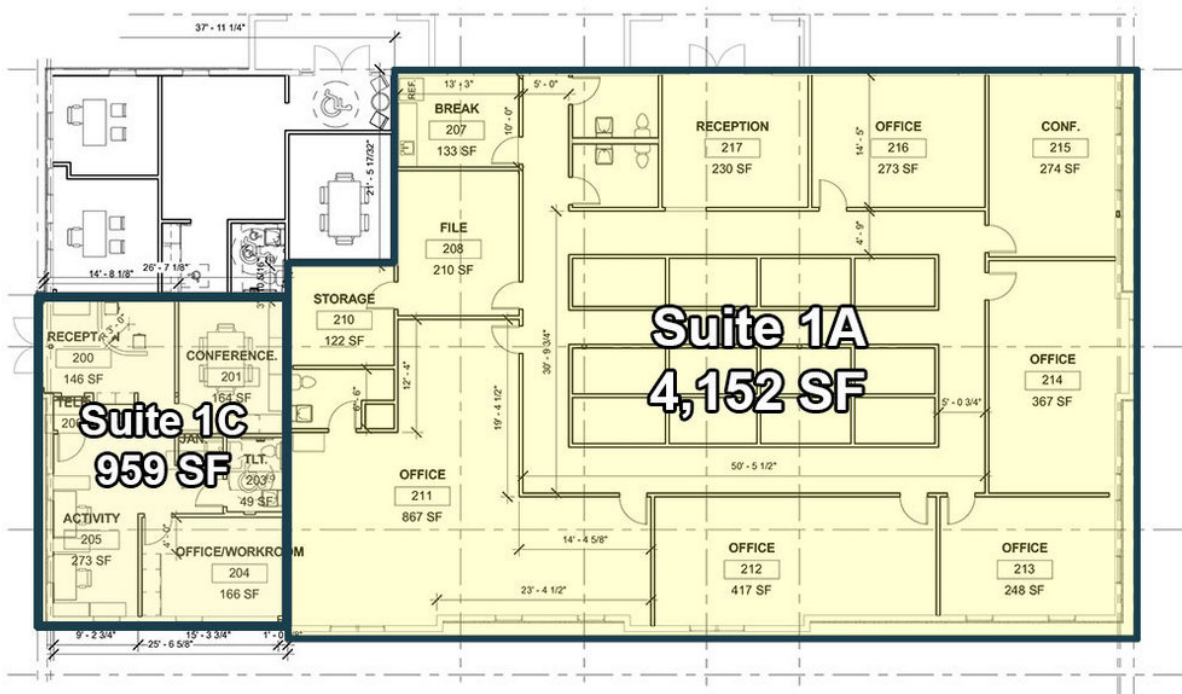

**CARLO MOLANO, SIOR**  
carlom@forumcre.com  
M: 956.523.9403  
O: 956.717.9090

**BRIAN MANNING**  
brianm@forumcre.com  
M: 956.744.2085  
O: 956.717.9090

