

SHOPS AT SURFSIDE

2390 SURFSIDE BLVD

CAPE CORAL, FLORIDA



2,760 SF



RETAIL FOR LEASE



CALL FOR RATES

PROPERTY INFORMATION

2,760 SF space adjacent to Starbucks available.

Join Belk, Dollar Tree, Starbucks and more

Great visibility

Located on Veterans Parkway adjacent to Sandoval community with over 1,500 units

Positioned amongst the highest average HH incomes and home values in Cape Coral

Veterans Pkwy Traffic Counts: 26,000 AADT

LQWEST.COM/SHOPS-AT-SURFSIDE

DEMOGRAPHICS

	<u>1-MILE</u>	<u>3-MILES</u>	<u>5-MILES</u>
Total Population	9,745	45,624	121,112
Avg Household Income	\$79,001	\$73,859	\$71,011
Total Households	3,444	17,086	48,448
Daytime Employees	808	6,294	20,687

(Applied Geographic Solutions 2019)

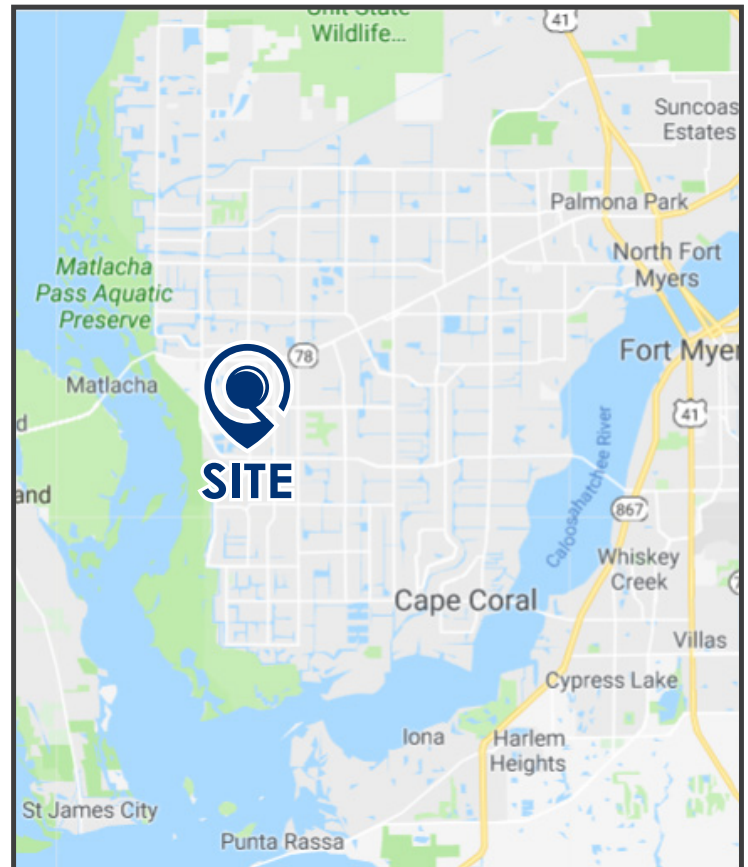

TOM STRAUSS, PRINCIPAL

D: 239.333.4370 @ M: 239.822.9978

tstrauss@lqwest.com @ [MY LISTINGS](#)

JESSICA MCEVOY, ASSOCIATE

D: 239.333.4374

jmcevoy@lqwest.com @ [MY LISTINGS](#)



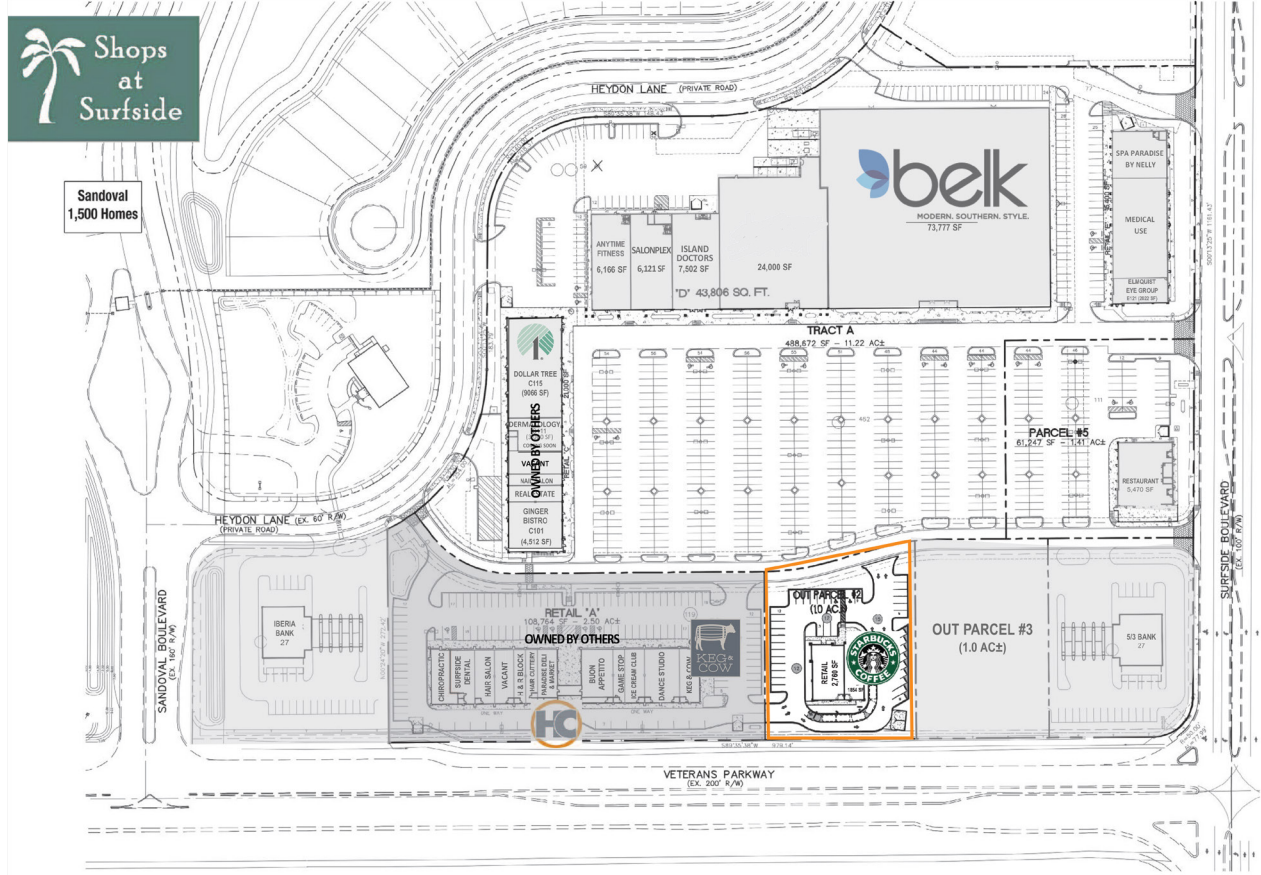

1614 Colonial Boulevard, Suite 101, Fort Myers, FL 33907
 MAIN: 239.275.4922 @ FAX: 239.275.4699 @ LQWEST.COM

Information obtained from owner(s) or other sources deemed reliable. We have no reason to doubt its accuracy, but cannot guarantee it. All properties subject to change or withdrawal without notice.