



Take a Virtual Tour!

100 Cambridge Street Boston, Massachusetts

Sublease Available

Space Profile

Premises	7,733 SF
Floor	13
Availability	Immediate
Term	Through July 2023
Rental Rate	Negotiable
Built	1965, renovated 2018
Submarket	Financial District/Government Center
Parking	3 spaces

Map

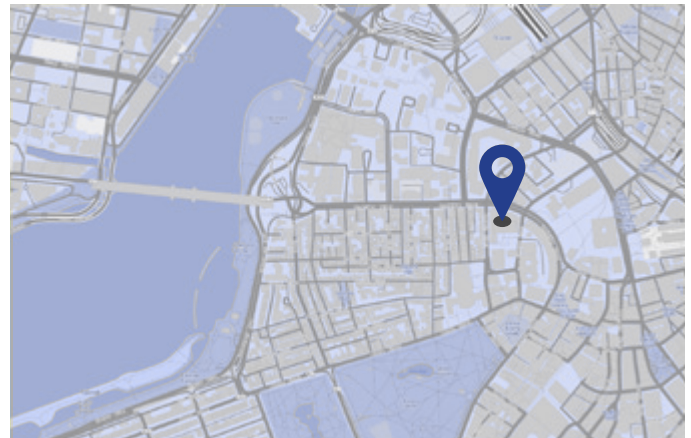

Features

- Open plan with exposed ceilings
- Furniture available
- Expansive Charles River and Cambridge views
- Close proximity to MBTA Government Center, Bowdoin and Charles/MGH stations

For More Information

Cresa
280 Congress Street
Floor 10
Boston, MA 02210
cresa.com



Matt Harvey
617.758.6003
mharvey@cresa.com



Derek Losi
617.758.6021
dlosi@cresa.com



Andrew Orpik
617.758.6077
aorpik@cresa.com

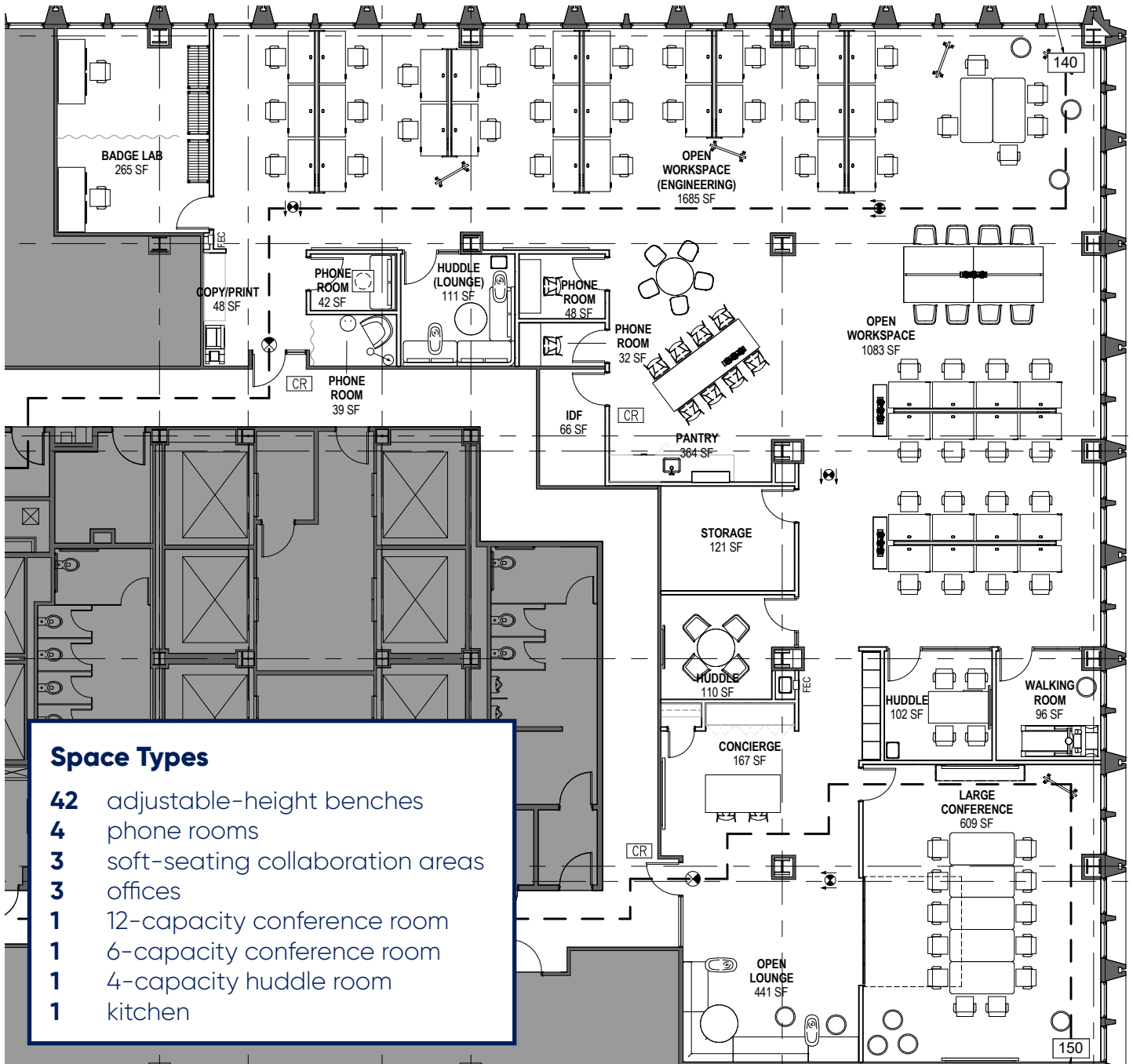

For More Information

Cresa
280 Congress Street, Floor 10
Boston, MA 02210
cresa.com



Matt Harvey
617.758.6003
mharvey@cresa.com



Derek Losi
617.758.6021
dlosi@cresa.com



Andrew Orpik
617.758.6077
aorpik@cresa.com



100 Cambridge Street Boston, Massachusetts

13th Floor - 7,733 SF

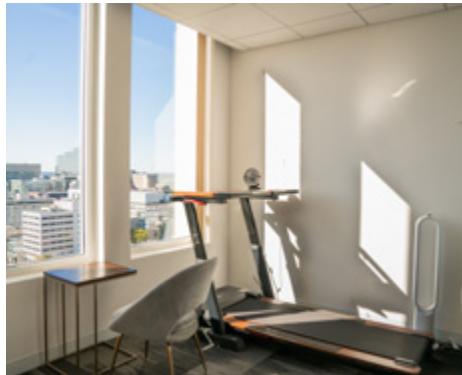

For More Information

Cresa
280 Congress Street, Floor 10
Boston, MA 02210
cresa.com



Matt Harvey
617.758.6003
mharvey@cresa.com



Derek Losi
617.758.6021
dlosi@cresa.com



Andrew Orpik
617.758.6077
aorpik@cresa.com