

FOR LEASE

GALLERIA OFFICENTRE - 300 GALLERIA



300 GALLERIA SOUTHFIELD, MI 48034

PROPERTY HIGHLIGHTS:

- Individual suites from 1,000 SF up to 28,804 SF contiguous
- Prominent building signage available along Northwestern Hwy and 12 Mile Rd
- Generators on-site for tenant use
- Award winning upgrades have been completed to the interior and exterior of the building
- Completed and planned upgrades include: building conference facilities, fitness center and locker rooms, full-service cafes, dry cleaning services, and sundry shops throughout the complex
- Executive covered parking garage within building 100 and 300 and an overall 4.7/1000 parking ratio
- Ability for tenants to use amphitheater within Star Theaters located on property
- Located in the heart of Southfield Office Market with proximity to all area freeways: I-696, Northwestern Hwy, John C Lodge Fwy
- Centrally located to all south-eastern Michigan's major markets
- Plug and play space, all furniture available

The information provided herein along with any attachment(s) was obtained from sources believed to be reliable, however, Friedman Real Estate makes no guarantees, warranties, or representations as to the completeness or accuracy of such information and legal counsel is advised. All information provided is subject to verification and no liability for reliance on such information or errors or omissions is assumed. The presentation of this property is submitted subject to errors, omissions, change of price or conditions, prior sale or lease, or withdrawal without notice. Copyright © 2021 Friedman Real Estate. All rights reserved.

FOR MORE INFORMATION PLEASE CONTACT:



ROBERT GAGNIUK
robert.gagniuk@freg.com



JORDAN FRIEDMAN
jordan.friedman@freg.com

248.324.2000

eCODE 900



GALLERIA OFFICENTRE - 300 GALLERIA PROPERTY **AVAILABILITY**

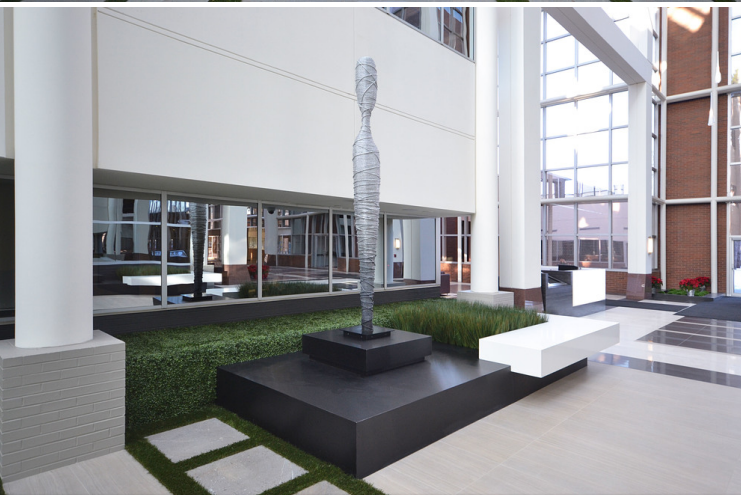

AVAILABLE SPACES

| SUITE | SF |
|----------------------|-----------|
| 101 | 7,119 SF |
| 102 | 3,813 SF |
| 108 | 915 SF |
| 110 | 2,582 SF |
| 111 | 4,383 SF |
| 112 | 4,032 SF |
| 115 | 2,201 SF |
| 101+111+115 Combined | 14,630 SF |
| 200 | 28,804 SF |
| 301 | 25,304 SF |
| 305 | 3,261 SF |
| 316 | 1,076 SF |
| 320 | 5,735 SF |
| 326 | 2,007 SF |
| 331 | 2,703 SF |
| 502 | 4,975 SF |

GALLERIA OFFICENTRE - 300 GALLERIA

PROPERTY PHOTOS

| 5 TH FLOOR | |
|---|-------------|
| AVAILABLE | ±7,181 RSF |
| CONTIGUOUS | ±7,181 RSF |
| 4 TH FLOOR | |
| AVAILABLE | ±0 RSF |
| CONTIGUOUS | ±0 RSF |
| 3 RD FLOOR | |
| AVAILABLE | ±31,228 RSF |
| CONTIGUOUS | ±29,635 RSF |
| 2 ND FLOOR | |
| AVAILABLE | ±28,804 RSF |
| CONTIGUOUS | ±28,804 RSF |
| 1 ST FLOOR | |
| AVAILABLE | ±26,689 RSF |
| CONTIGUOUS | ±14,630 RSF |
| ENTIRE BUILDING | |
| LARGEST CONTIGUOUS (All on West Side of Building) | ±73,069 RSF |
| AVAILABLE | ±93,902 RSF |

