



27100 W ELEVEN MILE ROAD
SOUTHFIELD, MI 48034

PROPERTY HIGHLIGHTS:

- Suites ranging from $\pm 4,000$ SF up to $\pm 16,000$ SF (full floor)
- Four contiguous full floors available for up to 51,520 RSF (floors 1-4)
- Entire floorplates up to $\pm 16,000$ SF
- Prominent building signage available visible from I-696
- Major interior and exterior renovations planned for 2020
- Full-service cafe and catering by FreshMart
- Numerous conference and training room facilities in common area
- Community Choice Credit Union bank branch located in main lobby
- Abundant service parking with easy access to all building entrances
- Abundant covered parking available in two attached parking structures
- Located in the heart of Southfield Office Market with proximity to all area freeways: I-696, Northwestern Hwy, John C Lodge Fwy

The information provided herein along with any attachment(s) was obtained from sources believed to be reliable, however, Friedman Real Estate makes no guarantees, warranties, or representations as to the completeness or accuracy of such information and legal counsel is advised. All information provided is subject to verification and no liability for reliance on such information or errors or omissions is assumed. The presentation of this property is submitted subject to errors, omissions, change of price or conditions, prior sale or lease, or withdrawal without notice. Copyright © 2021 Friedman Real Estate. All rights reserved.

FOR MORE INFORMATION PLEASE CONTACT:



ROBERT GAGNIUK
robert.gagniuik@freg.com



JORDAN FRIEDMAN
jordan.friedman@freg.com



DAVID FRIEDMAN
david.friedman@freg.com

248.324.2000

eCODE 221

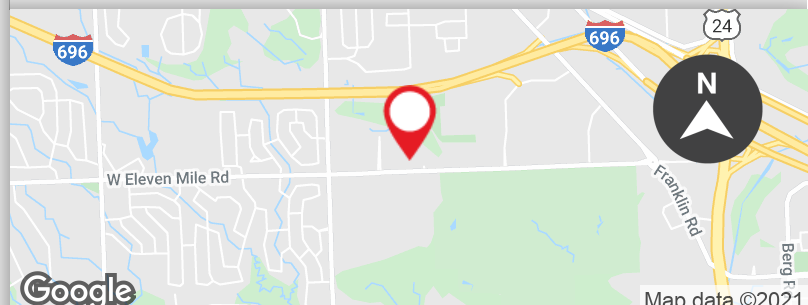

ONE WEST 11 LOCATION OVERVIEW

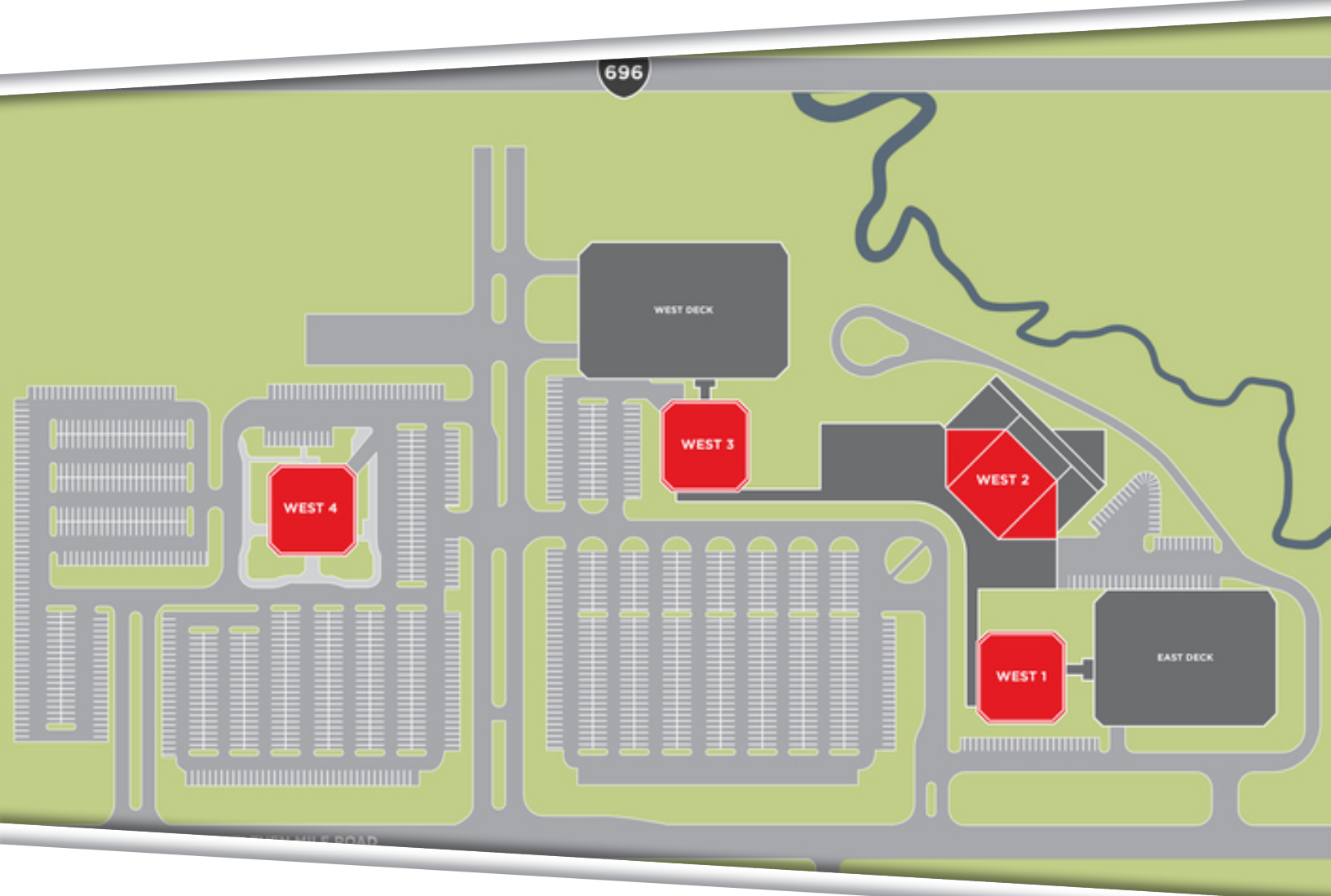

TRAFFIC COUNTS	
INTERSECTION	CARS PER DAY
W 11 Mile Rd & Summerdale Dr E	6,295
Inkster Rd & W 11 Mile Road	9,282
W 11 Mile Rd & American Dr E	17,990
I-696 Franklin Rd NE	151,779

DEMOGRAPHICS			
	1 MILE	3 MILES	5 MILES
Total Population	6,715	60,574	194,158
Total Households	3,437	27,086	80,779
Average HH Income	\$58,807	\$74,769	\$80,739

ONE WEST 11 STACKING PLAN

Property Details	
Address	27100 W 11 Mile Rd
Number of Floors	7
Building Size:	±110,804 SF
Year Built:	1984
Loading Docks:	0
Available SF	
7 TH Floor	0 SF
6 TH Floor	0 SF
5 TH Floor	0 SF
4 TH Floor	±15,832 SF
3 RD Floor	±15,832 SF
2 ND Floor	±15,832 SF
1 ST Floor	±4,024 SF
Contiguous	±51,520 RSF

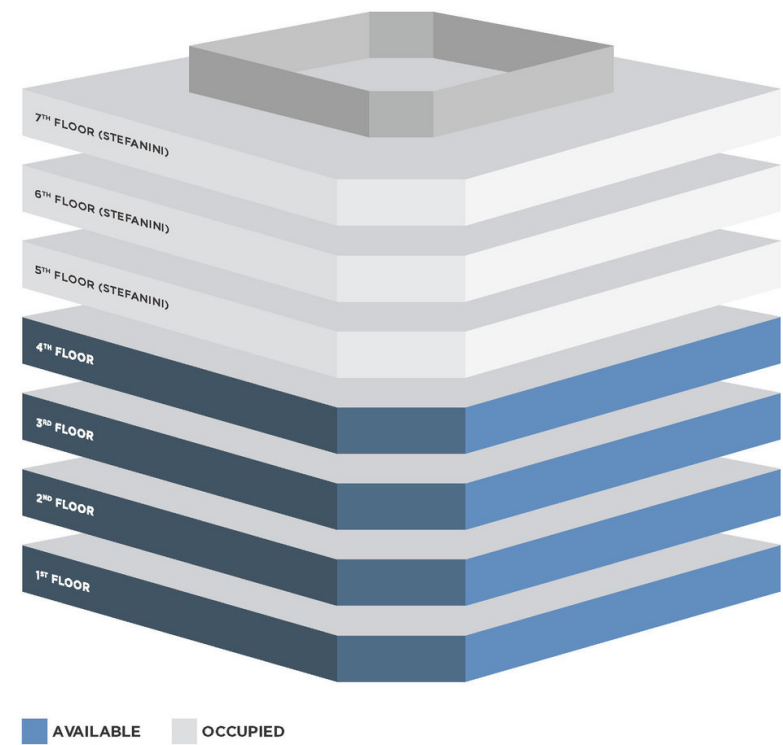

FOR MORE INFORMATION PLEASE CONTACT:



ROBERT GAGNIUK
robert.gagniuk@freg.com



JORDAN FRIEDMAN
jordan.friedman@freg.com



DAVID FRIEDMAN
david.friedman@freg.com