

23684 & 23688 RESEARCH DR.
FARMINGTON HILLS, MICHIGAN

INVESTMENT SALE - INDUSTRIAL
18,200 Square Feet



**SIGNATURE
ASSOCIATES**
KNOW SIGNATURE | KNOW RESULTS

2-BUILDING PORTFOLIO SALE



**23684 Research Dr.
10,000 Square Feet**



**23688 Research Dr.
8,200 Square Feet**

PROPERTY FEATURES

- 2-Building portfolio sale totaling 18,200 sq. ft.
 - 23684 Research Dr: 10,000 sq. ft.
Leased to Arc Document Solutions
 - 23688 Research Dr: 8,200 sq. ft.
Leased to Home Depot (vacating 5/1/21)
- Unique opportunity for user to purchase with additional income in place
- Both buildings built in 1984
- Zoned Light Industrial
- Sale Price: \$1,350,000 (\$74.18/sqft)

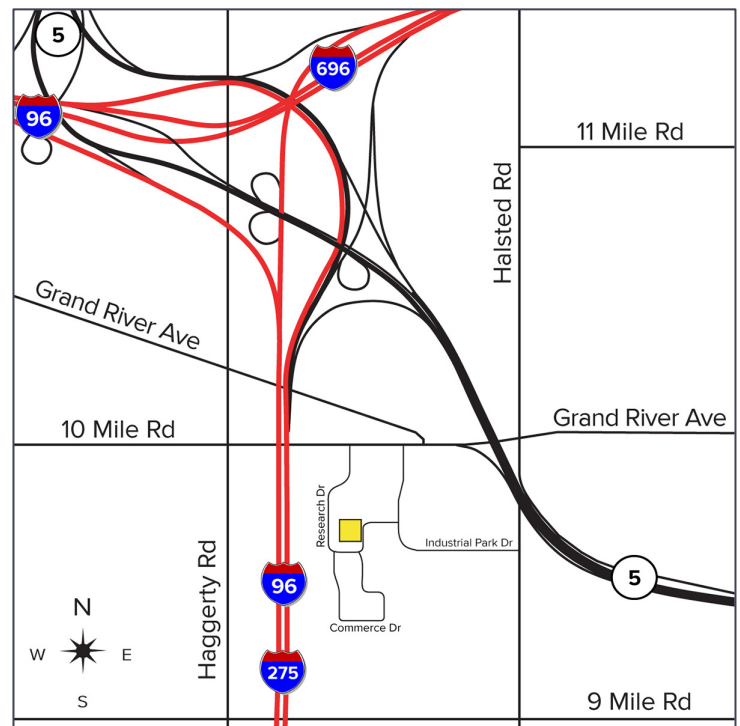

For more information, please contact:

JEFF LEMANSKI

(248) 359 0641

jlemanski@signatureassociates.com

SIGNATURE ASSOCIATES

One Towne Square, Suite 1200

Southfield, MI 48076

www.signatureassociates.com

23684 & 23688 Research Dr – Farmington Hills, Michigan

Industrial For Investment Sale

18,200
Square Feet

Site Plan

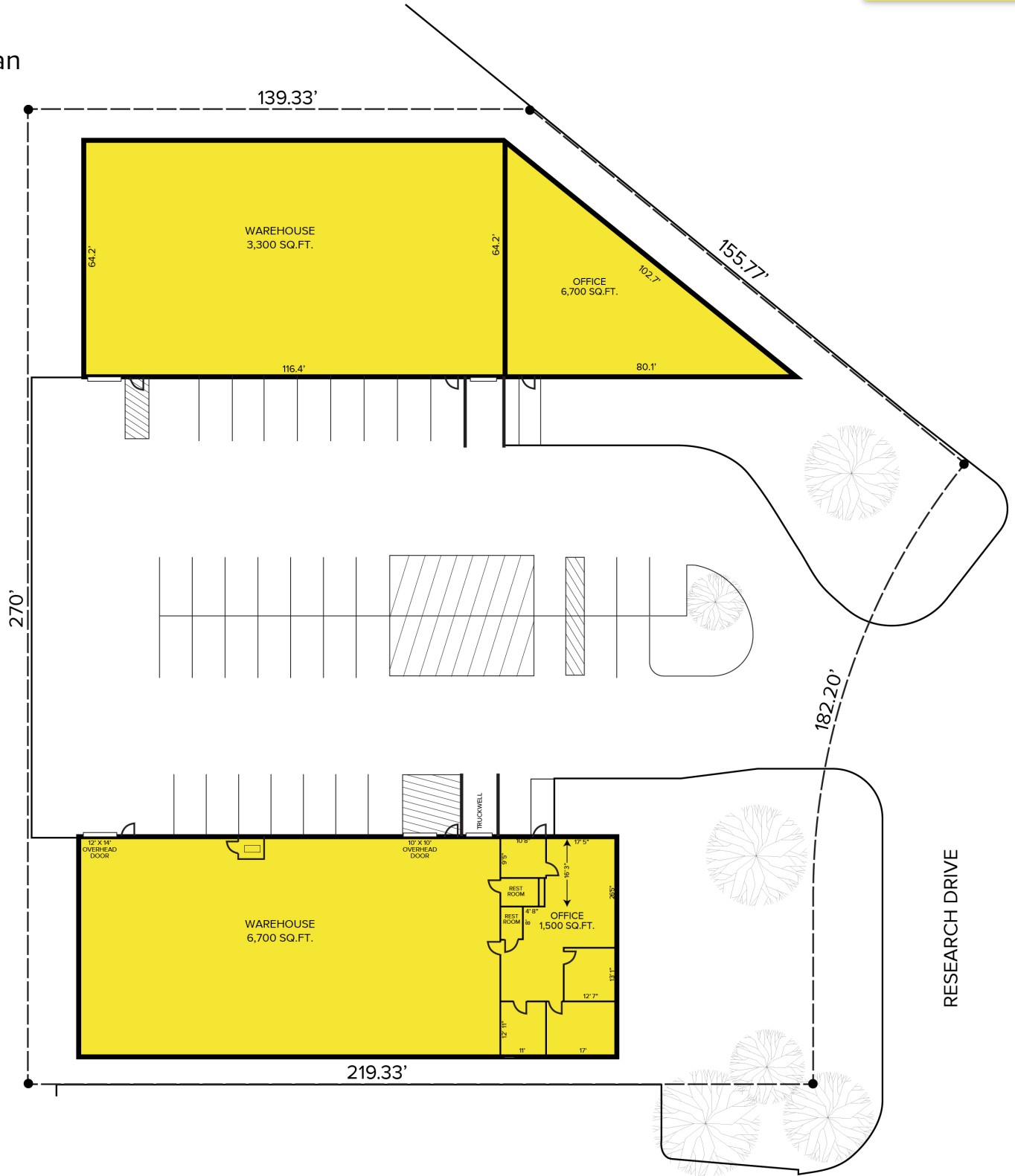

For more information, please contact:

JEFF LEMANSKI
(248) 359 0641
jlemanski@signatureassociates.com

SIGNATURE ASSOCIATES
One Towne Square, Suite 1200
Southfield, MI 48076
www.signatureassociates.com

23684 & 23688 Research Dr – Farmington Hills, Michigan

Industrial For Investment Sale

18,200
Square Feet

Floor Plan – 23684 Research

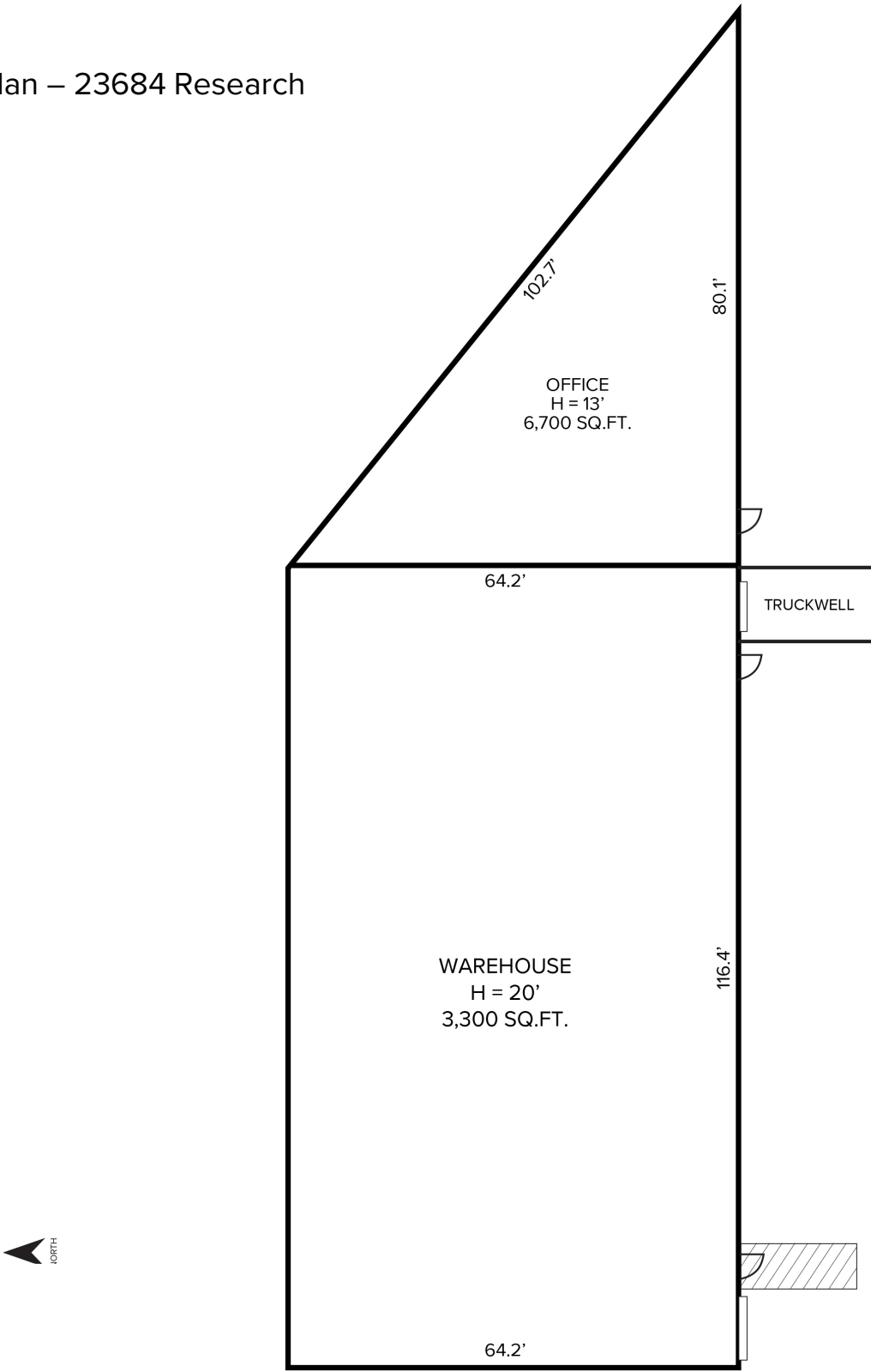

For more information, please contact:

JEFF LEMANSKI
(248) 359 0641
jlemanski@signatureassociates.com

SIGNATURE ASSOCIATES
One Towne Square, Suite 1200
Southfield, MI 48076
www.signatureassociates.com

Information is subject to verification and no liability for errors or omissions is assumed. Price is subject to change and listing withdrawal.

23684 & 23688 Research Dr – Farmington Hills, Michigan

Industrial For Investment Sale

18,200
Square Feet

Floor Plan – 23688 Research

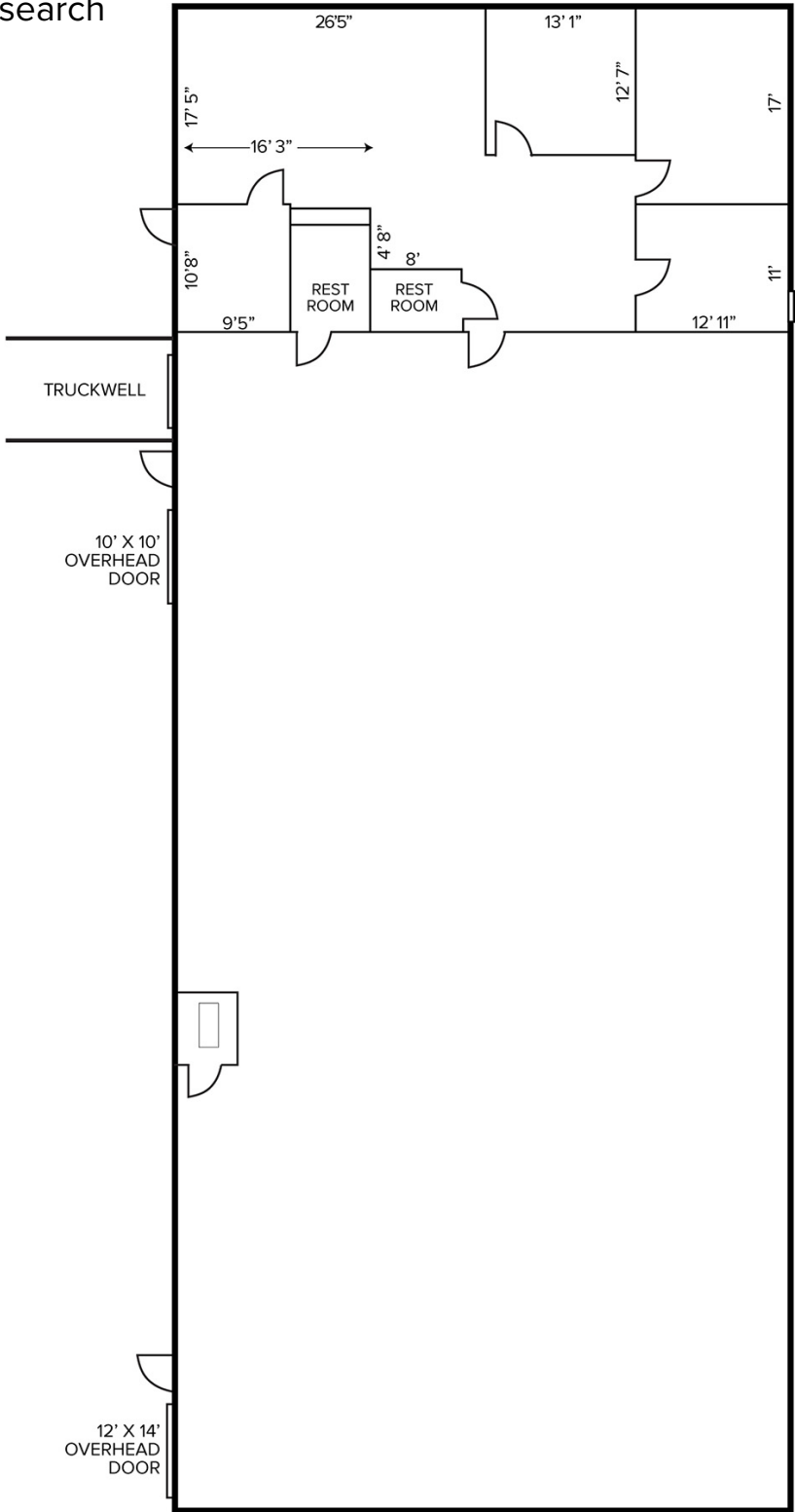

For more information, please contact:

JEFF LEMANSKI
(248) 359 0641
jlemanski@signatureassociates.com

SIGNATURE ASSOCIATES
One Towne Square, Suite 1200
Southfield, MI 48076
www.signatureassociates.com

Information is subject to verification and no liability for errors or omissions is assumed. Price is subject to change and listing withdrawal.

23684 & 23688 Research Dr – Farmington Hills, Michigan

Industrial For Investment Sale

18,200
Square Feet

Aerial



For more information, please contact:

JEFF LEMANSKI
(248) 359 0641
jlemanski@signatureassociates.com

SIGNATURE ASSOCIATES
One Towne Square, Suite 1200
Southfield, MI 48076
www.signatureassociates.com

Information is subject to verification and no liability for errors or omissions is assumed. Price is subject to change and listing withdrawal.