



◆ WESTECH ◆

WESTECH BUSINESS CENTER II

4710 EAST ELWOOD STREET
PHOENIX, ARIZONA

PROJECT OFFERS FREEWAY
SIGNAGE AND EXPOSURE

Ready for immediate occupancy for Flex/
Back office/Call center use.



Suites #6-7: 14,857 SF

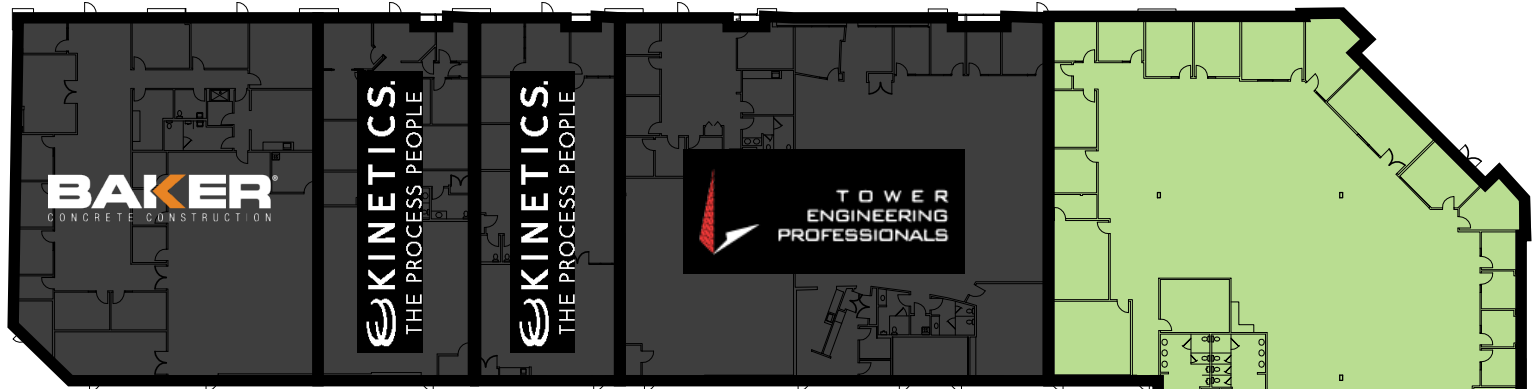

BUILDING ONE

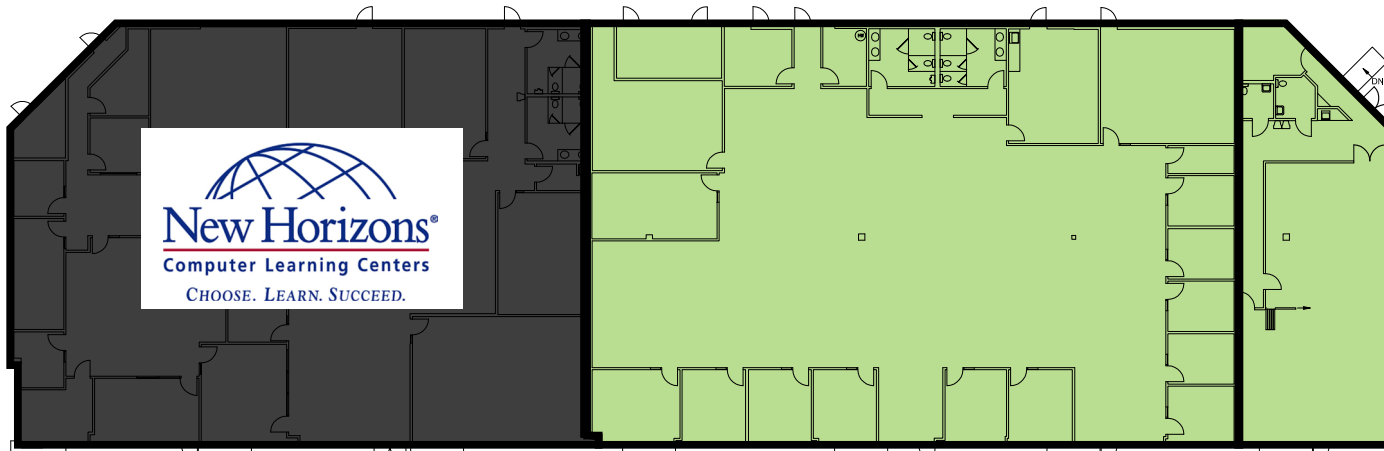

LEASED

Suites #16-18:
9,668 SF

Suite #15:
2,244 SF

BUILDING TWO

MILESTONE

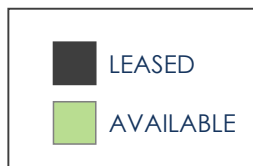

WESTECH BUSINESS CENTER II

4710 EAST ELWOOD STREET
PHOENIX, ARIZONA



JEFF CONRAD, SIOR
PRINCIPAL
602.954-3743
jconrad@learizona.com

ALLEN LOWE, SIOR
PRINCIPAL
602.954.3747
alowe@learizona.com



3200 East Camelback Road, Suite 100
Phoenix, Arizona 85018 | 602.956.7777
learizona.com



All information furnished regarding property for sale, rental or financing is from sources deemed reliable, but no warranty or representation is made to the accuracy thereof and same is submitted to errors, omissions, change of price, rental or other conditions prior to sale, lease or financing or withdrawal without notice. No liability of any kind is to be imposed on the broker herein.

