

2112 E. LONG LAKE ROAD  
TROY, MICHIGAN



**SIGNATURE  
ASSOCIATES**  
KNOW SIGNATURE | KNOW RESULTS

LAND FOR SALE  
6.35 Acres Available



## PROPERTY FEATURES

- 6.35 acres available
- Zoned R-1C, single-family
- Wooded lot, flat topography
- Excellent school system and close to retail and freeway
- Sanitary, storm, water, and gas located at street
- Asking price: \$1,500,000 (\$181,108.36/acre)

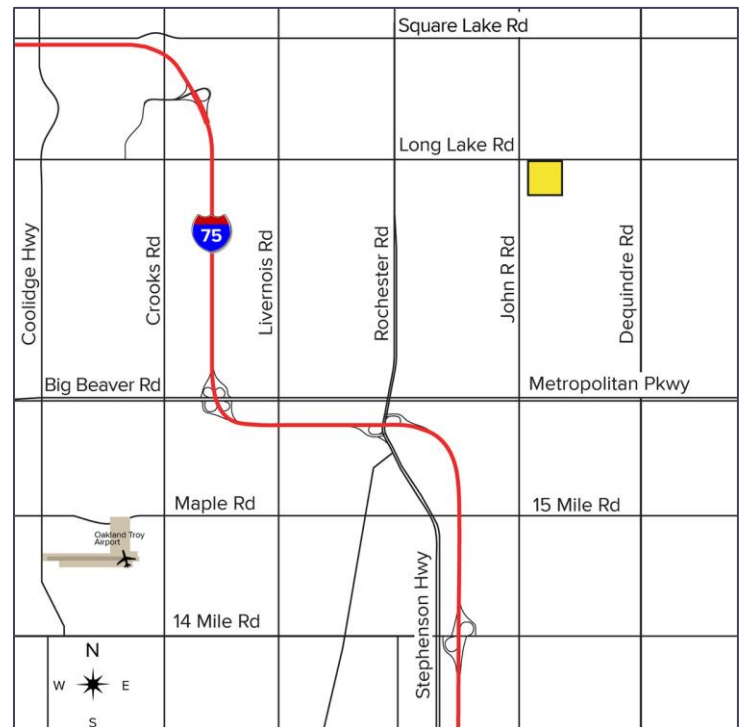

For more information, please contact:

**KRIS PAWLOWSKI**  
(248) 359 3801  
kpawlowski@signatureassociates.com

**SIGNATURE ASSOCIATES**  
One Towne Square, Suite 1200  
Southfield, MI 48076  
www.signatureassociates.com