

1874-1908 THUNDERBIRD DR.
UNIT #1890
TROY, MICHIGAN

INDUSTRIAL FOR LEASE
3,200 Square Feet Available



**SIGNATURE
ASSOCIATES**
KNOW SIGNATURE | KNOW RESULTS

TROY BUSINESS CENTER



PROPERTY FEATURES

- 3,200 square feet available
- 600 square foot of office space
- 57,600 square foot multi-tenant complex
- 16' clear height
- (2) 12x12, 10x12 grade level doors
- Complex professionally managed by Signature Associates
- Centrally located near I-75 between Maple Rd. and Big Beaver Rd.
- 200 amps, 240 volts power
- Available May 2021
- Lease Rate: \$8.17/sq.ft. Gross

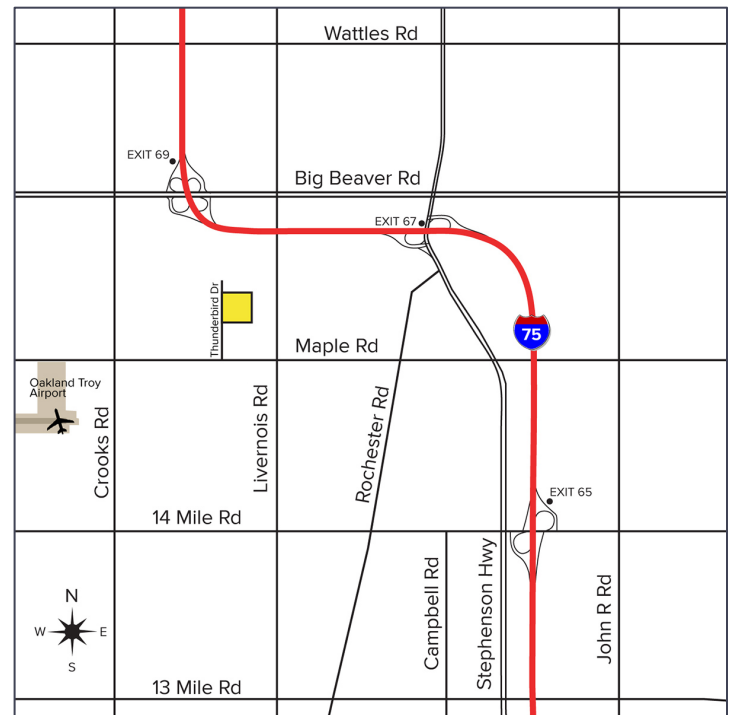

For more information, please contact:

KRIS PAWLOWSKI
(248) 359 3801
kpawlowski@signatureassociates.com

SIGNATURE ASSOCIATES
One Towne Square, Suite 1200
Southfield, MI 48076
www.signatureassociates.com

1874-1908 Thunderbird Drive - Troy, Michigan

Industrial For Lease

3,200
Square Feet
AVAILABLE

Site Plan

AVAILABILITY		
UNIT	TOTAL SF	RATE
1890	3,200	\$8.17 Gross

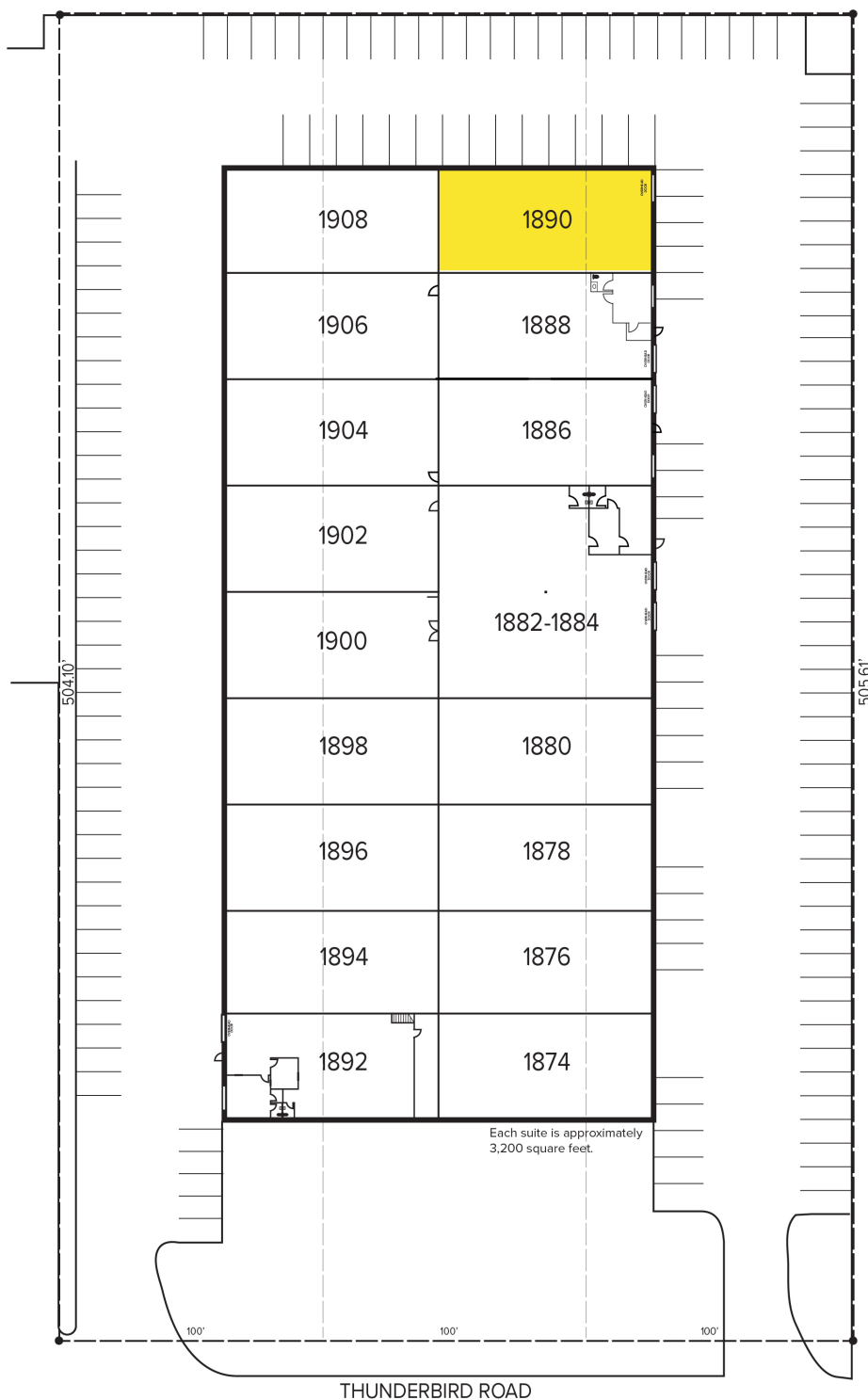

For more information, please contact:

KRIS PAWLOWSKI
(248) 359 3801
kpawlowski@signatureassociates.com

SIGNATURE ASSOCIATES
One Towne Square, Suite 1200
Southfield, MI 48076
www.signatureassociates.com

1874-1908 Thunderbird Drive - Troy, Michigan

Industrial For Lease

3,200
Square Feet
AVAILABLE

Aerial



For more information, please contact:

KRIS PAWLOWSKI
(248) 359 3801
kpawlowski@signatureassociates.com

SIGNATURE ASSOCIATES
One Towne Square, Suite 1200
Southfield, MI 48076
www.signatureassociates.com