

1200 W. HAMLIN ROAD  
ROCHESTER HILLS, MICHIGAN

INDUSTRIAL FOR SALE OR LEASE  
27,720 Square Feet Available



**SIGNATURE  
ASSOCIATES**  
KNOW SIGNATURE | KNOW RESULTS

**EXCELLENT MANUFACTURING BUILDING**



## PROPERTY FEATURES

- 27,720 square feet available (expandable)
- 5,820 square feet of office
- 24' clear height
- (2) 12x14 grade level doors
- (2) 10-Ton cranes
- Truckwells possible
- 75 +/- parking spaces
- 3,000 amps, 480 volts, 3-phase power
- New roof (2020)
- Painted shop and epoxy floor
- New HVAC units for the office
- Lease Rate: \$6.50/sq.ft. NNN
- Sale Price: \$2,050,000 (\$73.95/sq.ft.)

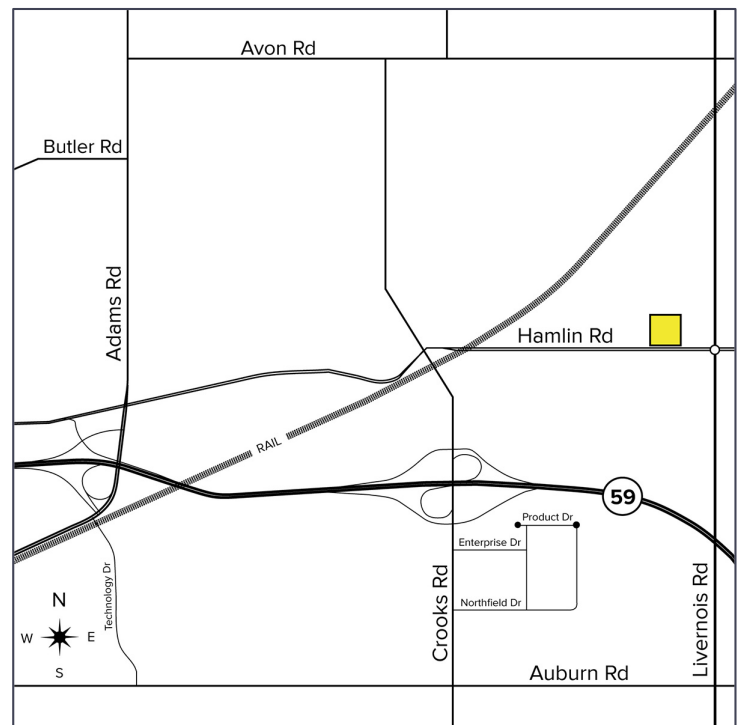

For more information, please contact:

**KRIS PAWLOWSKI**  
(248) 359 3801  
kpawlowski@signatureassociates.com

**SIGNATURE ASSOCIATES**  
One Towne Square, Suite 1200  
Southfield, MI 48076  
www.signatureassociates.com

# 1200 W. Hamlin Road – Rochester Hills, Michigan

Industrial For Sale or Lease

27,720  
Square Feet  
AVAILABLE

## Interior Photo



For more information, please contact:

**KRIS PAWLOWSKI**  
(248) 359 3801  
kpawlowski@signatureassociates.com

**SIGNATURE ASSOCIATES**  
One Towne Square, Suite 1200  
Southfield, MI 48076  
www.signatureassociates.com

# 1200 W. Hamlin Road – Rochester Hills, Michigan

Industrial For Sale or Lease

27,720  
Square Feet  
AVAILABLE

Site Plan

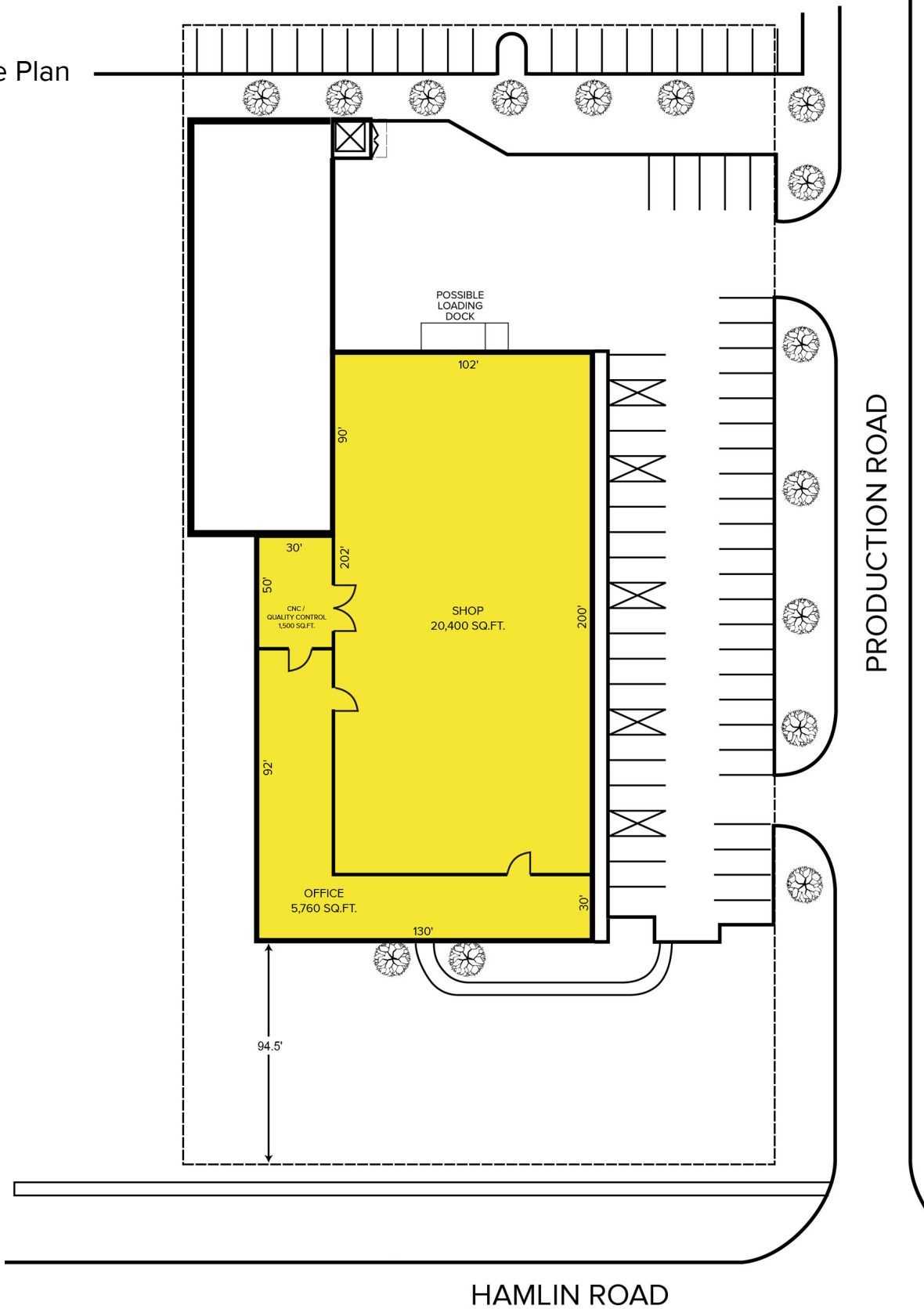

For more information, please contact:

**KRIS PAWLOWSKI**  
(248) 359 3801  
kpawlowski@signatureassociates.com

**SIGNATURE ASSOCIATES**  
One Towne Square, Suite 1200  
Southfield, MI 48076  
www.signatureassociates.com

# 1200 W. Hamlin Road – Rochester Hills, Michigan

Industrial For Sale or Lease

27,720  
Square Feet  
AVAILABLE

## Floor Plan

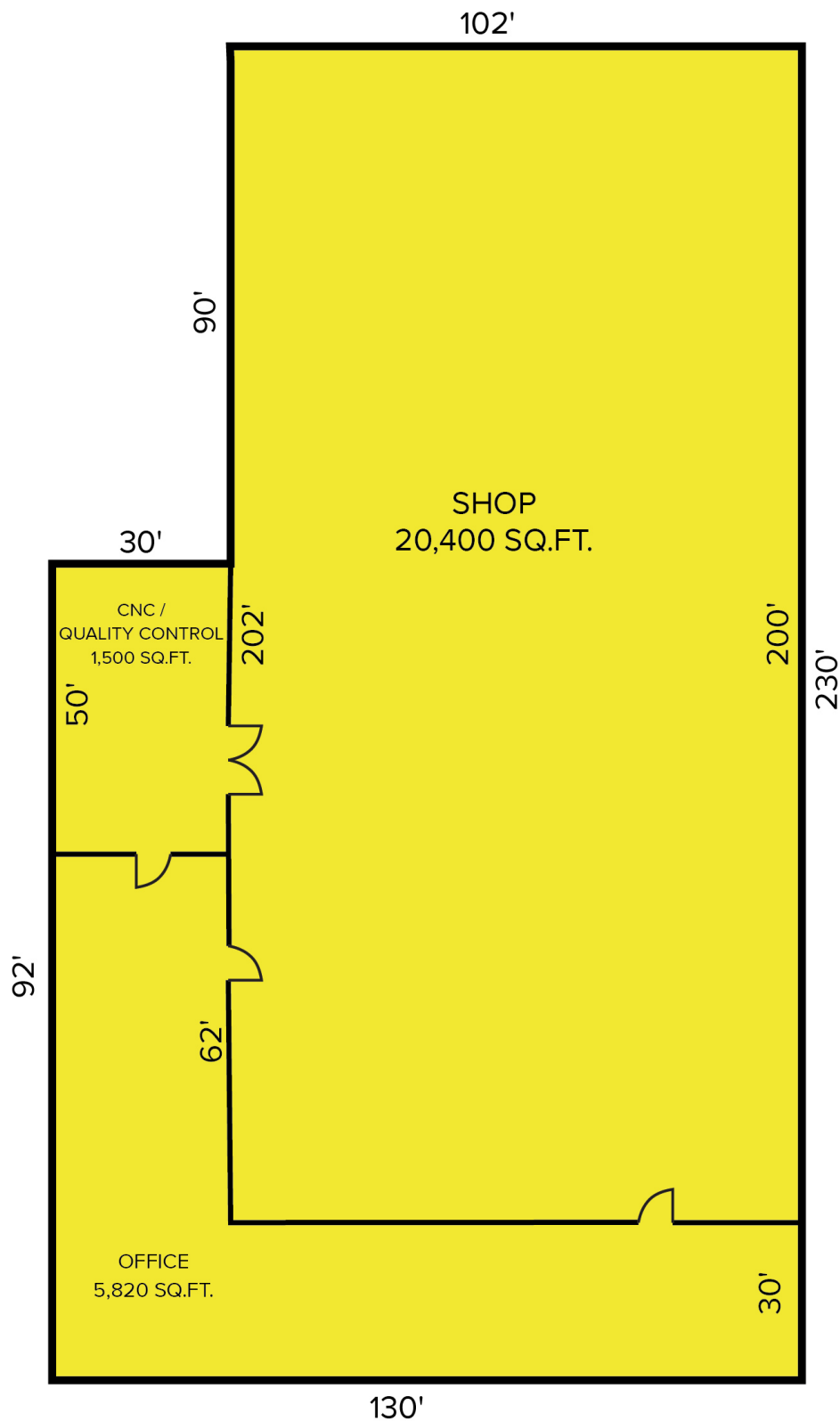

For more information, please contact:

**KRIS PAWLOWSKI**  
(248) 359 3801  
kpawlowski@signatureassociates.com

**SIGNATURE ASSOCIATES**  
One Towne Square, Suite 1200  
Southfield, MI 48076  
www.signatureassociates.com