

2620 Centennial Road - Centennial Commons



SIGNATURE ASSOCIATES
KNOW SIGNATURE | KNOW RESULTS

2620 Centennial Rd, Sylvania Township, OH 43617

Listing ID: 30562022
 Status: Active
 Property Type: Industrial For Lease
 Industrial Type: Mixed Use, Warehouse/Distribution
 Contiguous Space: 2,950 SF
 Total Available: 2,950 SF
 Lease Rate: \$1,598 (Monthly)
 Unit Price: \$6.50 PSF (Annual)
 Base Monthly Rent: \$1,598
 Lease Type: Other
 Loading: 1 Door
 Ceiling: 12 ft.



Overview/Comments

- Very well maintained multi-tenant flex building in Sylvania Township.
- No payroll taxes currently levied in Sylvania Township.
- Professional setting.
- Quick access to US-20 (Central Avenue) and within 3 miles of I-475/US-23 interchange.
- Multiple suites of varying sizes provides flexibility to help “right size” your business.

More Information Online

<https://signatureassociates.catalist.com//listing/30562022>



QR Code

Scan this image with your mobile device:

General Information

Tax ID/APN:	7842164	Building/Unit Size (RSF):	46,000 SF
Industrial Type:	Mixed Use, Warehouse/Distribution	Usable Size (USF):	46,000 SF
Zoning:	M-1 GENERAL INDUSTRIAL DISTRICT	Land Area:	4.55 Acres
Building Name:	Centennial Commons		

Available Space

Suite/Unit Number:	V	Lease Type:	Other
Space Available:	2,950 SF	Loading Docks:	0
Minimum Divisible:	2,950 SF	Loading Doors:	1
Maximum Contiguous:	2,950 SF	Drive In Bays:	0
Space Type:	Relet	Ceiling Height:	12
Date Available:	11/04/2020	Clear Height:	12
Lease Rate:	\$1,598 (Monthly)	Eave Height:	12

Area & Location

Property Located Between: W. Central Avenue & Bancroft Street
 Highway Access: 3 miles of I-475/US-23 interchange

Building Related

Tenancy:	Multiple Tenants	Exterior Description:	Exterior Walls: Concrete block Structural System: Wood truss Roof: Asphalt shingle Floors/ Coverings: Concrete
Total Number of Buildings:	2	Parking Type:	Surface
Number of Stories:	1	Total Parking Spaces:	100
Property Condition:	Excellent	Passenger Elevators:	0
Year Built:	1988		
Roof Type:	Other		

Freight Elevators:	0	Amps:	200
Sprinklers:	None	Heat Type:	Natural Gas

Land Related

Lot Frontage:	319	Water Service:	Municipal
Lot Depth:	642	Sewer Type:	Municipal, Storm

Zoning Description Heating: Gas forced air in office; Co-Ray Vac in shop Air Conditioning: Central in office; some suites have wall units in shop area Power: Varies – 100-200 amp – circuit breakers

Location

Address: 2620 Centennial Rd, Sylvania Township, OH 43617
County: Lucas
MSA: Toledo



Property Images

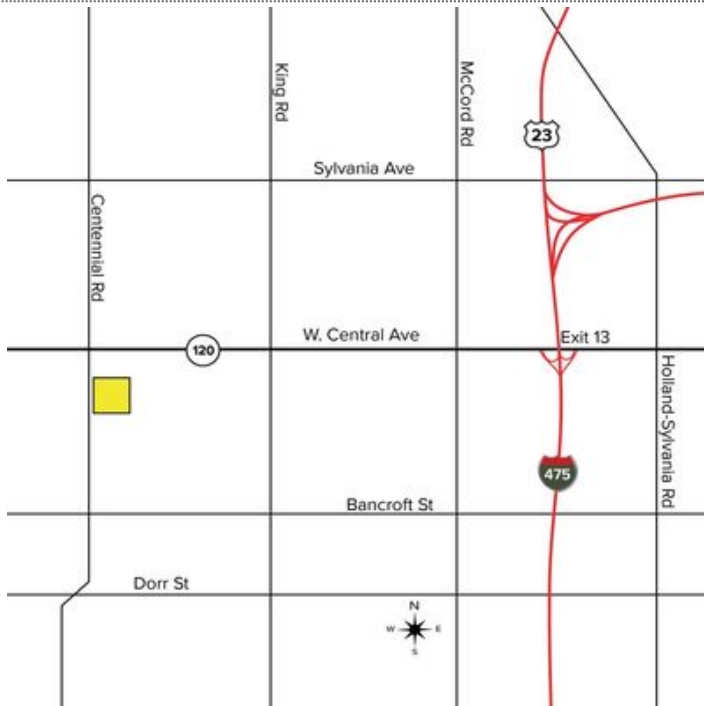

Map sylvania twp_2620 centennial

Property Contacts



Rob Keleghan

Signature Associates

419-680-7663 [M]

419-249-7070 [O]

rkeleghan@signatureassociates.com