

2840 AUBURN COURT  
AUBURN HILLS, MICHIGAN

INDUSTRIAL FOR SALE OR LEASE  
45,360 Square Feet Available



**SIGNATURE  
ASSOCIATES**  
KNOW SIGNATURE | KNOW RESULTS



## PROPERTY FEATURES

- 45,360 square feet available
- 2,600 square feet of office
- 18' clear height
- (4) 12x14 grade level doors, (2) truckwells
- Zoned I-1
- 49 parking spaces
- Very clean manufacturing building
- 4,600 amps, 480 volts power
- Compressor and air lines
- Mezzanine storage
- Lease Rate: \$6.50/sq.ft. NNN
- Sale Price: \$3,175,000 (\$70.04/sq.ft.)



For more information, please contact:

**GREG HUDAS**  
(248) 799 3162  
ghudas@signatureassociates.com

**JOE HAMWAY**  
(248) 948 0113  
jhamway@signatureassociates.com

**SIGNATURE ASSOCIATES**  
One Towne Square, Suite 1200  
Southfield, MI 48076  
www.signatureassociates.com

# 2840 Auburn Court – Auburn Hills, Michigan

Industrial For Sale or Lease

45,360  
Square Feet  
AVAILABLE

## Site Plan

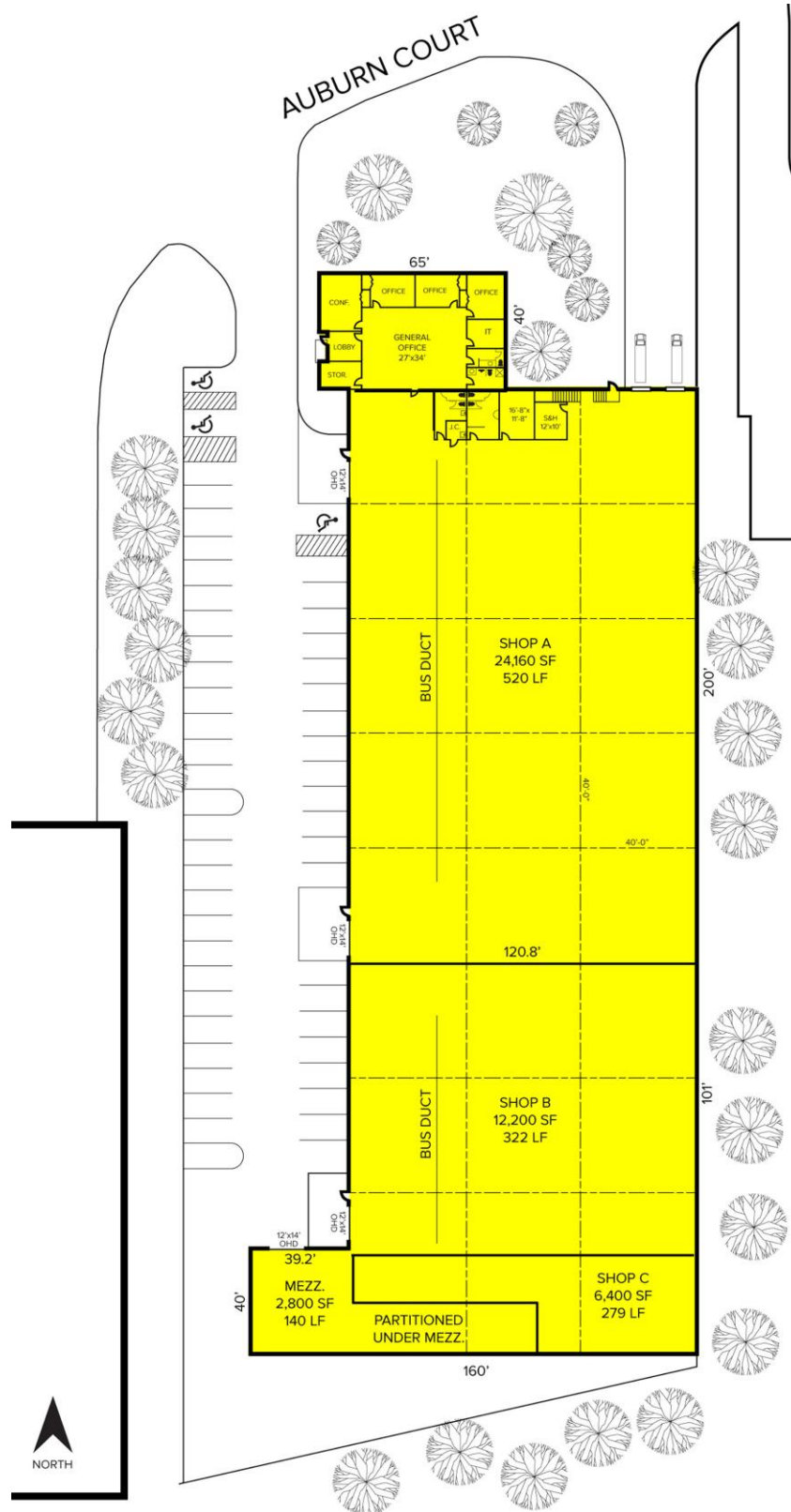

For more information, please contact:

**GREG HUDAS**  
(248) 799 3162

ghudas@signatureassociates.com

**JOE HAMWAY**  
(248) 948 0113

jhamway@signatureassociates.com

**SIGNATURE ASSOCIATES**  
One Towne Square, Suite 1200  
Southfield, MI 48076  
www.signatureassociates.com

# 2840 Auburn Court – Auburn Hills, Michigan

Industrial For Sale or Lease

45,360  
Square Feet  
AVAILABLE

## Floor Plan

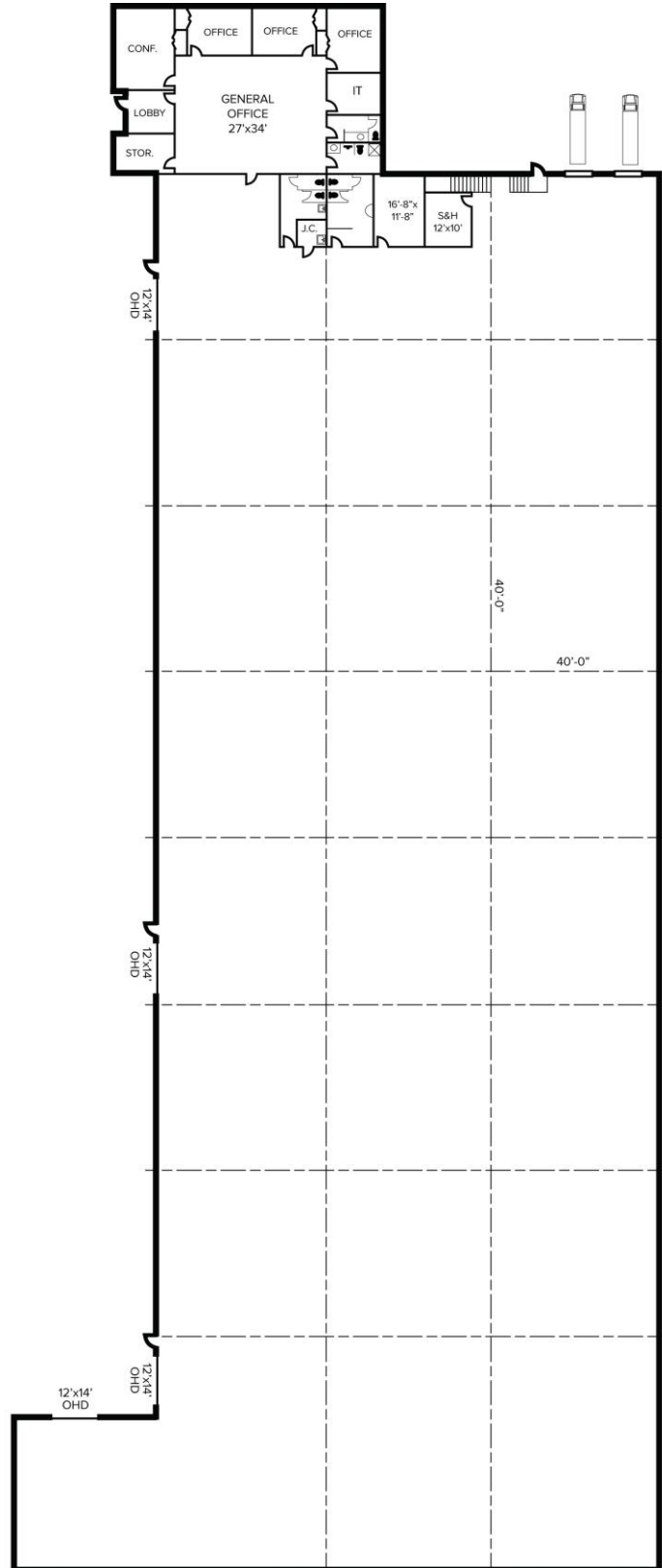

For more information, please contact:

**GREG HUDAS**  
(248) 799 3162  
ghudas@signatureassociates.com

**JOE HAMWAY**  
(248) 948 0113  
jhamway@signatureassociates.com

**SIGNATURE ASSOCIATES**  
One Towne Square, Suite 1200  
Southfield, MI 48076  
www.signatureassociates.com