



Industrial For Lease

Property Name: Metro
Location: 308 Antoine Street
City, State: Wyandotte, MI
Cross Streets: West of Biddle Ave.
County: Wayne
Zoning: Industrial

BUILDING SIZE / AVAILABILITY

Building Type:	Built	Mezzanine:	N/A
Total Building Sq. Ft.:	75,461	Available Shop Sq. Ft.:	70,161
Available Sq. Ft.:	75,461	Available Office Sq. Ft.:	5,300
		Office Dim:	N/A
		Shop Dim:	N/A

PROPERTY INFORMATION

Freestanding:	Yes	Year Built:	1919
Clear Height:	17' - 34'	Rail:	Yes
Grade Level Door(s):	6: 14 x 16	Security:	Yes
Truckwells or Docks:	4	Interior:	No
Exterior Construction:	Steel	Lighting:	T-5
Structural System:	Block	Bay Sizes:	60x25
Air-Conditioning:	No	Restrooms:	M/W
Heating:	Gas	Cranes:	No
Availability:	Immediately	Parking:	65
Power (Amps/Volts):	400 Amps, 240 Volts		
		Roof:	Rubber
		Floors:	6"
		Floor Drains:	Yes
		Acreage:	2.320
		Land Dimensions:	N/A

PRICING INFORMATION

Lease Rate:	\$3.75	Mthly Rate:	N/A	TD:	N/A
Lease Type:	NNN	Taxes:	\$26,241.14 (2018)	Deposit:	2 Months
Lease Term:	5-10 Year(s)	Parcel #:	57-007-02-0176-000	Assessor #:	N/A
Imprv Allow:	N/A	Options:	N/A		
Tenant Responsibility:	N/A				

COMMENTS

Very clean warehouse building! Active CN rail spur.

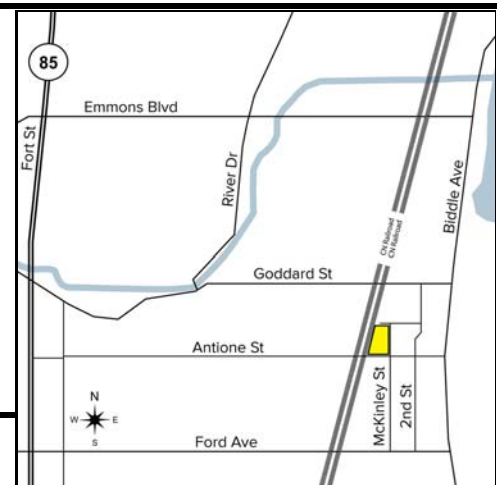

Broker: SIGNATURE ASSOCIATES

Agent(s):

Greg Hudas, (248) 799-3162, ghudas@signatureassociates.com
 Joe Hamway, (248) 948-0113, jhamway@signatureassociates.com