



Investment Sale

1935-1955 Enterprise Drive | Rochester Hills, Michigan

- Main road exposure on Crooks Road
- Fully air-conditioned
- Set-up for back up generator
- 2000 Amps, 277/480 Volts power
- 41,400 sq. ft. with 25,700 sq. ft. office leased to Stant USA until September 2026 (www.stant.com)
- 12,000 sq. ft. with 10,000 sq. ft. office leased to ATI Systems until June 2025 (www.ati-ia.com)
- 2021 NOI \$380,898 w/2.745% escalations

Highlights

Total Building Size:	53,400 SF
Land Area:	4.540 acres
Power:	2,000 amps @ 277/480v
Sprinkler System:	Yes
Car Parking:	153 spaces



Investment Sale

1935-1955 Enterprise Drive | Rochester Hills, Michigan

Site Plan & Aerial

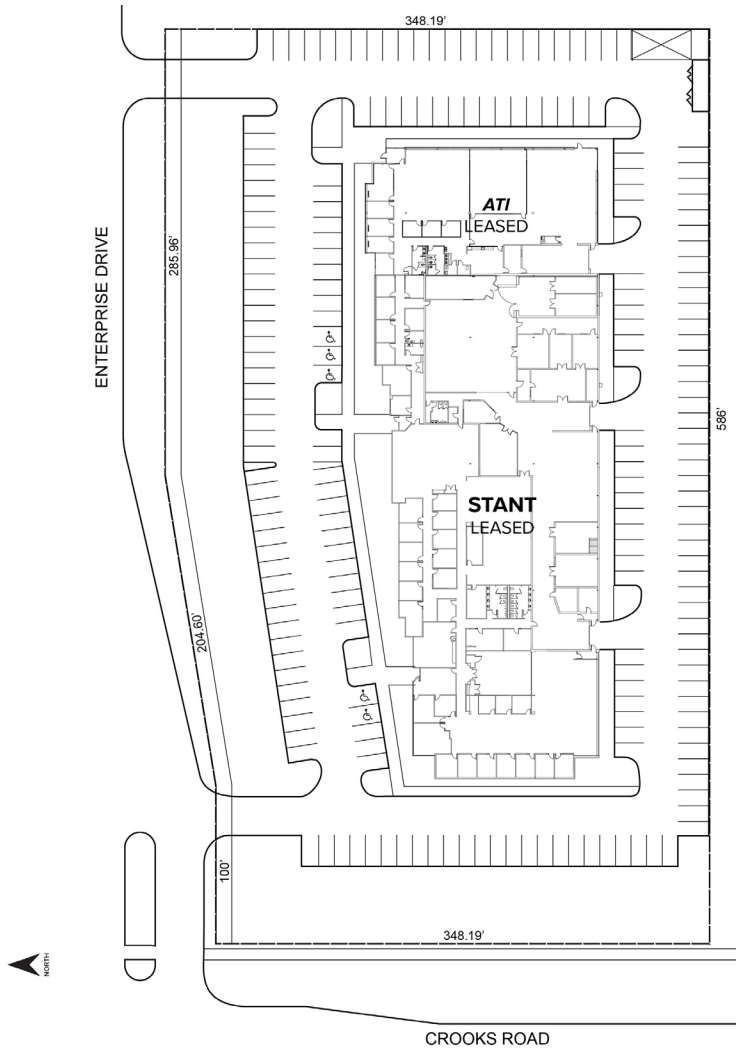

Broker Contact:

Paul Hoge
Senior Vice President | Principal
Direct: (248) 948-0103
paulhoge@signatureassociates.com

Kris Pawlowski
Vice President | Principal
Direct: (248) 359-3801
kpawlowski@signatureassociates.com



SIGNATURE ASSOCIATES
KNOW SIGNATURE | KNOW RESULTS

www.signatureassociates.com

Owner Contact:



www.firstindustrial.com

All information furnished regarding the property for sale, rental or financing is obtained from sources deemed reliable. No representation is made to the accuracy thereof and is submitted subject to errors, omissions, change of price rental or other conditions, prior sale, lease, or financing, or withdrawal without notice. First Industrial Realty Trust, Inc. represents the Seller in this transaction and as such owes all duties and obligations thereto.