



25901 JEFFERSON AVENUE SAINT CLAIR SHORES, MI 48081

PROPERTY HIGHLIGHTS:

- 10,138 SF one-story office building situated on 0.91 acres
- Completely rebuilt in 2011, including new interior, exterior and mechanicals
- Currently built out as general office
- Possible uses include; medical, clinic, credit union/bank, sales office, and professional service establishments
- 10 ft ceilings throughout
- 70-car parking lot
- Zoning O-1, Office Service District
- Corner site with Jefferson Avenue and Lakeland Street frontage
- Lease rate: \$15.50-\$18.50 PSF | Sale price: \$1,550,000

The information provided herein along with any attachment(s) was obtained from sources believed to be reliable, however, Friedman Real Estate makes no guarantees, warranties, or representations as to the completeness or accuracy of such information and legal counsel is advised. All information provided is subject to verification and no liability for reliance on such information or errors or omissions is assumed. The presentation of this property is submitted subject to errors, omissions, change of price or conditions, prior sale or lease, or withdrawal without notice. Copyright © 2021 Friedman Real Estate. All rights reserved.

FOR MORE INFORMATION PLEASE CONTACT:



TODD HAWLEY
todd.hawley@freg.com

248.324.2000

eCODE 76



25901 JEFFERSON AVENUE
PROPERTY PHOTOS



25901 JEFFERSON AVENUE

LOCATION OVERVIEW

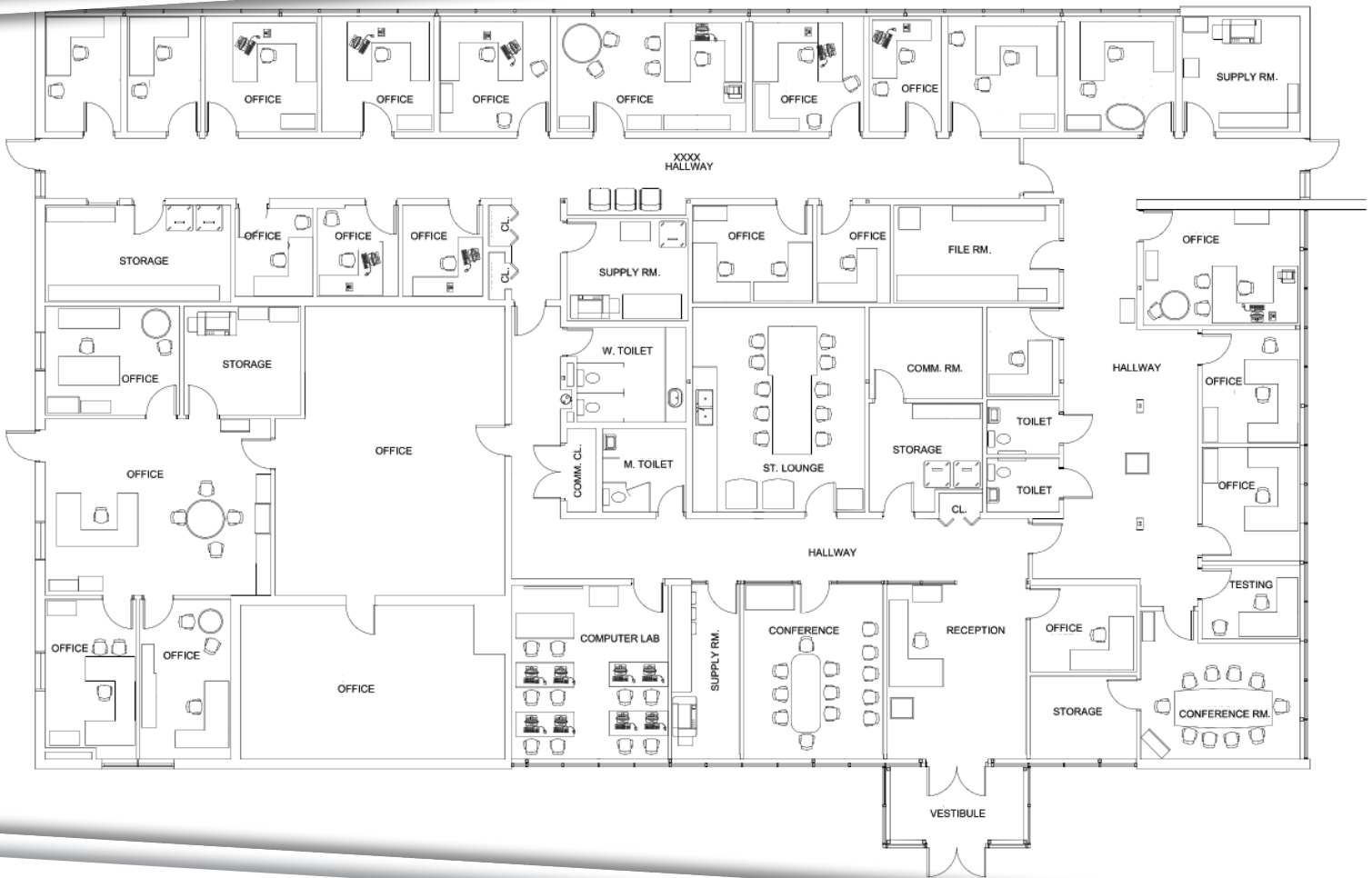

TRAFFIC COUNTS

INTERSECTION	CARS PER DAY
Jefferson Ave & Manor St S	18,910
Jefferson Ave & Pointe Dr N	16,930
Jefferson Ave & E 10 Mile Rd S	19,545
Jefferson Ave & Beach St N	18,836

DEMOGRAPHICS

	1 MILE	3 MILES	5 MILES
Total Population	7,800	86,467	228,786
Total Households	3,594	36,691	94,462
Average HH Income	\$64,247	\$64,668	\$61,888