



Industrial For Sale or Lease

Property Name: Orchard Lake Commerce Park
Location: 2655-2683 Orchard Lake Road
City, State: Sylvan Lake, MI
Cross Streets: Cass Lake Rd.
County: Oakland
Zoning: II

BUILDING SIZE / AVAILABILITY

Total Building Sq. Ft.: 81,676	Building Type: Built	Mezzanine: N/A
Available Sq. Ft.: 2,500 - 13,300	Available Shop Sq. Ft.: 2,500 - 13,300	Office Dim: N/A
	Available Office Sq. Ft.: 0	Shop Dim: N/A

PROPERTY INFORMATION

Clear Height: N/A	Multi-Tenant: Yes	Year Built: N/A
Grade Level Door(s): 8	Rail: No	Sprinklers: No
Truckwells or Docks: 0	Security: No	Signage: Pylon & Bldg.
Exterior Construction: N/A	Interior: N/A	Exterior: N/A
Structural System: N/A	Lighting: Yes	Roof: Flat
Air-Conditioning: N/A	Bay Sizes: N/A	Floors: N/A
Heating: Yes	Restrooms: Yes	Floor Drains: No
Availability: Immediately	Cranes: No	Acreage: 4.060
Power (Amps/Volts): N/A	Parking: 75	Land Dimensions: N/A

PRICING INFORMATION

Lease Rate: Contact Broker	Mthly Rate: Contact Broker	Deposit: Yes
Lease Type: Contact Broker	Lease Term: 5 Year(s)	TD: N/A
Sale Price: \$4,600,000 (\$56.32/sqft)	Taxes: \$63,972.75 (2019)	Parcel #: 18-01-330-025
Imprv Allow: N/A	Options: N/A	Assessor #: N/A
Tenant Responsibility: N/A		

COMMENTS

Orchard Lake Commerce Park is a unique and diversified light industrial complex great for many uses. Excellent road frontage on Orchard Lake Road. Diverse tenant mix, and great opportunity to start your own business. Excellent for car storage and many other uses.

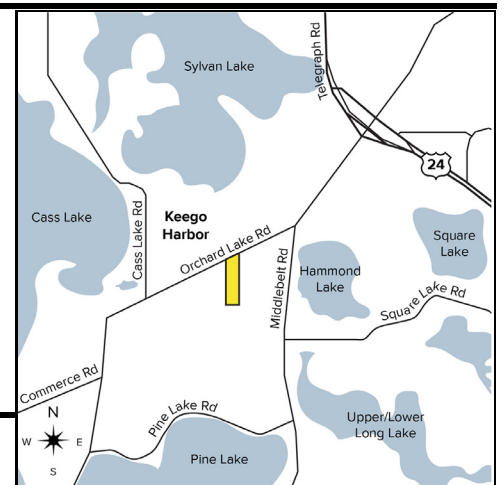

Broker: SIGNATURE ASSOCIATES

Agent(s):

Christopher M. D'angelo, (248) 948-0109, cdangelo@signatureassociates.com
 Dave Miller, (248) 948-4183, dmiller@signatureassociates.com