



BUCKTOWN RESTAURANT/RETAIL/OFFICE SPACE FOR LEASE

1654 W CORTLAND ST
CHICAGO, IL 60622

Marcus Sullivan
Assistant Vice President
O: 312.756.7357
msullivan@svn.com

Property Summary



OFFERING SUMMARY

Available SF: 3,192 SF

Lease Rate: \$25/NNN

Lot Size: 7,500 SF

Zoning: C1-2

Market: Chicago North

Submarket: Bucktown

PROPERTY OVERVIEW

Situated on Cortland St just to the west of Ashland Ave, the subject property is a 3,192 square foot retail space with an additional 2,500 square foot patio. Located on the ground floor of a mixed-use building, the space is ideal for restaurant, retail, or office use, and will be delivered vanilla box.

LOCATION OVERVIEW

Bucktown is one of Chicago's creative epicenters which lies just to the northwest of downtown Chicago. It is a neighborhood known for live music and nightlife, chef-driven restaurants, countless art galleries, and unique retail tenants. In addition Bucktown is conveniently serviced by the CTA, Metra, and I-90/94. The subject property's Bucktown location is also situated in close proximity to The 606 Bloomingdale Trail, Damen Avenue retail corridor, and tremendous urban development along the Clybourn Corridor/Goose Island.

PROPERTY HIGHLIGHTS

- 3,192 Square Feet Available
- 2,500 Square Foot Patio
- 75 Feet Of Frontage On Cortland
- Area Population Density

Additional Photos



Proposed Floor Plan

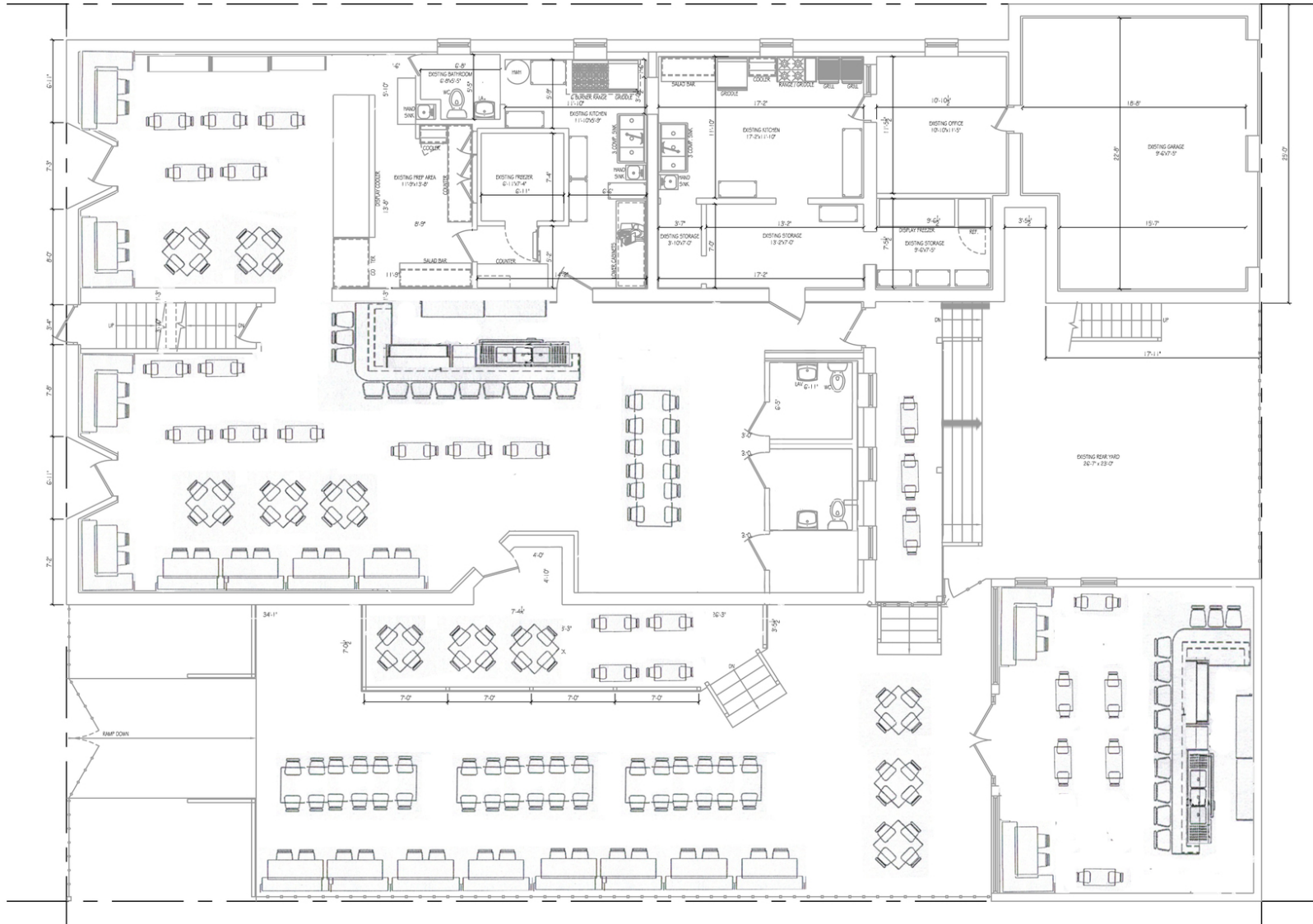

Retailer Map

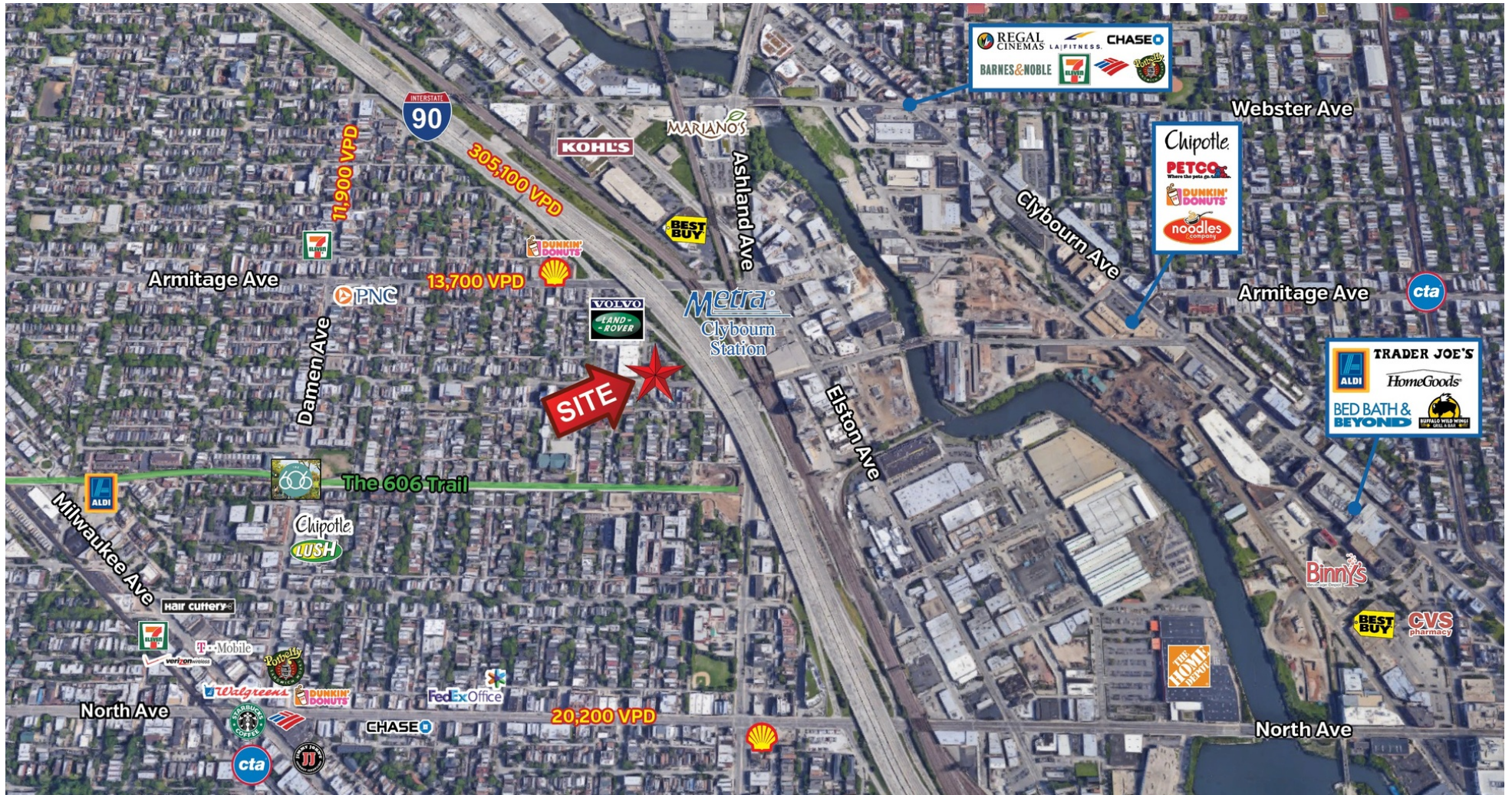

Location Maps

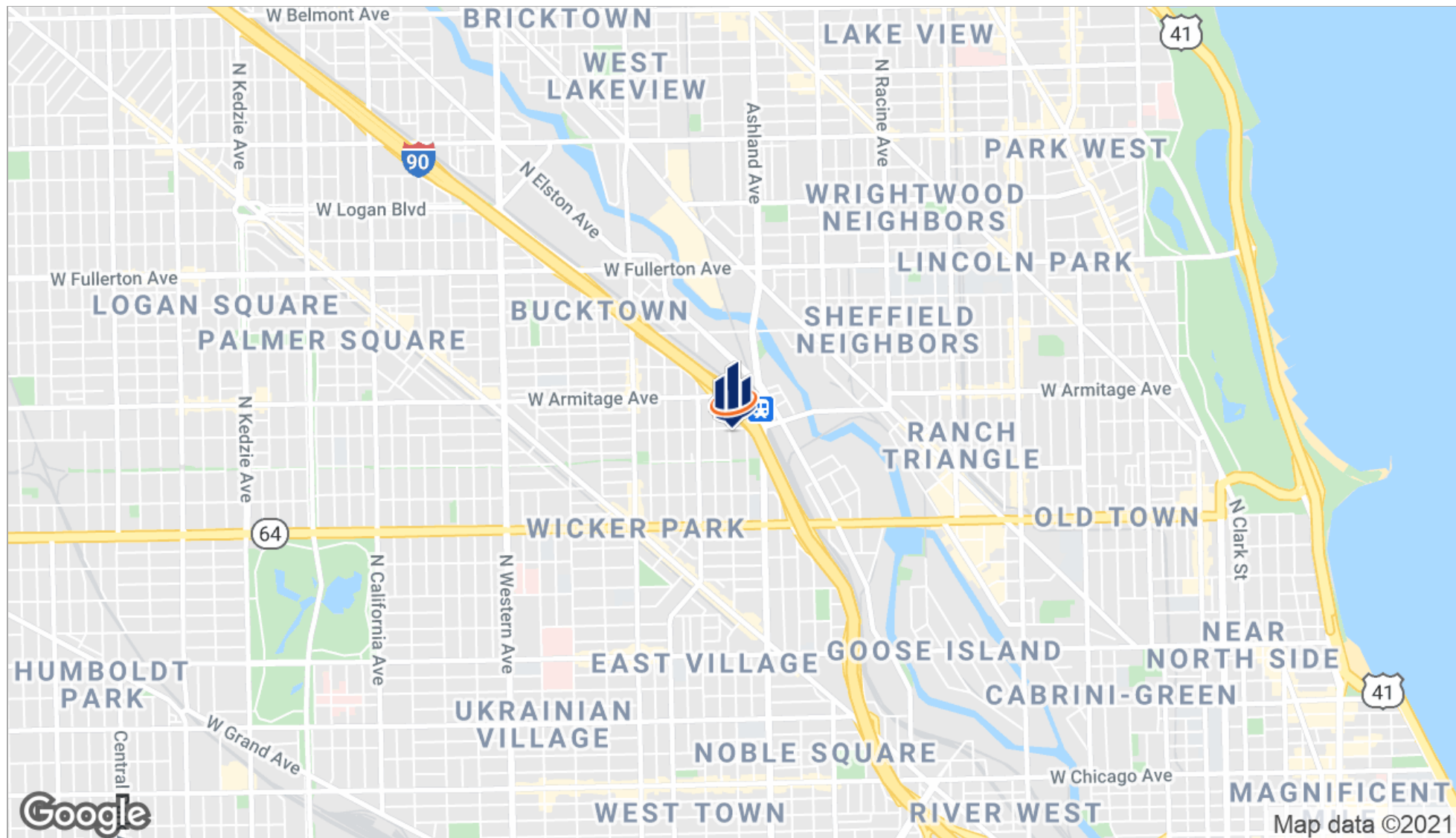

1 Mile Demographics

