

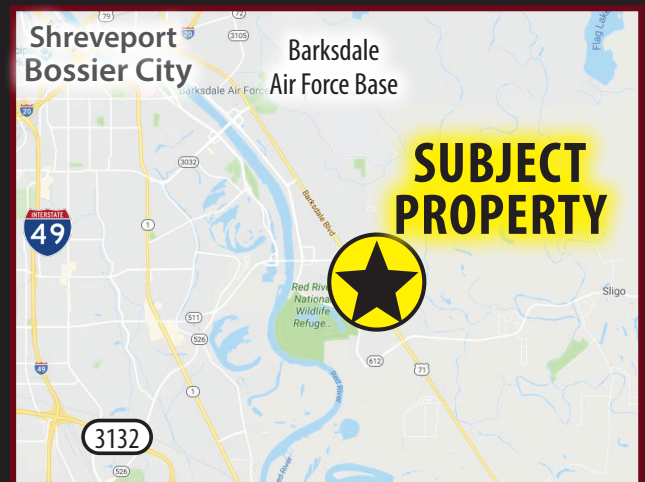

CAR LOT FOR LEASE

4930 BARKSDALE BLVD., BOSSIER CITY 71112

- 38,795/sf Lot
- 1,513/sf Sales Office
- Two Private Offices
- 6 Cubicles
- Waiting Area
- 2 Restrooms
- Break Room
- 70 Parking Spaces
- Perfect for car sales lot or rental lot
- Highly visible location in growing South Bossier
- \$5,500/mo NNN
- Zoned B-3



For more information, contact:

Michael Morrison | Chris Susilovich | 318-222-2244
mmorrison@vintagerealty.com | csusilovich@vintagerealty.com



ALL INFORMATION CONTAINED HEREIN IS BELIEVED TO BE ACCURATE, BUT IS NOT WARRANTED AND NO LIABILITY OF ERRORS OR OMISSIONS IS ASSURED BY EITHER THE PROPERTY OWNER OR VINTAGE REALTY COMPANY OR ITS AGENTS AND EMPLOYEES. PRICES AS STATED HEREIN AND PRODUCT AVAILABILITY IS SUBJECT TO CHANGE AND/OR SALE OR LEASE WITHOUT PRIOR NOTICE, AND ALL SIZES AND DIMENSIONS ARE SUBJECT TO CORRECTION. REV 1/2021

CAR LOT FOR LEASE

4930 BARKSDALE BLVD.,
BOSSIER CITY, LA 71112



For information, please contact:

Michael Morrison | Chris Susilovich | 318-222-2244

mmorrison@vintagerealty.com | csusilovich@vintagerealty.com

ALL INFORMATION CONTAINED HEREIN IS BELIEVED TO BE ACCURATE, BUT IS NOT WARRANTED AND NO LIABILITY OF ERRORS OR OMISSIONS IS ASSURED BY EITHER THE PROPERTY OWNER OR VINTAGE REALTY COMPANY OR ITS AGENTS AND EMPLOYEES. PRICES AS STATED HEREIN AND PRODUCT AVAILABILITY IS SUBJECT TO CHANGE AND/OR SALE OR LEASE WITHOUT PRIOR NOTICE, AND ALL SIZES AND DIMENSIONS ARE SUBJECT TO CORRECTION. 1/2021

CAR LOT FOR LEASE

4930 BARKSDALE BLVD.,
BOSSIER CITY, LA 71112



For information, please contact:

Michael Morrison | Chris Susilovich | 318-222-2244

mmorrison@vintagerealty.com | csusilovich@vintagerealty.com

ALL INFORMATION CONTAINED HEREIN IS BELIEVED TO BE ACCURATE, BUT IS NOT WARRANTED AND NO LIABILITY OF ERRORS OR OMISSIONS IS ASSURED BY EITHER THE PROPERTY OWNER OR VINTAGE REALTY COMPANY OR ITS AGENTS AND EMPLOYEES. PRICES AS STATED HEREIN AND PRODUCT AVAILABILITY IS SUBJECT TO CHANGE AND/OR SALE OR LEASE WITHOUT PRIOR NOTICE, AND ALL SIZES AND DIMENSIONS ARE SUBJECT TO CORRECTION. 1/2021

DEMOGRAPHIC SNAPSHOT - 1, 3, 5 MILE RADIUS



Executive Summary

4930 Barksdale Blvd, Bossier City, Louisiana, 71112
Rings: 1, 3, 5 mile radii

Prepared by Esri
Latitude: 32.45724
Longitude: -93.66082

	1 mile	3 miles	5 miles
Population			
2000 Population	5,879	21,896	77,240
2010 Population	7,658	27,184	84,747
2020 Population	8,906	30,754	89,225
2025 Population	9,436	31,728	89,425
2000-2010 Annual Rate	2.68%	2.19%	0.93%
2010-2020 Annual Rate	1.48%	1.21%	0.50%
2020-2025 Annual Rate	1.16%	0.63%	0.04%
2020 Male Population	50.2%	49.5%	48.8%
2020 Female Population	49.8%	50.5%	51.2%
2020 Median Age	37.6	37.1	36.6

In the identified area, the current year population is 89,225. In 2010, the Census count in the area was 84,747. The rate of change since 2010 was 0.50% annually. The five-year projection for the population in the area is 89,425 representing a change of 0.04% annually from 2020 to 2025. Currently, the population is 48.8% male and 51.2% female.

	1 mile	3 miles	5 miles
Households			
2020 Wealth Index	79	73	70
2000 Households	2,150	8,529	32,460
2010 Households	2,936	11,008	36,137
2020 Total Households	3,452	12,324	37,827
2025 Total Households	3,675	12,713	37,855
2000-2010 Annual Rate	3.16%	2.58%	1.08%
2010-2020 Annual Rate	1.59%	1.11%	0.45%
2020-2025 Annual Rate	1.26%	0.62%	0.01%
2020 Average Household Size	2.52	2.42	2.29

The household count in this area has changed from 36,137 in 2010 to 37,827 in the current year, a change of 0.45% annually. The five-year projection of households is 37,855, a change of 0.01% annually from the current year total. Average household size is currently 2.29, compared to 2.29 in the year 2010. The number of families in the current year is 21,623 in the specified area.

	1 mile	3 miles	5 miles
Average Household Income			
2020 Average Household Income	\$82,828	\$78,282	\$72,818
2025 Average Household Income	\$89,226	\$83,788	\$77,341
2020-2025 Annual Rate	1.50%	1.37%	1.21%

Data Note: Income is expressed in current dollars. Housing Affordability Index and Percent of Income for Mortgage calculations are only available for areas with 50 or more owner-occupied housing units.

Source: U.S. Census Bureau, Census 2010 Summary File 1. Esri forecasts for 2020 and 2025. Esri converted Census 2000 data into 2010 geography.

January 08, 2021



For information, please contact:

Michael Morrison | Chris Susilovich | 318-222-2244
mmorrison@vintagerealty.com | csusilovich@vintagerealty.com

ALL INFORMATION CONTAINED HEREIN IS BELIEVED TO BE ACCURATE, BUT IS NOT WARRANTED AND NO LIABILITY OF ERRORS OR OMISSIONS IS ASSURED BY EITHER THE PROPERTY OWNER OR VINTAGE REALTY COMPANY OR ITS AGENTS AND EMPLOYEES. PRICES AS STATED HEREIN AND PRODUCT AVAILABILITY IS SUBJECT TO CHANGE AND/OR SALE OR LEASE WITHOUT PRIOR NOTICE, AND ALL SIZES AND DIMENSIONS ARE SUBJECT TO CORRECTION. 1/2021