

RETAIL BUILDING FOR SALE OR LEASE

1120 E Waterloo Road, Akron, OH 44306

MAJOR PRICE REDUCTION!



OVERVIEW

This property was originally the Ponderosa Steak House and most recently was occupied by the Son's of Herman. The property is most suitable for a restaurant or club. The property features a bar with a dining area, and a full kitchen.

Contact Tom Franjesh or TJ Hollin for more details.

HIGHLIGHTS

- Available for Sale or Lease
- Great Highway Access



Sale Price:

~~\$450,000~~
\$349,000



Lease Rate:

\$3,500 / Month
(Gross)



Building Size:

5,512 SF



Lot Size:

1.15 Acres



Zoning:

Commercial

OUR NETWORK IS YOUR EDGE.

All information is from sources deemed reliable and is subject to errors, omissions, change of price, rental, prior sale, and withdrawal without notice. Prospect should carefully verify each item of information contained herein.

Tom Franjesh

O: 330.940.9360

C: 330.328.3327

tfranjesh@hoffleigh.com

TJ Hollin

O: 330.940.9360

C: 330.618.8045

tjhollin@hoffleigh.com



RETAIL BUILDING FOR SALE OR LEASE

1120 E Waterloo Road, Akron, OH 44306



OUR NETWORK IS YOUR EDGE.

All information is from sources deemed reliable and is subject to errors, omissions, change of price, rental, prior sale, and withdrawal without notice. Prospect should carefully verify each item of information contained herein.

Tom Franjesh
O: 330.940.9360
C: 330.328.3327
tfranjesh@hoffleigh.com

TJ Hollin
O: 330.940.9360
C: 330.618.8045
tjhollin@hoffleigh.com



RETAIL BUILDING FOR SALE OR LEASE

1120 E Waterloo Road, Akron, OH 44306



OUR NETWORK IS YOUR EDGE.

All information is from sources deemed reliable and is subject to errors, omissions, change of price, rental, prior sale, and withdrawal without notice. Prospect should carefully verify each item of information contained herein.

Tom Franjesh

O: 330.940.9360

C: 330.328.3327

tfranjesh@hoffleigh.com

TJ Hollin

O: 330.940.9360

C: 330.618.8045

tjhollin@hoffleigh.com

RETAIL BUILDING FOR SALE OR LEASE

1120 E Waterloo Road, Akron, OH 44306

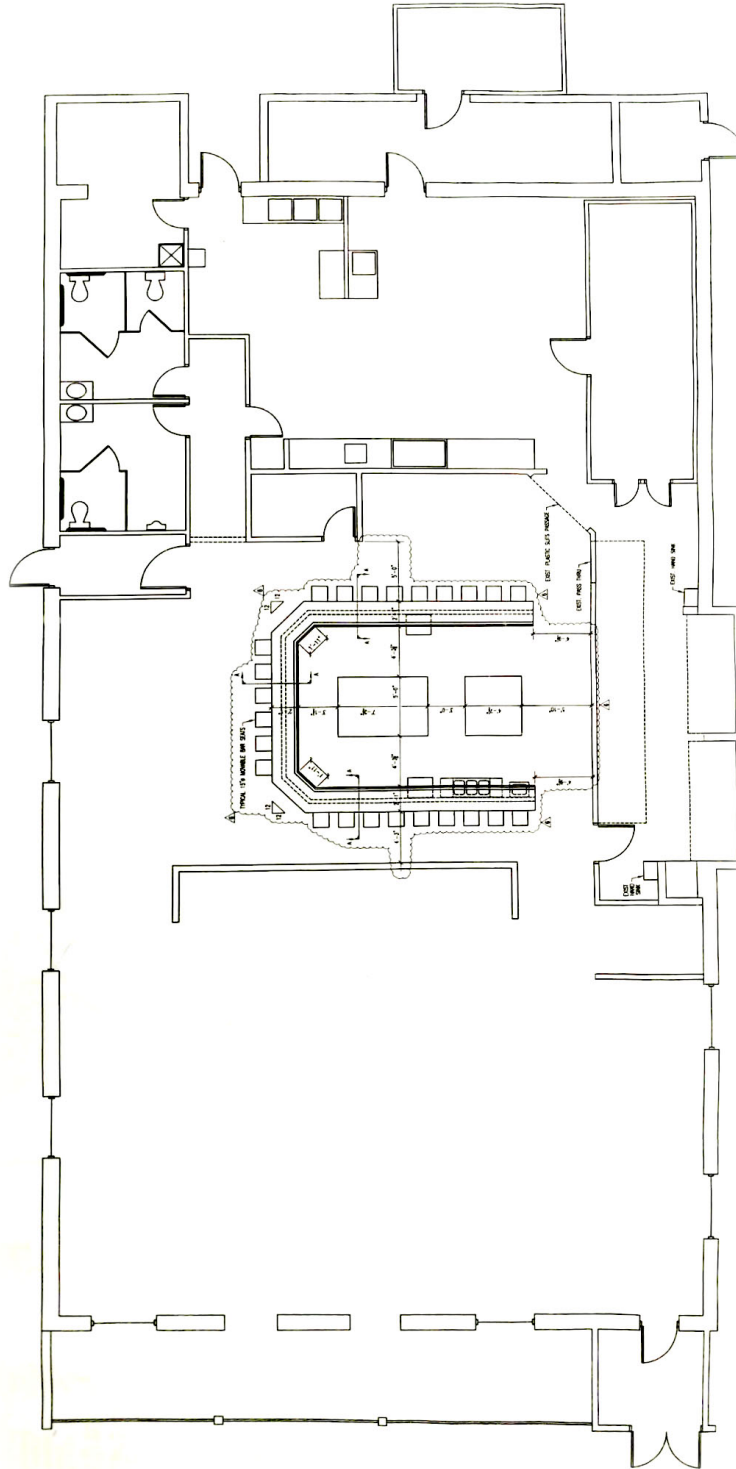

OUR NETWORK IS YOUR EDGE.

All information is from sources deemed reliable and is subject to errors, omissions, change of price, rental, prior sale, and withdrawal without notice. Prospect should carefully verify each item of information contained herein.

Tom Franjesh

O: 330.940.9360

C: 330.328.3327

tfranjesh@hoffleigh.com

TJ Hollin

O: 330.940.9360

C: 330.618.8045

tjhollin@hoffleigh.com



RETAIL BUILDING FOR SALE OR LEASE

1120 E Waterloo Road, Akron, OH 44306

1120 E Waterloo Rd, Akron, Ohio, 44306

DEMOGRAPHICS



67,558
Population



37.1
Median Age



2.4
Average
Household Size



\$38,094
Median Household
Income

TRAFFIC COUNT

| Cross street | Traffic 1 | Distance |
|----------------|-----------|----------|
| Exeter Rd | 5,666 | 0.1 |
| S Arlington St | 22,885 | 0.3 |
| Mohawk Dr | 4,229 | 0.3 |
| Kelly Ave | 26,130 | 0.3 |

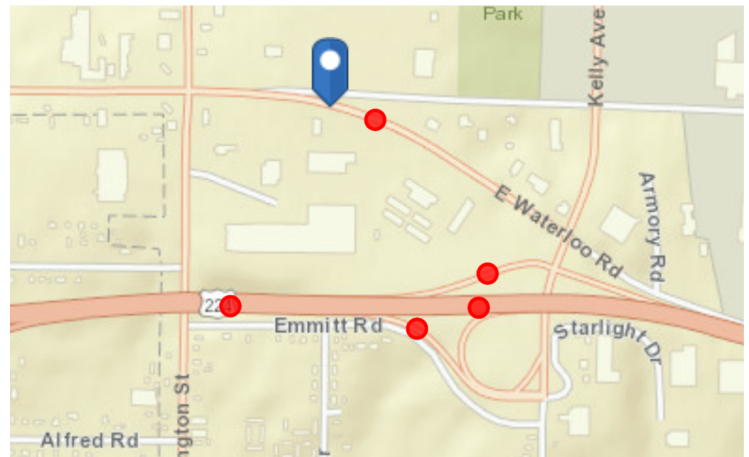

OUR NETWORK IS YOUR EDGE.

All information is from sources deemed reliable and is subject to errors, omissions, change of price, rental, prior sale, and withdrawal without notice. Prospect should carefully verify each item of information contained herein.

Tom Franjesh

O: 330.940.9360

C: 330.328.3327

tfranjesh@hoffleigh.com

TJ Hollin

O: 330.940.9360

C: 330.618.8045

tjhollin@hoffleigh.com



RETAIL BUILDING FOR SALE OR LEASE

1120 E Waterloo Road, Akron, OH 44306

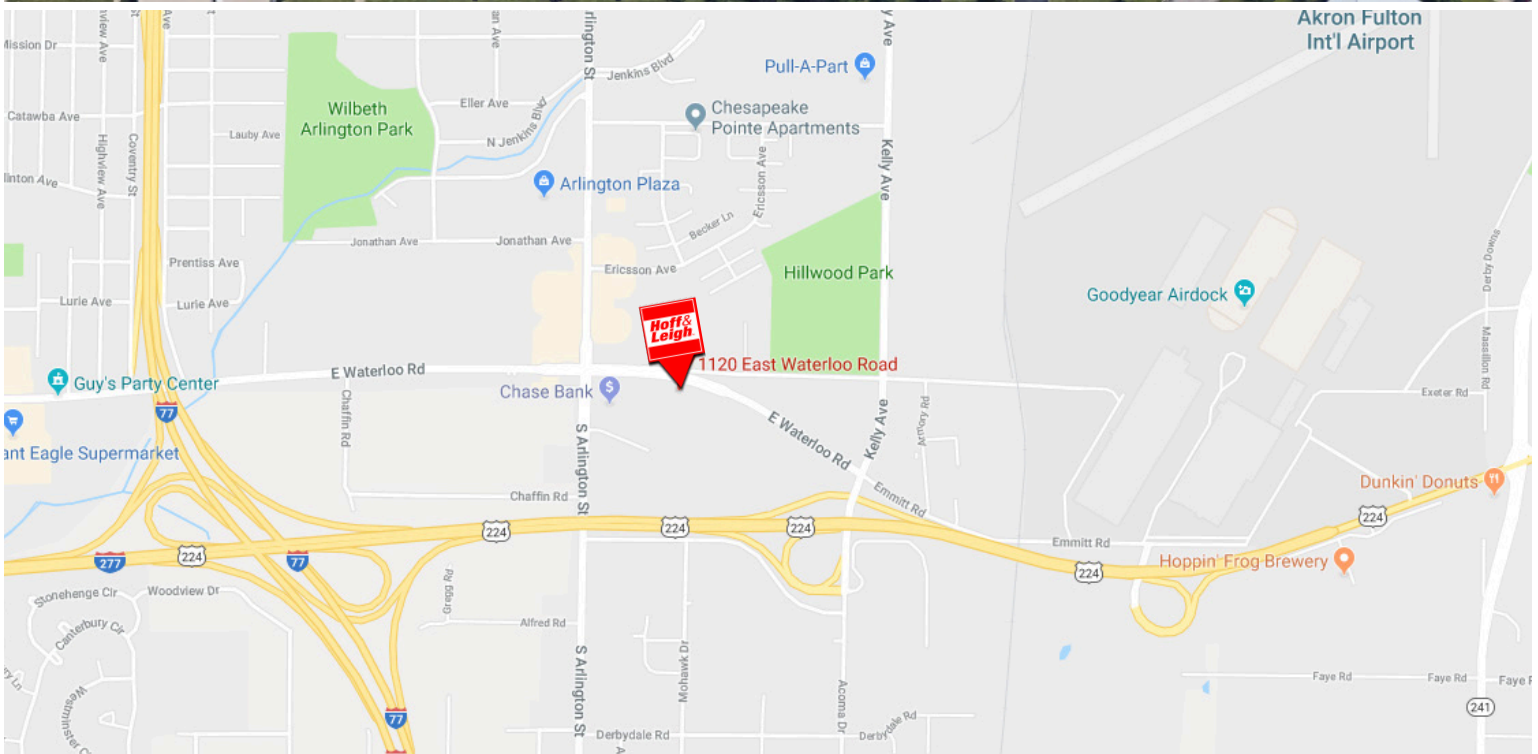

OUR NETWORK IS YOUR EDGE.

All information is from sources deemed reliable and is subject to errors, omissions, change of price, rental, prior sale, and withdrawal without notice. Prospect should carefully verify each item of information contained herein.

Tom Franjesh
O: 330.940.9360
C: 330.328.3327
tfranjesh@hoffleigh.com

TJ Hollin
O: 330.940.9360
C: 330.618.8045
tjhollin@hoffleigh.com