



**SUBJECT
PROPERTY
22ND FLOOR SUITE**

REGIONS TOWER OFFICE SUITE

AVAILABLE FOR LEASE

333 TEXAS STREET, SUITE 2230, SHREVEPORT, LA 71101

- Professional - Attractive Office Space
- Located on the 22nd floor of 23 High Rise Office Building in center of Downtown
- 2,720 square feet
- Efficient layout with above standard glass, wood finishes, fixtures and cabinets
- Offered at a great value below market Class A space
- Covered parking available
- Other Building Amenities:
 - Fitness Center
 - Regions Branch
 - Bistro on first floor
 - Large Conference rooms available on reservation basis.

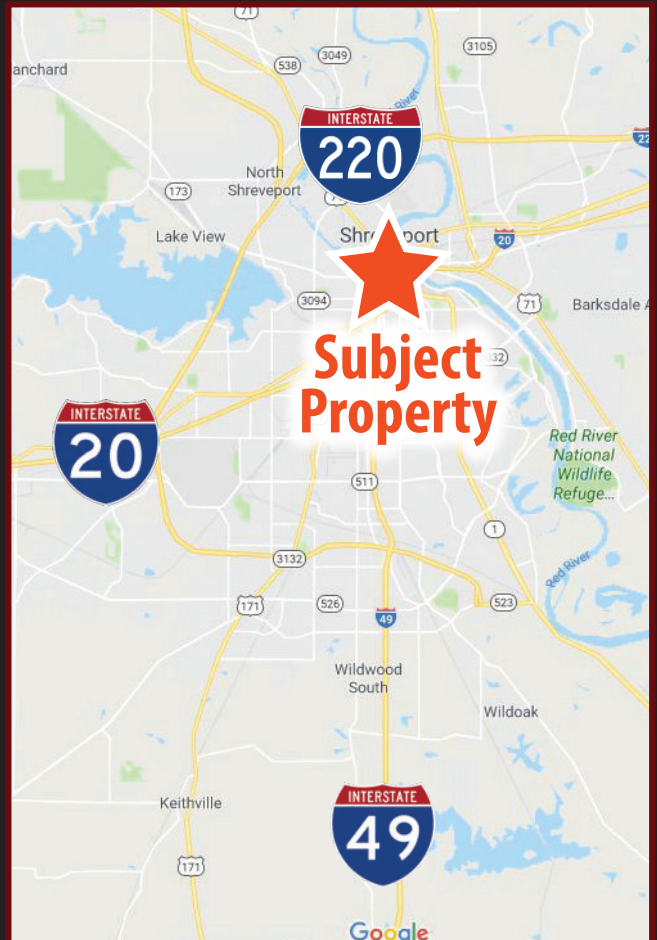

For more information, contact:

Michele Sauls, Associate Broker | 318.222.2244

msauls@vintagerealty.com | vintagerealty.com

ALL INFORMATION CONTAINED HEREIN IS BELIEVED TO BE ACCURATE, BUT IS NOT WARRANTED AND NO LIABILITY OF ERRORS OR OMISSIONS IS ASSURED BY EITHER THE PROPERTY OWNER OR VINTAGE REALTY COMPANY OR ITS AGENTS AND EMPLOYEES. PRICES AS STATED HEREIN AND PRODUCT AVAILABILITY IS SUBJECT TO CHANGE AND/OR SALE OR LEASE WITHOUT PRIOR NOTICE, AND ALL SIZES AND DIMENSIONS ARE SUBJECT TO CORRECTION. REV 12/2020



REGIONS TOWER OFFICE FOR LEASE

333 TEXAS STREET, SUITE 2230
SHREVEPORT, LA 71101



For more information, contact:

Michele Sauls | 318-222-2244

msauls@vintagerealty.com | vintagerealty.com

ALL INFORMATION CONTAINED HEREIN IS BELIEVED TO BE ACCURATE, BUT IS NOT WARRANTED AND NO LIABILITY OF ERRORS OR OMISSIONS IS ASSURED BY EITHER THE PROPERTY OWNER OR VINTAGE REALTY COMPANY OR ITS AGENTS AND EMPLOYEES. PRICES AS STATED HEREIN AND PRODUCT AVAILABILITY IS SUBJECT TO CHANGE AND/OR SALE OR LEASE WITHOUT PRIOR NOTICE, AND ALL SIZES AND DIMENSIONS ARE SUBJECT TO CORRECTION. 12/2020

FLOOR PLAN

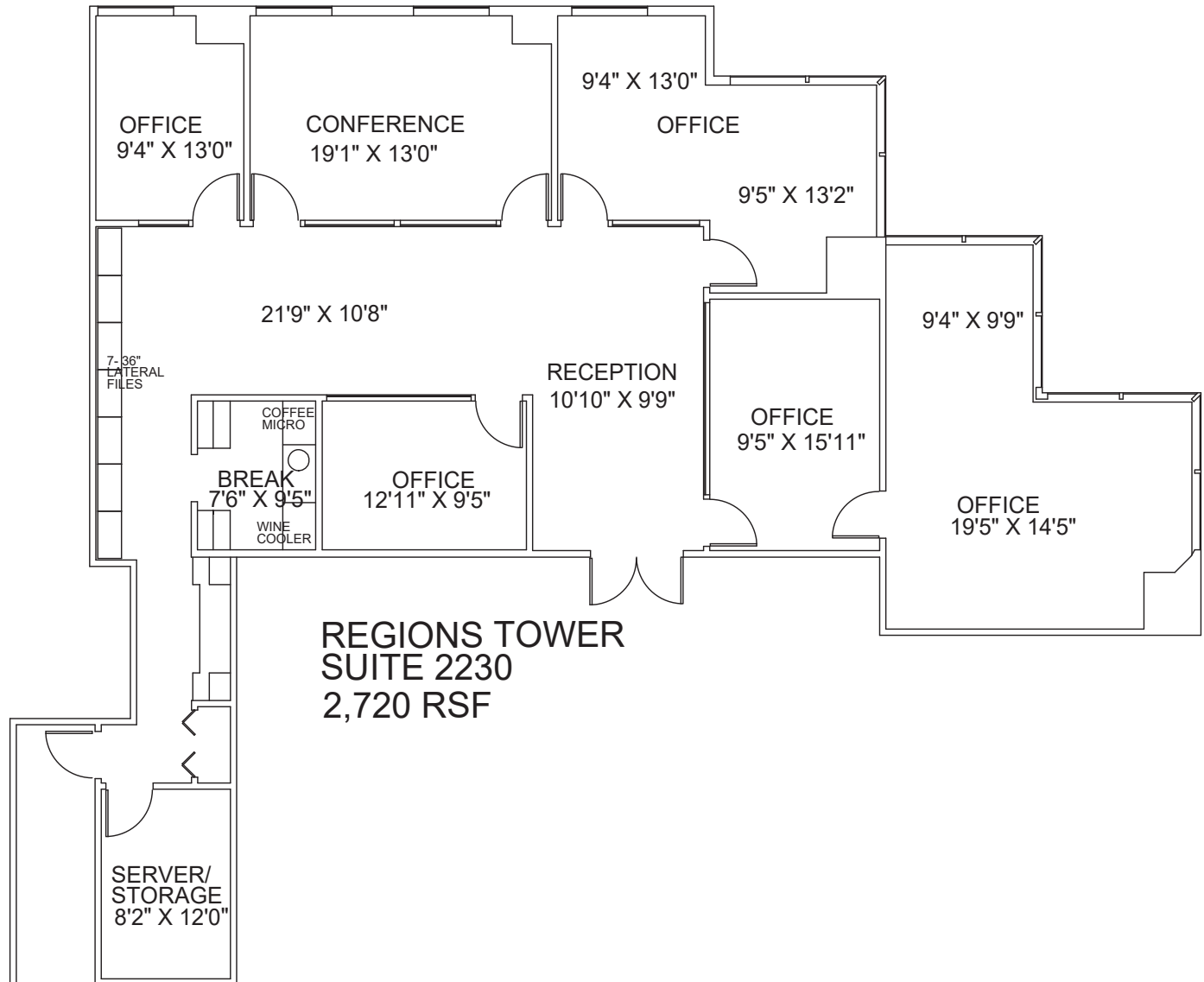

For more information, contact:

Michele Sauls | 318-222-2244

msauls@vintagerealty.com | vintagerealty.com

ALL INFORMATION CONTAINED HEREIN IS BELIEVED TO BE ACCURATE, BUT IS NOT WARRANTED AND NO LIABILITY OF ERRORS OR OMISSIONS IS ASSURED BY EITHER THE PROPERTY OWNER OR VINTAGE REALTY COMPANY OR ITS AGENTS AND EMPLOYEES. PRICES AS STATED HEREIN AND PRODUCT AVAILABILITY IS SUBJECT TO CHANGE AND/OR SALE OR LEASE WITHOUT PRIOR NOTICE, AND ALL SIZES AND DIMENSIONS ARE SUBJECT TO CORRECTION. 12/2020

REGIONS TOWER OFFICE FOR LEASE

333 TEXAS STREET, SUITE 2230
SHREVEPORT, LA 71101



[For more information, contact:](#)

Michele Sauls | 318-222-2244

msauls@vintagerealty.com | vintagerealty.com

ALL INFORMATION CONTAINED HEREIN IS BELIEVED TO BE ACCURATE, BUT IS NOT WARRANTED AND NO LIABILITY OF ERRORS OR OMISSIONS IS ASSURED BY EITHER THE PROPERTY OWNER OR VINTAGE REALTY COMPANY OR ITS AGENTS AND EMPLOYEES. PRICES AS STATED HEREIN AND PRODUCT AVAILABILITY IS SUBJECT TO CHANGE AND/OR SALE OR LEASE WITHOUT PRIOR NOTICE, AND ALL SIZES AND DIMENSIONS ARE SUBJECT TO CORRECTION. 12/2020