

GATEWAY COMMONS

6350 HIGHLAND ROAD, WHITE LAKE TOWNSHIP, MI 48383

1,600 - 15,000 SF AVAILABLE INCLUDING FREESTANDING WITH DRIVE-THRU

FOR LEASE

GATEWAY COMMONS | WHITE LAKE



KEVIN BERKE

248.356.8000 x104
kberke@keystonecres.com

KATHLEEN GARMO

248.356.8000 x111
kgarmo@keystonecres.com



GATEWAY COMMONS

6350 HIGHLAND ROAD, WHITE LAKE TOWNSHIP, MI 48383

SITE PLANS

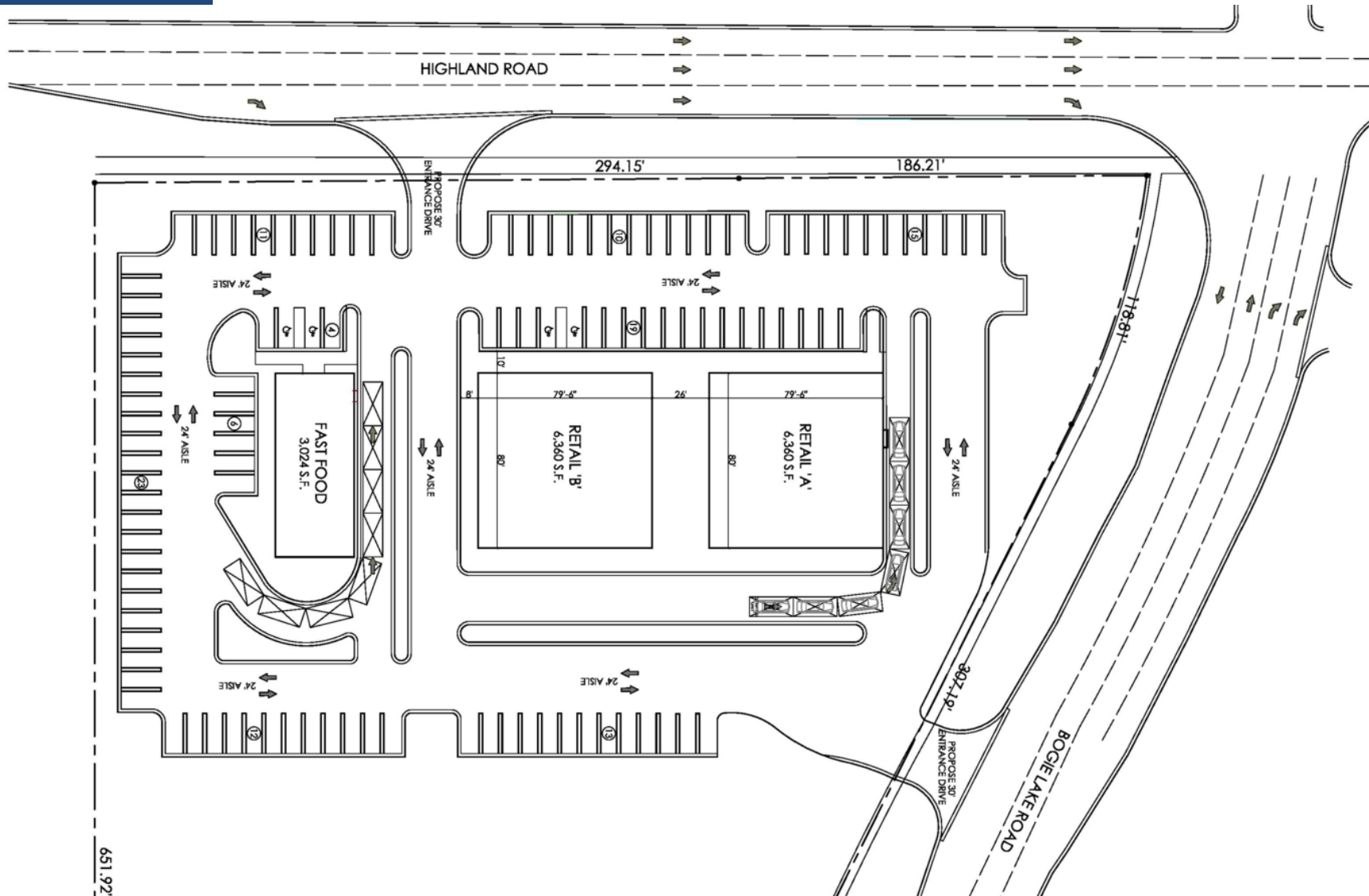

KEVIN BERKE

248.356.8000 x104

kberke@keystonecres.com

KATHLEEN GARMO

248.356.8000 x111

kgarmo@keystonecres.com



GATEWAY COMMONS

6350 HIGHLAND ROAD, WHITE LAKE TOWNSHIP, MI 48383

TRADE AERIAL



Map data ©2021 Imagery ©2021, CNES / Airbus, Maxar Technologies, U.S. Geological Survey, USDA Farm Service Agency

KEVIN BERKE

248.356.8000 x104
kberke@keystonecres.com

KATHLEEN GARMO

248.356.8000 x111
kgarmo@keystonecres.com



GATEWAY COMMONS

6350 HIGHLAND ROAD, WHITE LAKE TOWNSHIP, MI 48383

DEMOGRAPHICS

POPULATION	1 MILE	5 MILES	10 MILES
Total Population	2,012	57,144	276,580
Average age	40.9	40.6	39.6
Average age (Male)	39.8	39.9	38.6
Average age (Female)	41.2	41.0	40.1

HOUSEHOLDS & INCOME	1 MILE	5 MILES	10 MILES
Total households	695	20,406	106,503
# of persons per HH	2.9	2.8	2.6
Average HH income	\$90,217	\$90,598	\$85,080
Average house value	\$213,673	\$261,046	\$247,531

ETHNICITY (%)	1 MILE	5 MILES	10 MILES
Hispanic	3.7%	2.8%	2.8%

RACE	1 MILE	5 MILES	10 MILES
Total Population - White	1,927	54,476	256,298
Total Population - Black	6	750	8,171
Total Population - Asian	10	478	5,759
Total Population - Hawaiian	0	6	52
Total Population - American Indian	7	148	740
Total Population - Other	17	310	1,603

* Demographic data derived from 2010 US Census

KEVIN BERKE

248.356.8000 x104
kberke@keystonecres.com

KATHLEEN GARMO

248.356.8000 x111
kgarmo@keystonecres.com



GATEWAY COMMONS

6350 HIGHLAND ROAD, WHITE LAKE TOWNSHIP, MI 48383

BROKERS



KEVIN BERKE

Senior Sales Associate

kberke@keystonecres.com



KATHLEEN GARMO

Sales Associate

kgarmo@keystonecres.com

KEVIN BERKE

248.356.8000 x104
kberke@keystonecres.com

KATHLEEN GARMO

248.356.8000 x111
kgarmo@keystonecres.com

