



STONEWALL OFFICE/RETAIL

FOR LEASE

671 HIGHWAY 171, STONEWALL, LA 71078

- 1,125 - 6,125 available square feet contiguous
- Existing tenants include Subway, Legacy Nutrition, and Law Office
- Located next to Stonecreek Road and the intersection of LA 3276 (Stonewall Frierson Road) and Hwy. 171 (Mansfield Road)
- Less than 10 minutes from Shreveport and I-49
- Fast growing area
- Great location for retail, office, and medical
- Zoned SC - Commercial
- High visibility from Hwy. 171 (Mansfield Road) residents traveling to and from school, work, and shopping, etc.
- Shopping Center on the "going to" side of Shreveport makes perfect fit for breakfast stop, donut shops, day care and service providers

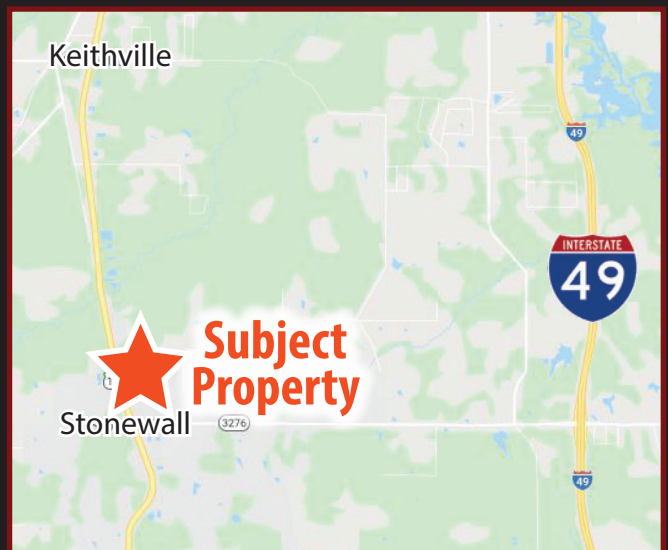

For more information, contact:

Brad Armstrong, Associate Broker | 318.222.2244

barmstrong@vintagerealty.com | vintagerealty.com

ALL INFORMATION CONTAINED HEREIN IS BELIEVED TO BE ACCURATE, BUT IS NOT WARRANTED AND NO LIABILITY OF ERRORS OR OMISSIONS IS ASSURED BY EITHER THE PROPERTY OWNER OR VINTAGE REALTY COMPANY OR ITS AGENTS AND EMPLOYEES. PRICES AS STATED HEREIN AND PRODUCT AVAILABILITY IS SUBJECT TO CHANGE AND/OR SALE OR LEASE WITHOUT PRIOR NOTICE, AND ALL SIZES AND DIMENSIONS ARE SUBJECT TO CORRECTION. REV 1/2021



STONEWALL OFFICE/RETAIL FOR LEASE

671 HIGHWAY 171
STONEWALL, LA 71078



For More Information Contact:

Brad Armstrong, Associate Broker | 318.222.2244

barmstrong@vintagerealty.com | vintagerealty.com

ALL INFORMATION CONTAINED HEREIN IS BELIEVED TO BE ACCURATE, BUT IS NOT WARRANTED AND NO LIABILITY OF ERRORS OR OMISSIONS IS ASSURED BY EITHER THE PROPERTY OWNER OR VINTAGE REALTY COMPANY OR ITS AGENTS AND EMPLOYEES. PRICES AS STATED HEREIN AND PRODUCT AVAILABILITY IS SUBJECT TO CHANGE AND/OR SALE OR LEASE WITHOUT PRIOR NOTICE, AND ALL SIZES AND DIMENSIONS ARE SUBJECT TO CORRECTION. 1/2021

STONEWALL OFFICE/RETAIL FOR LEASE

671 HIGHWAY 171
STONEWALL, LA 71078

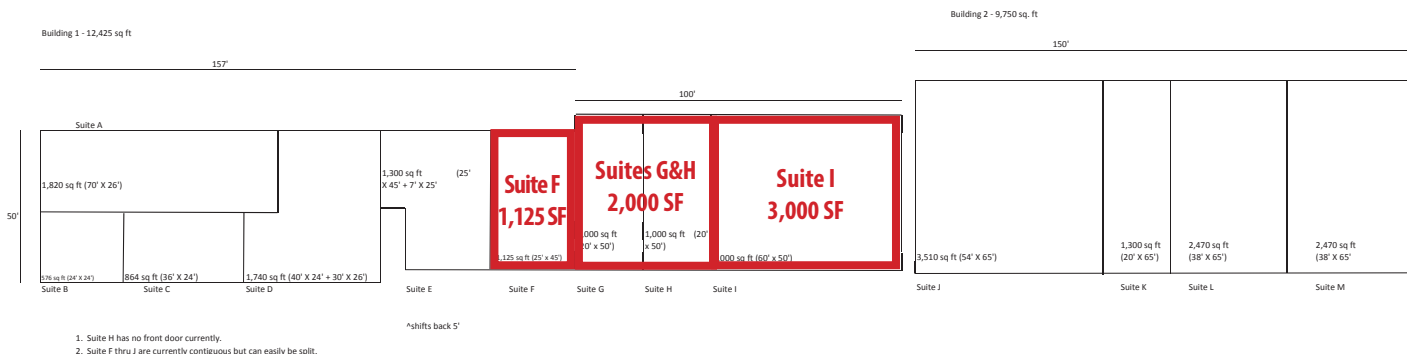

For More Information Contact:

Brad Armstrong, Associate Broker | 318.222.2244

barmstrong@vintagerealty.com | vintagerealty.com

ALL INFORMATION CONTAINED HEREIN IS BELIEVED TO BE ACCURATE, BUT IS NOT WARRANTED AND NO LIABILITY OF ERRORS OR OMISSIONS IS ASSURED BY EITHER THE PROPERTY OWNER OR VINTAGE REALTY COMPANY OR ITS AGENTS AND EMPLOYEES. PRICES AS STATED HEREIN AND PRODUCT AVAILABILITY IS SUBJECT TO CHANGE AND/OR SALE OR LEASE WITHOUT PRIOR NOTICE, AND ALL SIZES AND DIMENSIONS ARE SUBJECT TO CORRECTION. 1/2021

STONEWALL OFFICE/RETAIL FOR LEASE

671 HIGHWAY 171
STONEWALL, LA 71078

AVAILABLE SUITES

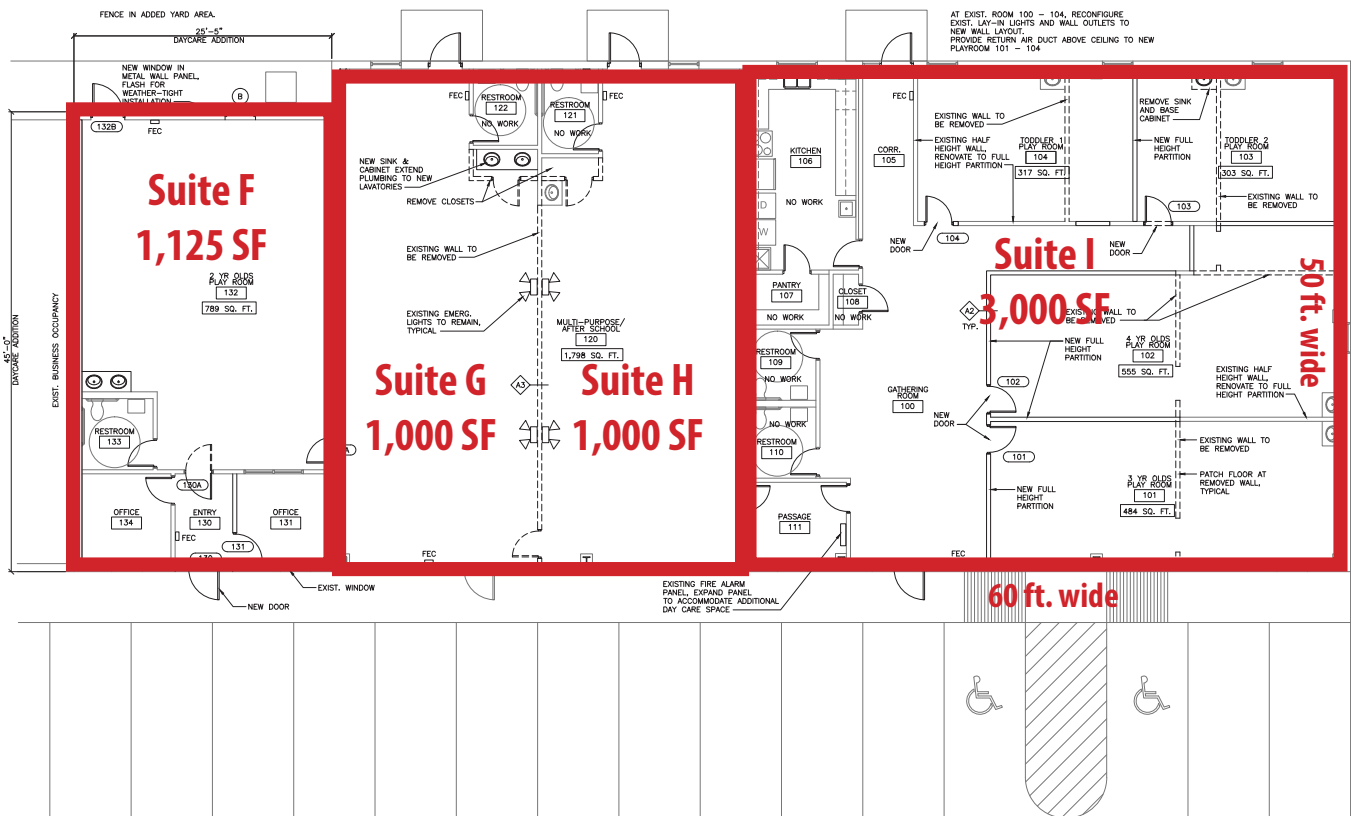

For More Information Contact:

Brad Armstrong, Associate Broker | 318.222.2244

barmstrong@vintagerealty.com | vintagerealty.com

ALL INFORMATION CONTAINED HEREIN IS BELIEVED TO BE ACCURATE, BUT IS NOT WARRANTED AND NO LIABILITY OF ERRORS OR OMISSIONS IS ASSURED BY EITHER THE PROPERTY OWNER OR VINTAGE REALTY COMPANY OR ITS AGENTS AND EMPLOYEES. PRICES AS STATED HEREIN AND PRODUCT AVAILABILITY IS SUBJECT TO CHANGE AND/OR SALE OR LEASE WITHOUT PRIOR NOTICE, AND ALL SIZES AND DIMENSIONS ARE SUBJECT TO CORRECTION. 1/2021