

# STOCK AND FIELD BUILDING



**MID-AMERICA<sup>®</sup>**  
Real Estate-Michigan, Inc.

340 E. Edgewood Blvd. / Lansing, MI

**ALL OFFERS WILL BE  
CONSIDERED!**



**RETAIL OPPORTUNITY**

# STOCK AND FIELD BUILDING



## Address

340 E. Edgewood Blvd  
Lansing, MI 48911

## Features

- Former Sam's Club recently renovated for Stock and Field.
- Freestanding building.
- Great retail box draw with Target, Menards, Meijer and Lowe's in the immediate area.

## Availability

137,454 SF  
10.59 Acres

## Area Tenants



## Demographics (2020)

	1MILE	3MILES	5MILES
POPULATION	8,401	67,264	118,708
HOUSEHOLDS	3,732	28,164	50,231
AVG HOUSEHOLD INCOME	\$51,189	\$62,651	\$61,239
DAYTIME POPULATION	8,707	63,605	127,577

# STOCK AND FIELD BUILDING

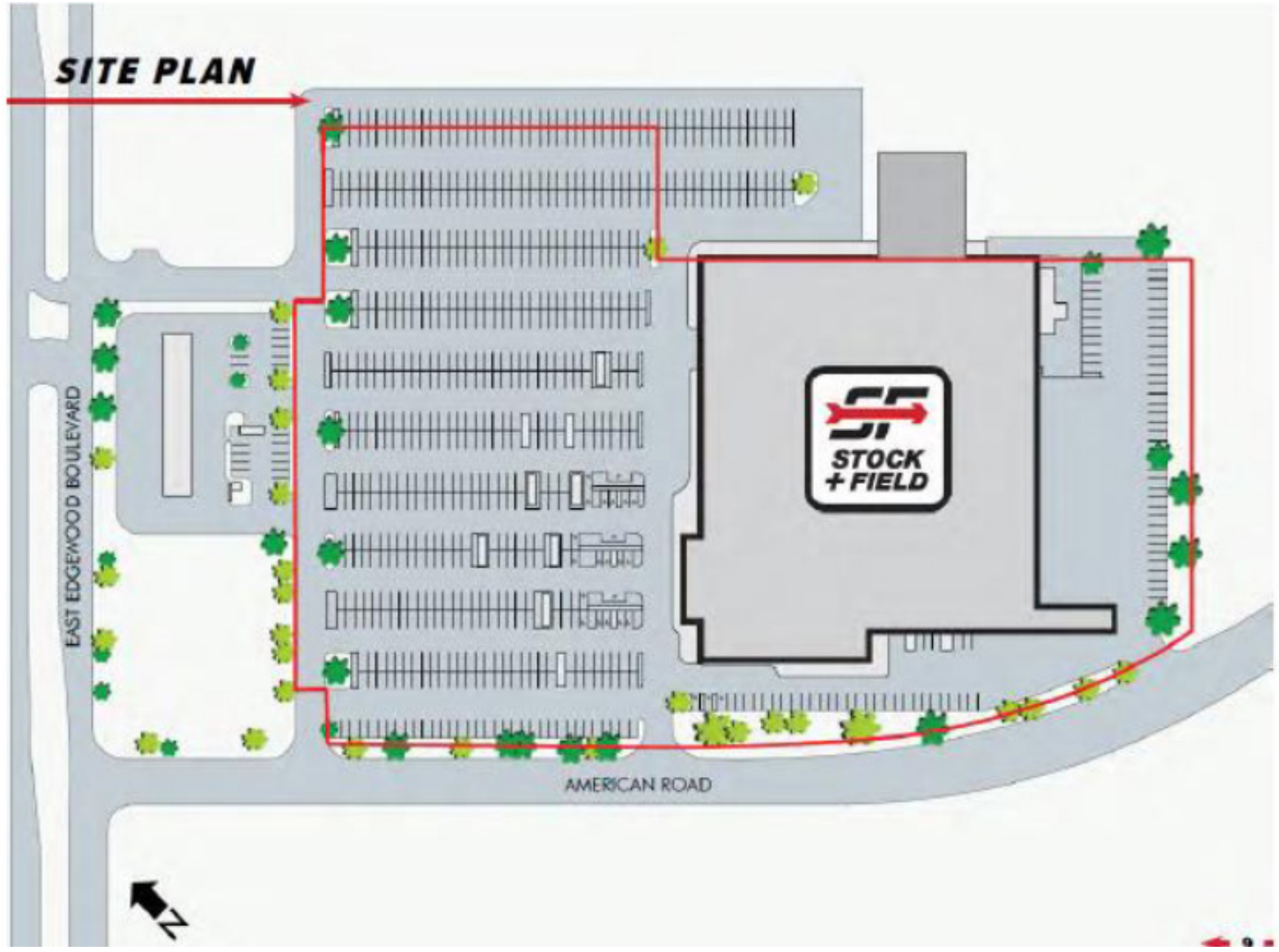

SITE PLAN

# STOCK AND FIELD BUILDING



AERIAL

# STOCK AND FIELD BUILDING



Tony  
Schmitt

Mid-America Real Estate -  
Michigan, Inc.  
T: 248.855.6800  
[TSchmitt@MidAmericaGrp.com](mailto:TSchmitt@MidAmericaGrp.com)

Matt  
Matlat

A&G Real Estate Partners  
T: 631.465.9508  
[mike@agrep.com](mailto:mike@agrep.com)



38500 Woodward Ave, Suite 100  
Bloomfield Hills, Michigan 48304  
248.855.6800  
[MidAmericaGrp.com](http://MidAmericaGrp.com)

Property offered in partnership with:

