



# 1008 HIGH RIDGE ROAD | STAMFORD, CT

## DEMOGRAPHICS

### POPULATION

1 mile: 6,970  
3 miles: 65,817  
5 miles: 180,128

### # HOUSEHOLDS

1 mile: 2,535  
3 miles: 25,229  
5 miles: 67,531

### AVG. HOUSEHOLD \$

1 mile: \$180,070  
3 miles: \$187,214  
5 miles: \$190,340



# AVAILABLE: 2,100 SF INLINE 2,700 SF END CAP

- Rare end cap opportunity in North Stamford's Primary Retail Corridor.
- 90+ Parking Spaces.

- Great presence and visibility on High Ridge Road.
- Located directly off the Merritt Parkway (RT. 15).
- Basement storage available.

**AREA RETAILERS:** Trader Joe's, CVS, Acme, DSW, AT&T, Massage Envy, Starbucks, Pet Valu, Five Guys, Verizon and many more.

## 30,000+ VPD

This information provided in this marketing package has been obtained from sources believed reliable, but has not been verified for accuracy or completeness. You should conduct a careful, independent investigation of the property and verify all information. Any reliance on this information is solely at your own risk.

## A TRUE EXCLUSIVE... CALL FOR THE DETAILS!

AGENTS:

**Jason Wuchiski**

203.529.6943 | [jw@truecre.com](mailto:jw@truecre.com)

**Ryan Stranko**

203.210.5057 | [ryan@truecre.com](mailto:ryan@truecre.com)







# 1008 HIGH RIDGE ROAD | STAMFORD, CT | FLOOR PLAN

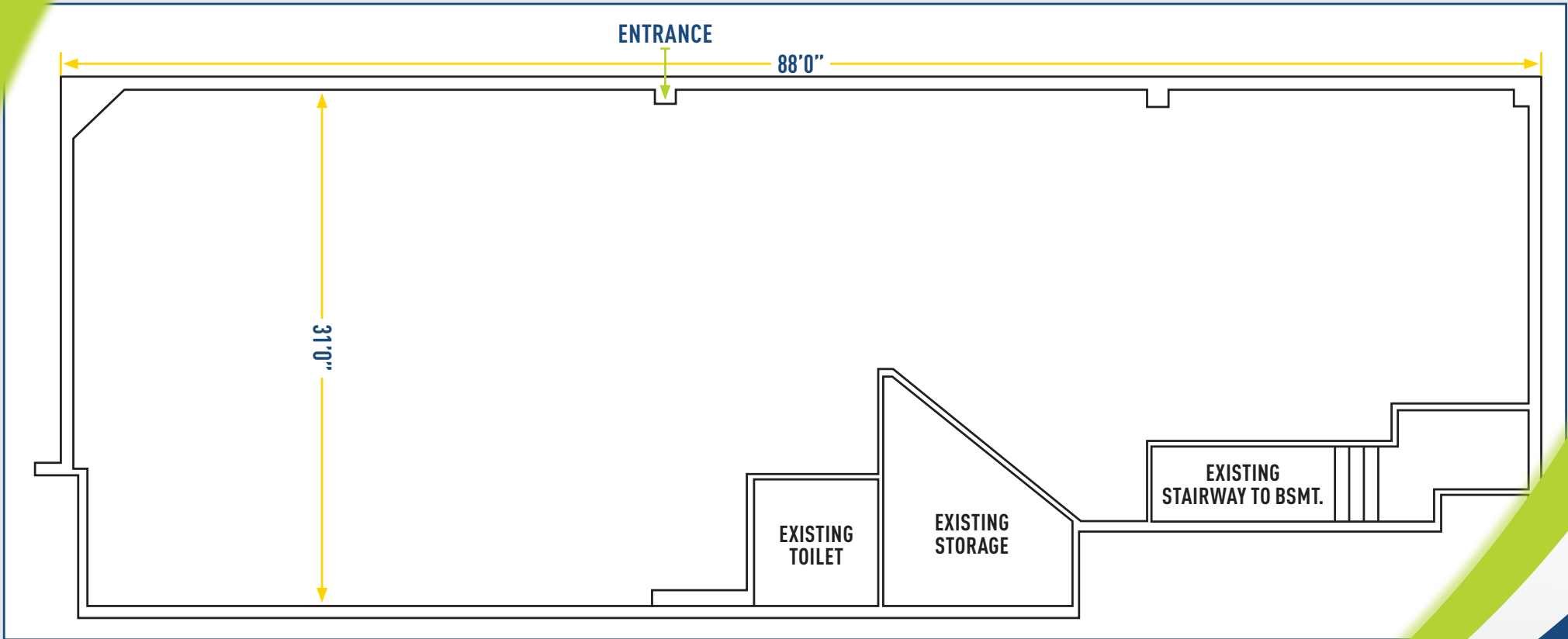

## 2,700 SF END CAP





# 1008 HIGH RIDGE ROAD | STAMFORD, CT | FLOOR PLAN

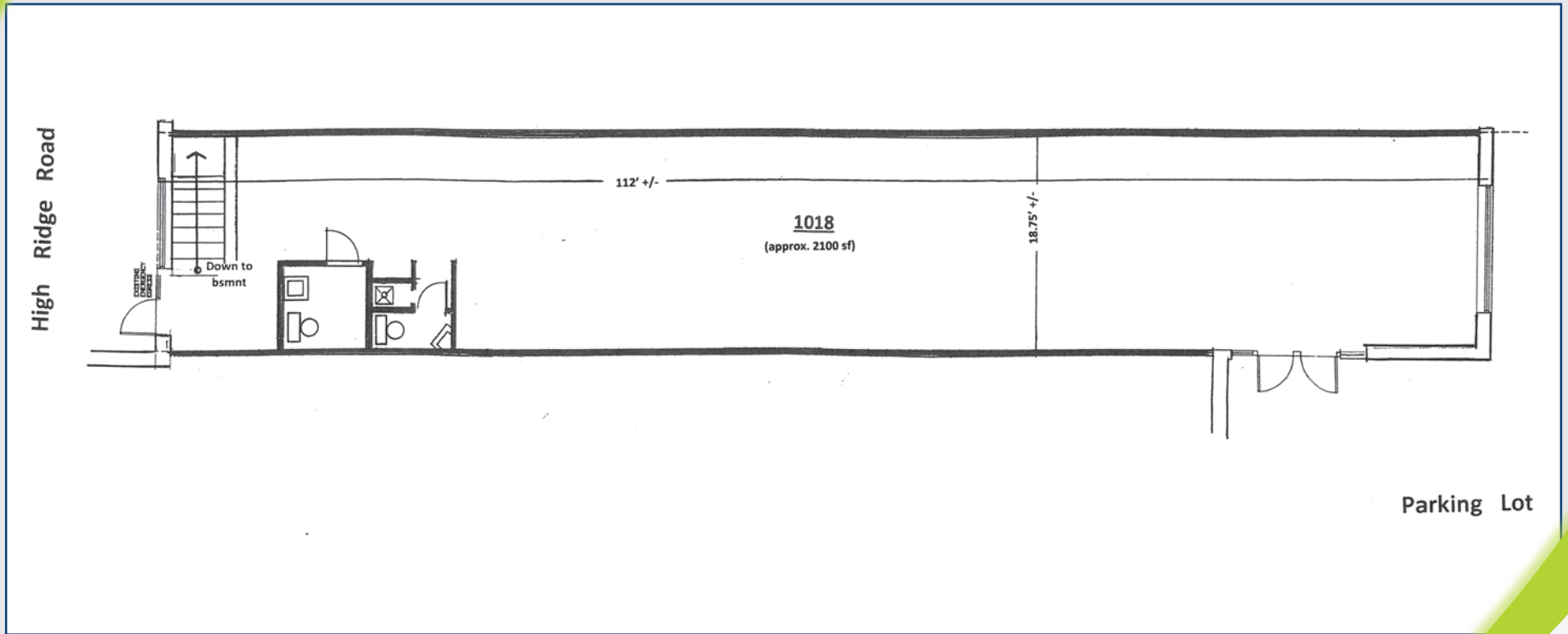

## 2,100 SF INLINE





# 1008 HIGH RIDGE ROAD | STAMFORD, CT | MARKET AERIAL

