

TOWNLINE SQUARE

NEC Lake St & Townline Rd / Mundelein, IL



MID-AMERICA[®]
Asset Management, Inc.

UP TO 16,660 SF AVAILABLE



Features

- Heavily trafficked intersection with over 63,000 VPD
- Strong daytime population (64,272 within 3 miles)
- Conveniently located in the heart of Mundelein

Co-Tenants



Demographics

	3 Miles	5 Miles	7 Miles
POPULATION	67,010	123,759	236,840
HOUSEHOLDS	24,028	44,331	87,576
AVG HOUSEHOLD INCOME	\$142,081	\$162,049	\$154,439
DAYTIME POPULATION	66,818	139,802	264,672

RETAIL OPPORTUNITY

TOWNLINE SQUARE



Suite	Tenant	SF
150	Jewel-Osco	62,022
1505	Dollar Tree	10,366
1511A	Available	2,605
1511B	Available	10,702
1515	Salon G	1,081
1515B	Available	1,048
1517	Available	1,149
1519-1521	Help at Home	3,292
1523	Lee Nails	1,198
1527	H&R Block	1,597
1529	Orthodontic Experts	2,396
1531-1533B	Goldfish Swim School	8,000
1535	Galleria Dental	1,746
1539	Available	4,248
1543-1553	Available	16,660
Outlot 1-2	LA Fitness	
Outlot 3A	Chipotle	
Outlot 3B	Tenant	
Outlot 4	Panera	± 0.75 Acres
Outlot 5	O'Reilly Auto Parts	5,000
Total GLA		128,095

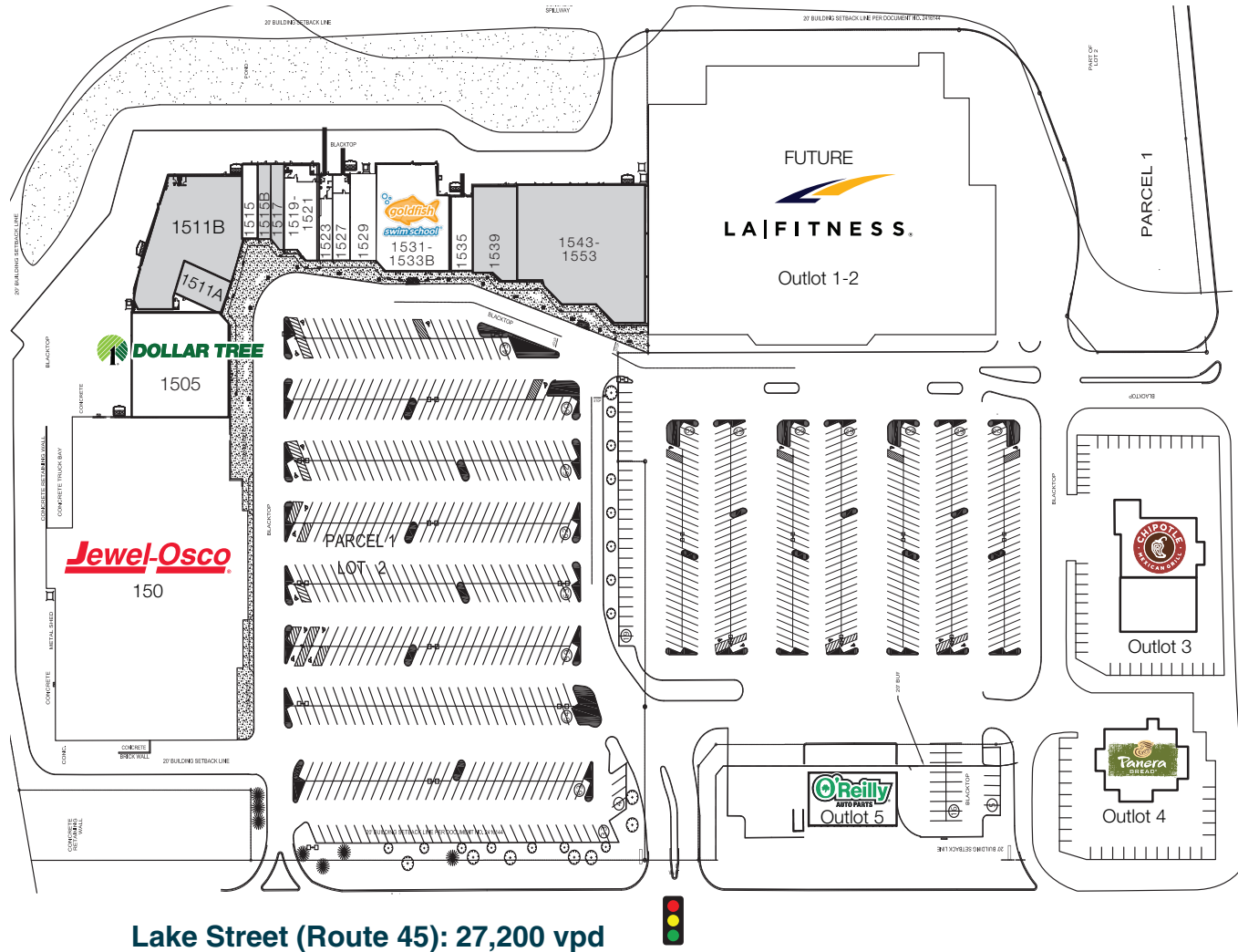

Lake Street (Route 45): 27,200 vpd

Townline Square (Route 60): 37,900 vpd

SITE PLAN

TOWNLINE SQUARE



TOWNLINE SQUARE



April
Smith

T: 630.954.7451

F: 630.954.7304

ASmith@MidAmericaGrp.com

Elizabeth
Sweeney

T: 630.954.7358

F: 630.954.7304

ESweeney@MidAmericaGrp.com



One Parkview Plaza, 9th Floor
Oakbrook Terrace, Illinois 60181
630.954.7300

MidAmericaGrp.com

CONTACT