



Property Highlights

- Close proximity to Phoenix Children's Hospital
- Fantastic infill location on heavily trafficked
- Can Build-to-Suit, Ground Lease, or Sell
- Additional parking for restaurant

Area Co-Tenants



Contact

JASON FESSINGER 602.368.1090
jfessinger@w-retail.com

KALEN RICKARD 602.931.4492
krickard@w-retail.com

For Lease or Build to Suit

West Northwest Corner Thomas Road & 24th Street | Phoenix, Arizona

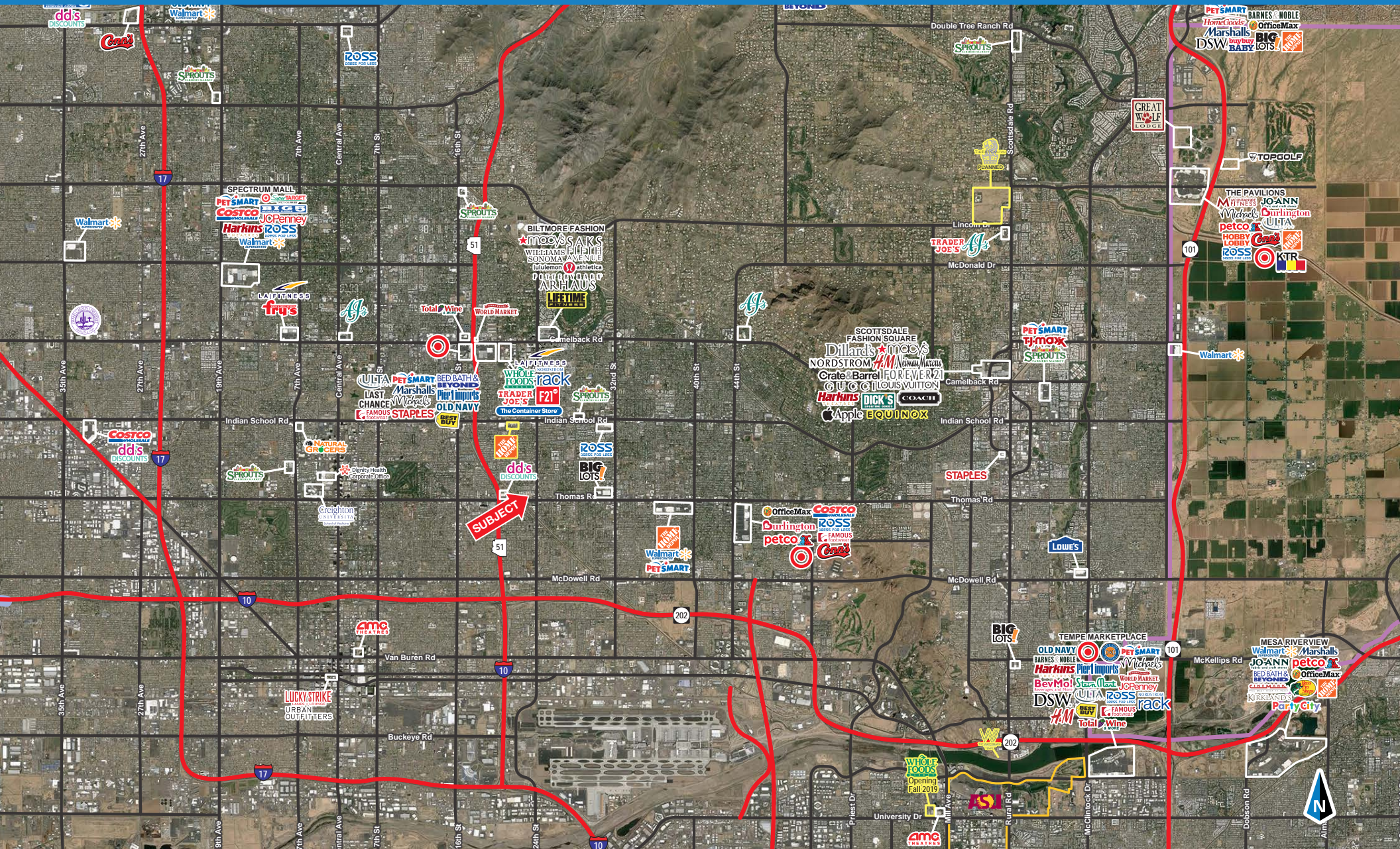

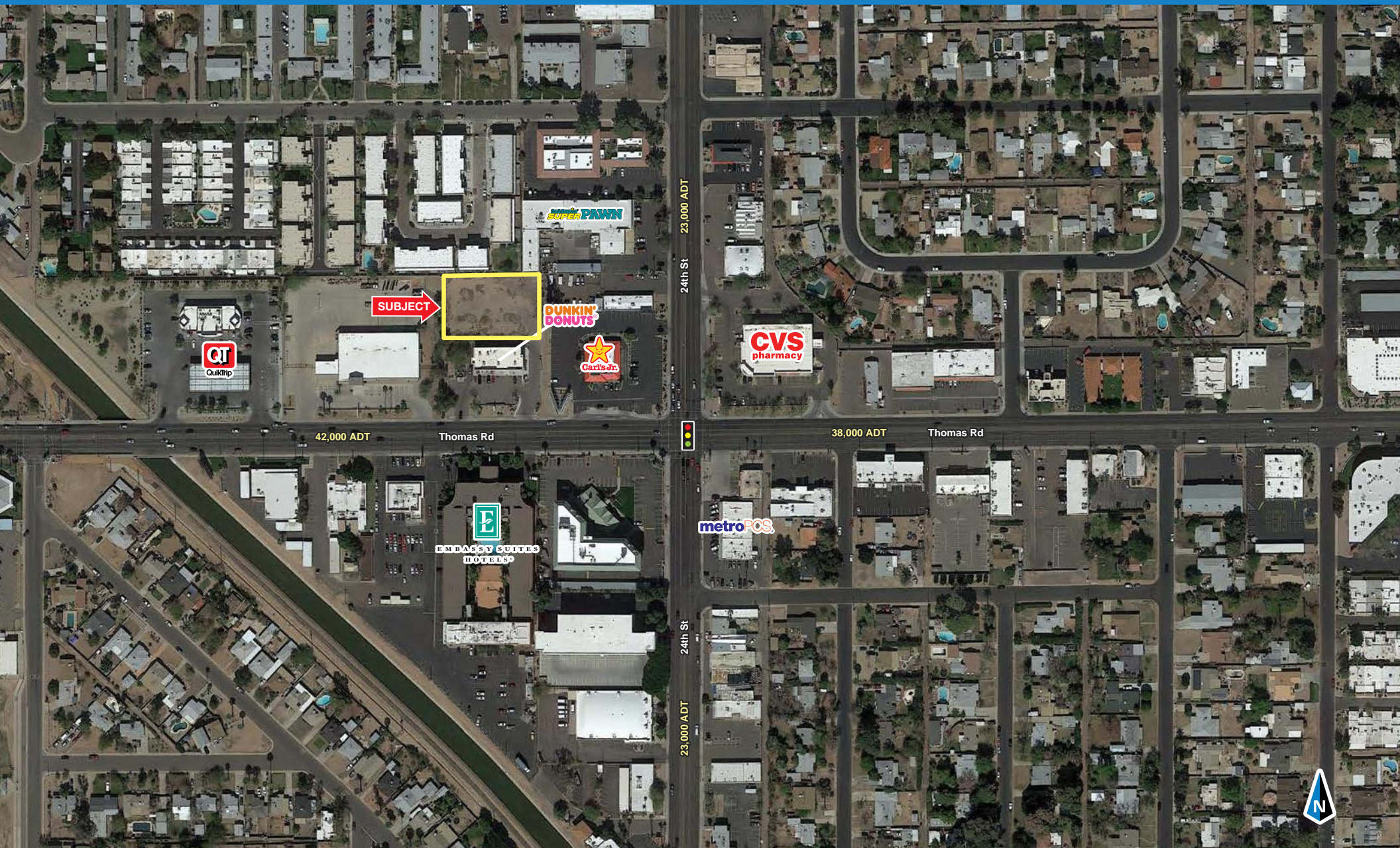

	1 miles	3 miles	5 miles
POPULATION SUMMARY			
2018 Total Population	25,236	170,457	319,810
2023 Total Population	26,586	185,133	459,243
2018-2023 Annual Growth Rate	1.05%	1.67%	1.56%
2018 Median Age	31.5	33.6	34.9
INCOME SUMMARY			
Median Household Income	\$34,327	\$41,496	\$43,690
Average Household Income	\$46,958	\$62,393	\$70,003
BUSINESS DATA			
Total Businesses:	926	10,606	20,110
Total Employees:	12,983	158,415	344,580
Daytime Population:	26,524	247,161	513,276
POPULATION 25+ BY EDUCATIONAL ATTAINMENT			
Associate Degree	5.2%	6.3%	6.7%
Bachelor's Degree	15.3%	20.3%	20.5%
Graduate/Professional Degree	6.3%	11.0%	13.2%
Percent of Population with Degrees	26.8%	37.6%	40.4%
EMPLOYED POPULATION 16+ BY OCCUPATION			
Total	11,693	81,713	151,113
White Collar	44.7%	55.5%	59.4%
Services	33.1%	25.5%	22.8%
Blue Collar	22.1%	19.1%	17.8%
HOUSEHOLD SUMMARY			
2018 Households	8,309	69,210	130,893
2018 Average Household Size	3.01	2.40	2.37
2018 Average Family Size	3.89	3.47	3.38
2018 Median Home Value	\$169,942	\$219,571	\$246,912