

Greenhouse Square

16040—16220 SE 82nd Ave, Clackamas, OR 97015

View
Online:

Greenhouse Square is a high traffic neighborhood center shadow anchored by Fred Meyer on Old 82nd Ave. Located just off of I-205 this shopping center is easily accessible and serves a broad trade area. This center has a great Tenant mix with neighbors including Dollar Tree, Black Rock Coffee, Wendy's, Gluten Free bakery and many others. Building signage and monument signage are available.



Available:

Suite 16060—3,700 SF*Divisible to approx. 1,200 SF***Suite 16110—5,244 SF****Suite 16140—1,475 SF*****Do Not Disturb Tenant, Available 6/1/2021***\$20.00 SF/Year, NNN**

ADT (2015/2016)

82nd Ave—16,135**Hwy 212—47,500**

Demographics

	1 Mile	3 Mile	5 Mile
Population:	7,934	83,198	217,662
Average HH Income:	\$69,029	\$85,926	\$92,402

**503.675.0900 | Ashley Rhea or Craig Barnard****Email: ashley@barnardcommercial.com or craig@barnardcommercial.com****www.barnardcommercial.com | Mail: 6650 Redwood Lane, Suite 330, Portland OR 97224**

Greenhouse Square

Suite	Tenant	GLA sq. ft.
16050	Boat Co. NW	2,949
16052	My Gym Children's Fitness Ctr.	3,112
16054	Golden Dragon Foot Spa	963
16056	Lighthouse Fish & Chips	1,916
16058	NW Lice Centers, Inc.	868
16060	Available	3,700
16068	Farmers Insurance	670
16080	Lighthouse	2,148
16100	Liberated Bakino	4,000
16110	Available	5,244
16112	Arthur Murray Dance Studio	5,063
16116	Impact Jiu Jitsu	4,038
16120	Cosmic Vapor Lounge	1,280
16122	Great American Tackle Shop	1,270
16132	Akira Sushi	2,855
16136	Remedy Salon	1,067
16138	Black Rock Coffee	540
16140	Available	1,475
16142	D.L.C. Liquor Store	2,555
16144	O.C. Nails	1,319
16152	Swiss Denture Center	1,150
16180	Metro PCS	982
16184	New Cathay Restaurant	3,150
16186	Mudpuppies Grooming	1,663
16190	Salon Centric/Maly's West	3,312
16200	Dollar Tree #5032	12,763

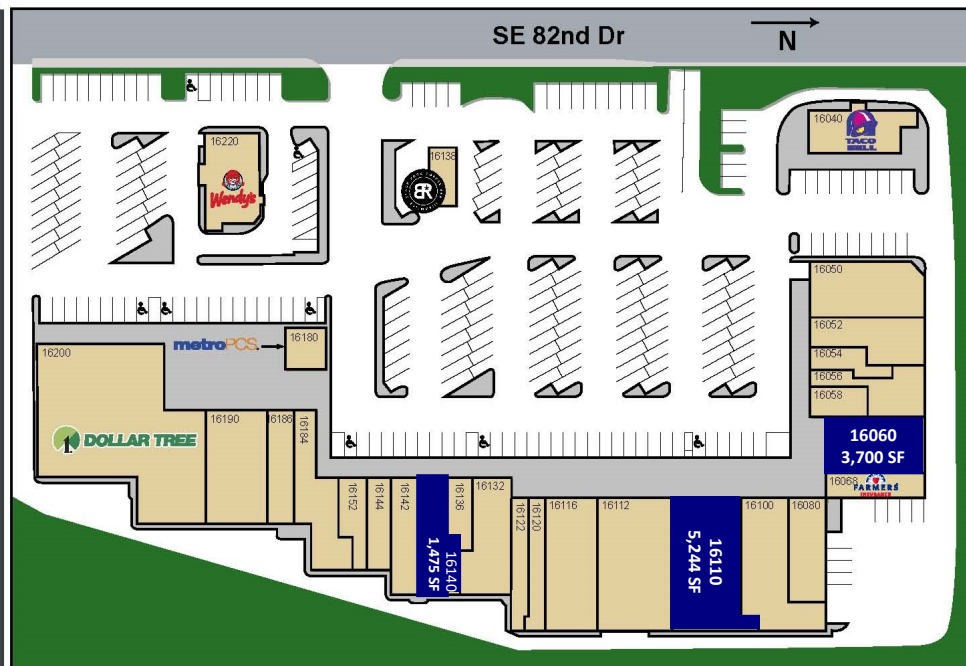

503.675.0900 | Ashley Rhea or Craig Barnard

Email: ashley@barnardcommercial.com or craig@barnardcommercial.comwww.barnardcommercial.com | Mail: 6650 Redwood Lane, Suite 330, Portland OR 97224

Greenhouse Square



Suite 16110—5,244 SF



Two restrooms



Back of the building access

503.675.0900 | Ashley Rhea or Craig Barnard
Email: ashley@barnardcommercial.com or craig@barnardcommercial.com
www.barnardcommercial.com | Mail: 6650 Redwood Lane, Suite 330, Portland OR 97224