

FOR LEASE

**MEDICAL OFFICE
OR OFFICE**



9760 HOLLY SPRINGS



9760 Holly Springs Road
Apex, NC 27539

PROPERTY HIGHLIGHTS

- » Medical / professional office building built in 2016
- » Building and monument signage available
- » 4:1000 parking ratio
- » Desirable location fronting the area's main thoroughfare
- » Desirable location fronting the area's main thoroughfare. Future 540 ramp will be approximately a half mile from the property



AVAILABILITIES

SUITE 9760 - 3,380 SF
Second generation

SUITE 9768 - 1,347 SF
In shell condition

**RENTAL RATE \$21.00 PSF, NNN
TICAM \$3.26**

CONTACT:

Sam DiFranco, Jr. | 919.674.3699 | sdifrancojr@trinity-partners.com
Dylan Heafner | 919.415.4394 | dheafner@trinity-partners.com

**TRINITY
PARTNERS**
trinity-partners.com

9760
HOLLY SPRINGS

sunset lake boulevard
eisenhower drive

CVS
pharmacy

SUBWAY

holly springs road

9760
HOLLY SPRINGS

SUNSET LAKE COMMONS

Harris Teeter
Your Neighborhood Food Market

WELLS FARGO

ANYTIME FITNESS
Get to a healthier place.

HOLLY SPRINGS TOWNE CENTER
3.8 MILES

TARGET

ZAXBY'S

Olive Garden
Italian Restaurant

chili's

Bank of America

Michaels
Where Creativity Happens

DICK'S
SPORTING GOODS

WILD WINGS

STARBUCKS
COFFEE

ULTA
BEAUTY

Orangetheory
FITNESS

DOLLAR TREE

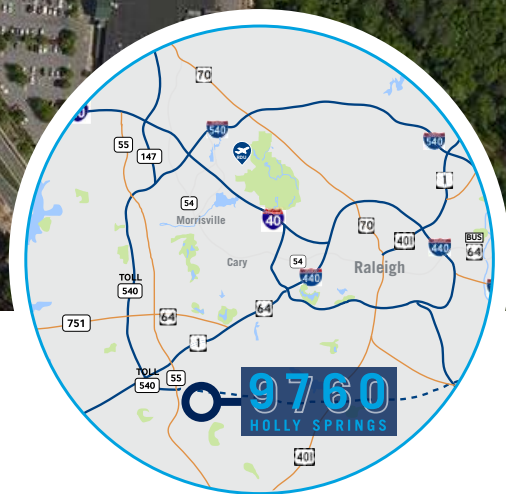

FLOOR PLAN

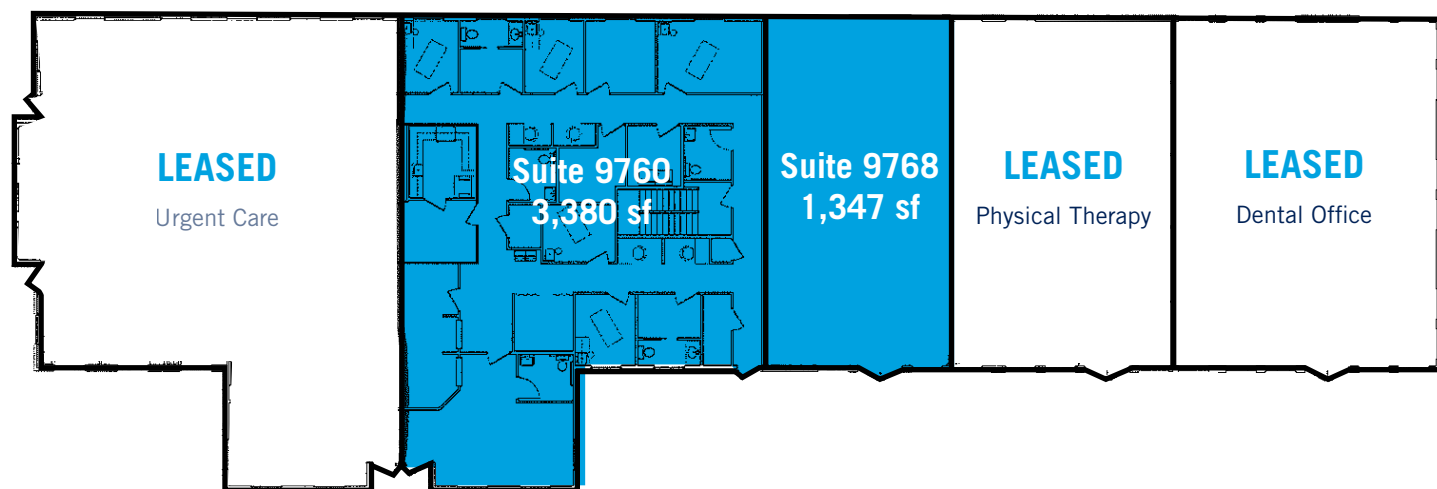

The information contained herein was obtained from sources believed reliable; however, Trinity Partners makes no guarantees, warranties, or representations as to the completeness or accuracy thereof. The presentation of this property is submitted subject to errors, omissions, changes of price or conditions prior to sale or lease, or withdrawal without notice.

CONTACT:

Sam DiFranco, Jr. | 919.674.3699 | sdifrancojr@trinity-partners.com
Dylan Heafner | 919.415.4394 | dheafner@trinity-partners.com

TRINITY
PARTNERS
trinity-partners.com