

1360 E. 9th St.

# IMG CENTER

Historic Erieview District



FOR MORE INFORMATION CONTACT:

David C. Wagner

216.839.2002

[davidwagner@hannacre.com](mailto:davidwagner@hannacre.com)

William P. Nice, Jr., AARE, SIOR

216.839.2010

[billnice@hannacre.com](mailto:billnice@hannacre.com)

Anthony DiLallo

216.839.2035

[anthonydilallo@hannacre.com](mailto:anthonydilallo@hannacre.com)

# SUITE PHOTOS



# BUILDING OVERVIEW



---

*The IMG building is an iconic Cleveland landmark defining the corner of E.9th Street and St. Clair Avenue.*

---

---

*Many great amenities within walking distance: from Sweetwater Café & Anna in the Raw in the building; the Westin Hotel, Starbucks, & Urban Farmer; to the Rock Hall and dozens of great hotels and restaurants.*

---

---

*With widespread windows lining floor to ceiling, the IMG building is notable for its incredible views of Downtown Cleveland and Lake Erie.*

---

---

*Building has new dynamic Leadership with motivation and capital to make new transaction at the tower.*

---

---

*Built out market ready spaces and wide open floor plans are ready for deals occupancy this spring.*

---



# FLOORPLAN | 7TH FLOOR

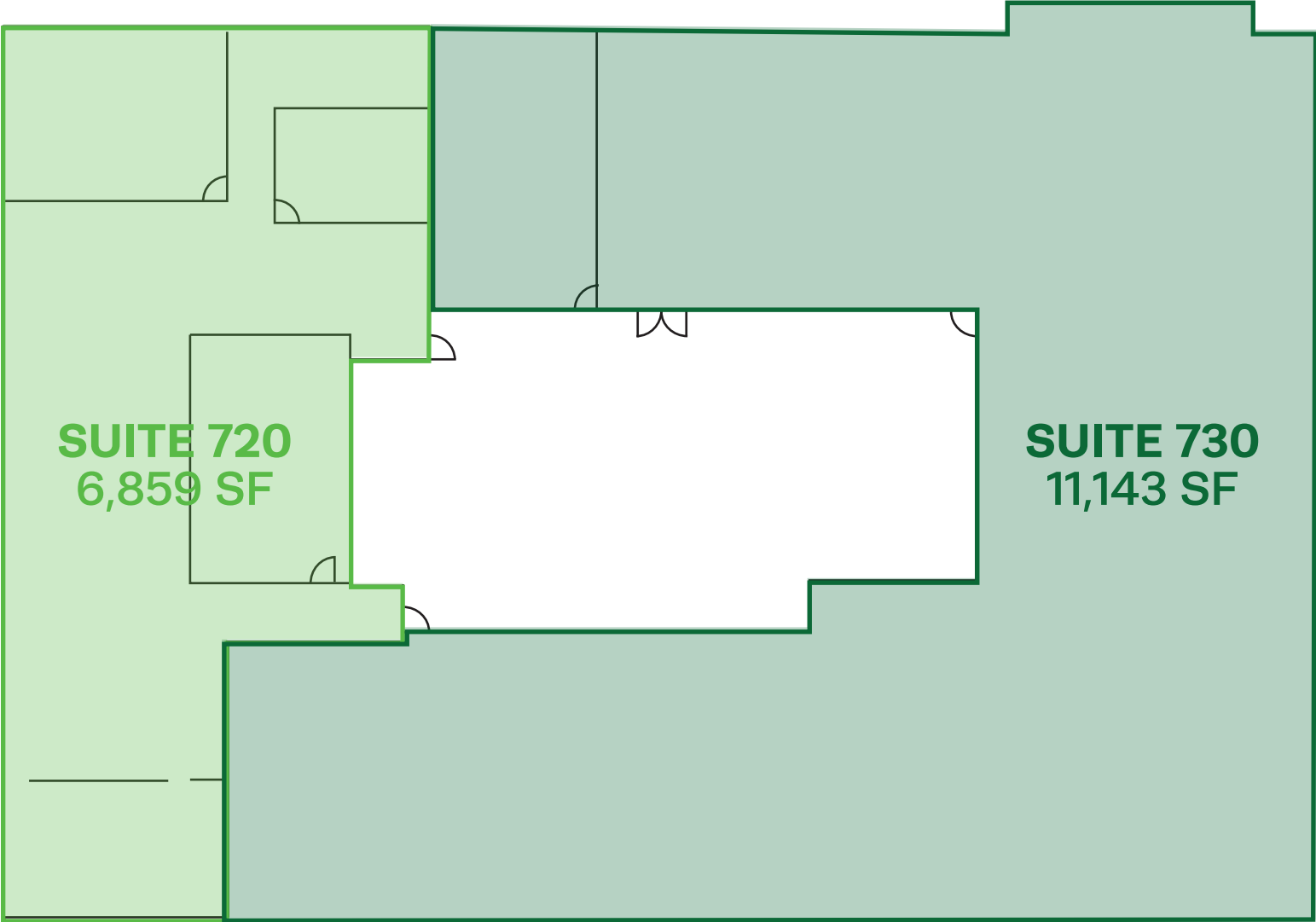

**SUITE 720**  
6,859 SF

**SUITE 730**  
11,143 SF

# FLOORPLAN | 8TH FLOOR

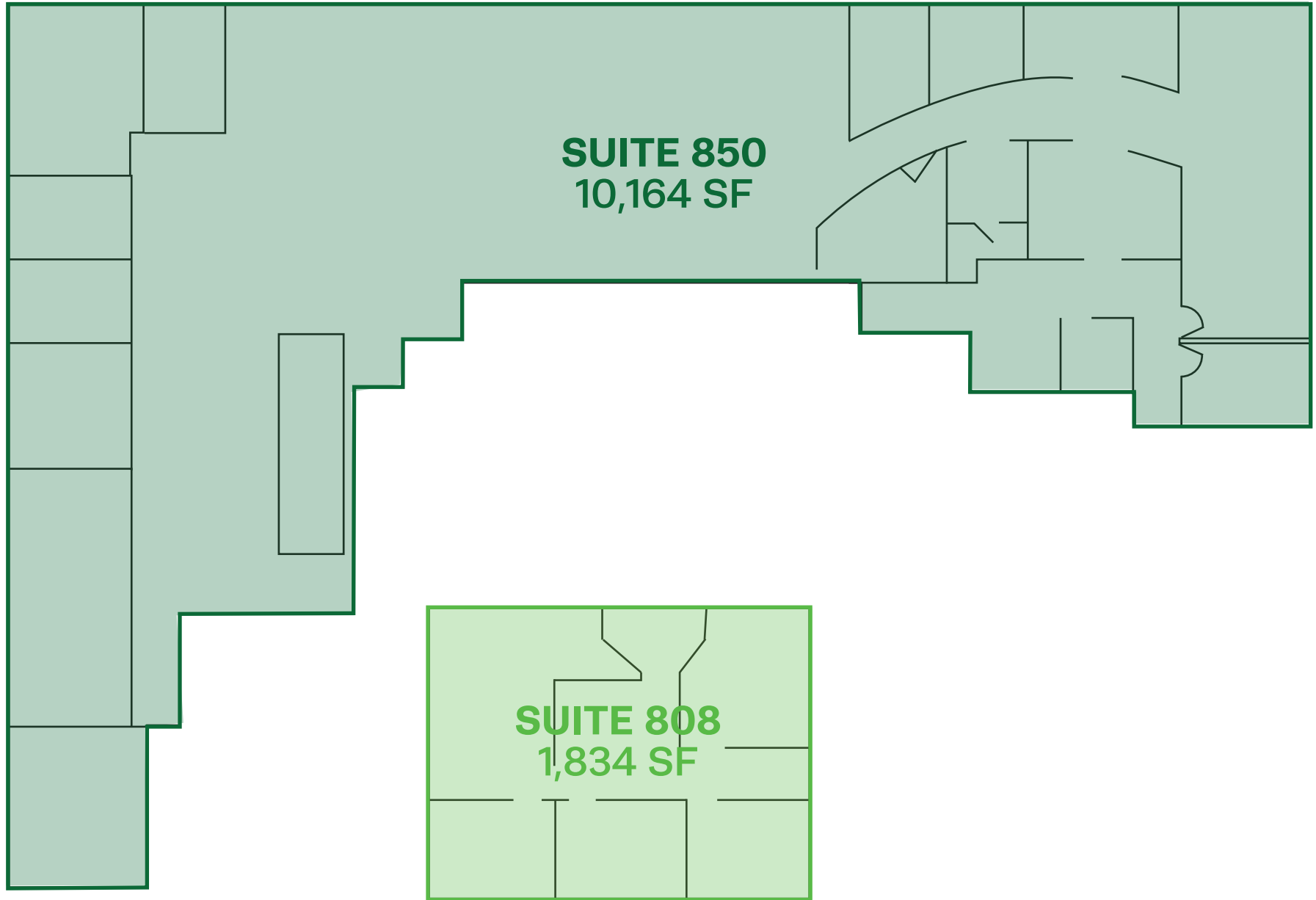

# FLOORPLAN | 9TH FLOOR

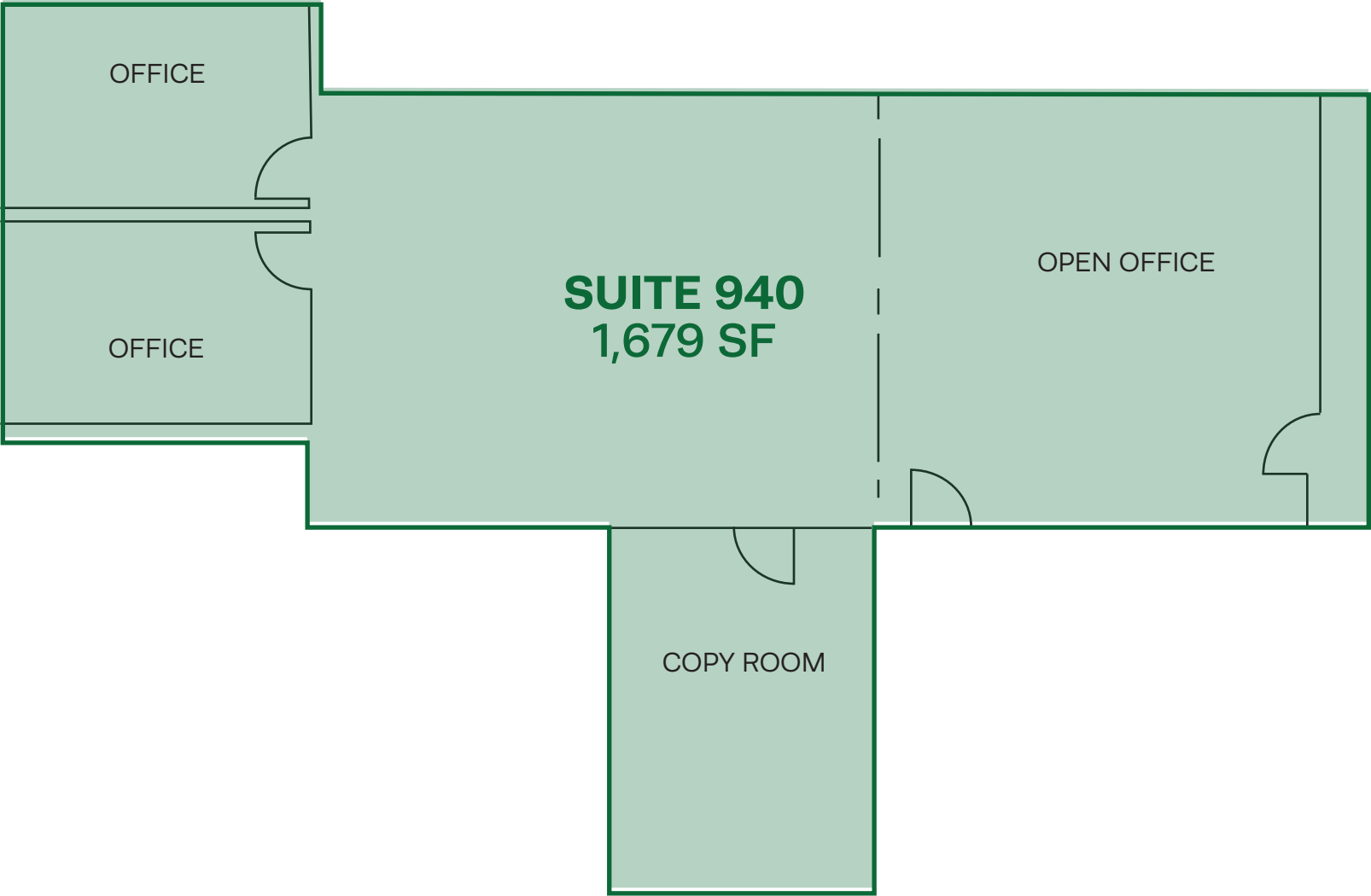

# FLOORPLAN | 10TH FLOOR

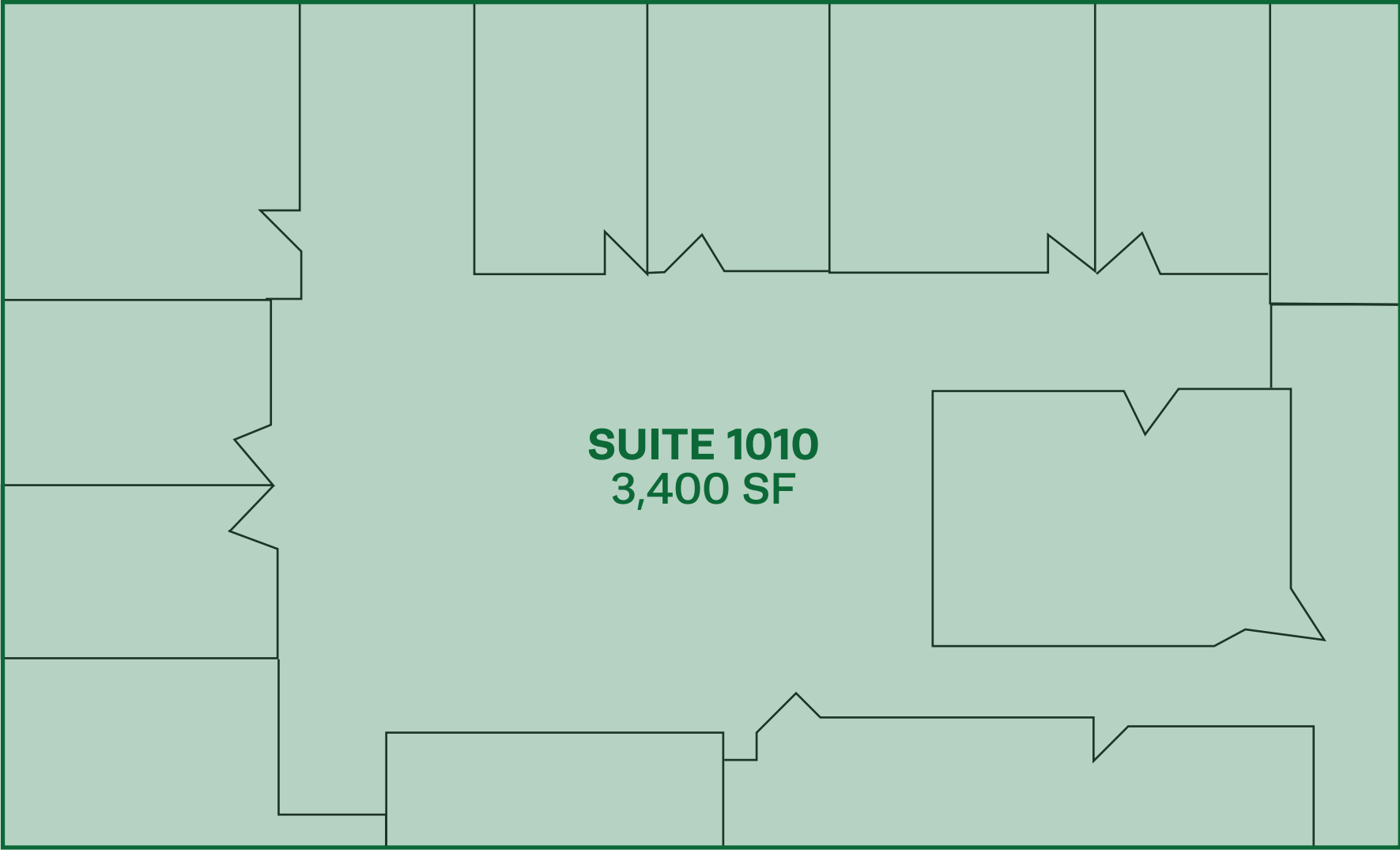

# AERIAL



Cleveland, Ohio  
Downtown



FOR MORE INFORMATION CONTACT:

David C. Wagner

216.839.2002

davidwagner@hannacre.com

William P. Nice, Jr., AARE, SIOR

216.839.2010

billnice@hannacre.com

Anthony DiLallo

216.839.2035

anthonydilallo@hannacre.com

The information submitted herein is not guaranteed. Although obtained from reliable resources, it is subject to errors, omissions, prior sale and withdrawal from the market without notice. Broker has made no investigation and makes no representation of the property.

1360 E. 9th St.

**IMG CENTER**

Historic Erieview District