

5151 NW 165th Street, Miami, FL 33014

\$5,544,450.00



OFFERING SUMMARY

Building Size:	36,963 SF
Lot Size:	2.76 Acres
Price / SF:	\$150.00
Year Built:	1975
Zoning:	I-2 Industrial
Ceiling Height(s):	12'-19'
Loading Positions:	8
Cooler (35°F):	6,500 SF
Freezer (0°F) (400+ Racked Pallet Spaces)	7,500 SF
Power (3PH):	4,600+ AMPS

PROPERTY OVERVIEW

Opportunity Zone - Miami-Dade county centrally located cooler/freezer building ideal for perishable distributors.

PROPERTY HIGHLIGHTS

- Opportunity zone location
- Fully fenced & secured
- Ingress/Egress from two sides of property
- Ample Parking, yard accommodates trailers up to 53'
- All new Freon condensers and evaporators
- Oversized lot may allow for building expansion
- Roof replacement scheduled - Owner awaiting permits now

Lawrence Oxenberg
Sales Associate
954.652.2017
loxenberg@bergercommercial.com

Jonathan Thiel
Senior Sales Associate
954.652.2020
jthiel@bergercommercial.com

Main Office
550 S. Andrews Avenue Suite 400
Ft. Lauderdale, FL 33301
954.358.0900

Palm Beach County Office
2240 Woolbright Road, Suite 300
Boynton Beach, FL 33426
561.613.0900

5151 NW 165th Street, Miami, FL 33014

Site Layout

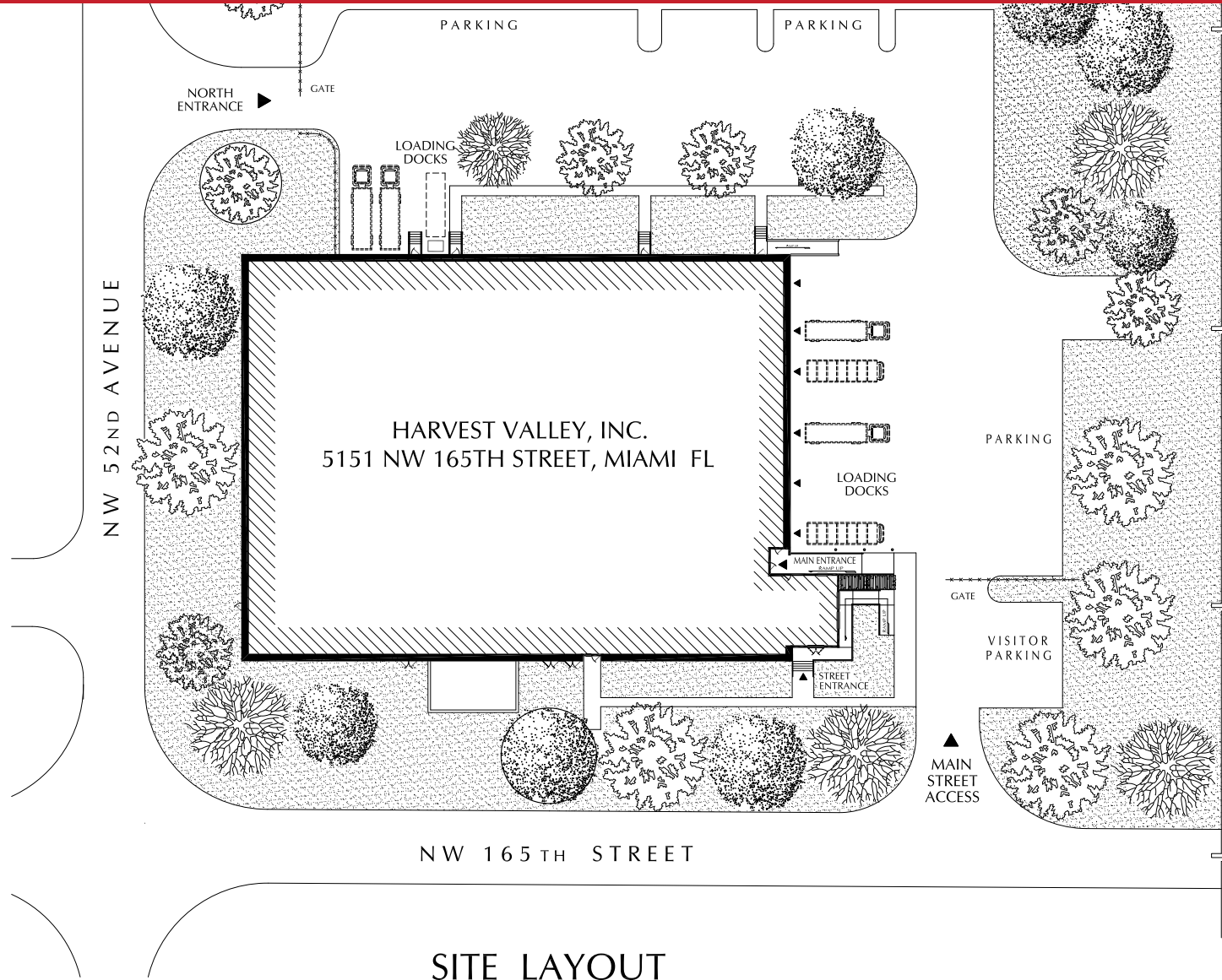

DRAWING NOT INTENDED TO BE SCALED - FOR LAYOUT INFORMATION ONLY - SITE DIMENSIONS TO BE FIELD VERIFIED

SITE LAYOUT

Lawrence Oxenberg
Sales Associate
954.652.2017
loxenberg@bergercommercial.com

Jonathan Thiel
Senior Sales Associate
954.652.2020
jthiel@bergercommercial.com

Main Office
550 S. Andrews Avenue Suite 400
Ft. Lauderdale, FL 33301
954.358.0900

Palm Beach County Office
2240 Woolbright Road, Suite 300
Boynton Beach, FL 33426
561.613.0900

5151 NW 165th Street, Miami, FL 33014

Current Floorplan



Lawrence Oxenberg
Sales Associate
954.652.2017
loxenberg@bergercommercial.com

Jonathan Thiel
Senior Sales Associate
954.652.2020
jthiel@bergercommercial.com

Main Office
550 S. Andrews Avenue Suite 400
Ft. Lauderdale, FL 33301
954.358.0900

Palm Beach County Office
2240 Woolbright Road, Suite 300
Boynton Beach, FL 33426
561.613.0900

5151 NW 165th Street, Miami, FL 33014

Property Boundary & Access



Lawrence Oxenberg
Sales Associate
954.652.2017
loxenberg@bergercommercial.com

bergercommercial.com

Jonathan Thiel
Senior Sales Associate
954.652.2020
jthiel@bergercommercial.com

Main Office
550 S. Andrews Avenue Suite 400
Ft. Lauderdale, FL 33301
954.358.0900

Palm Beach County Office
2240 Woolbright Road, Suite 300
Boynton Beach, FL 33426
561.613.0900

5151 NW 165th Street, Miami, FL 33014

Regional Map

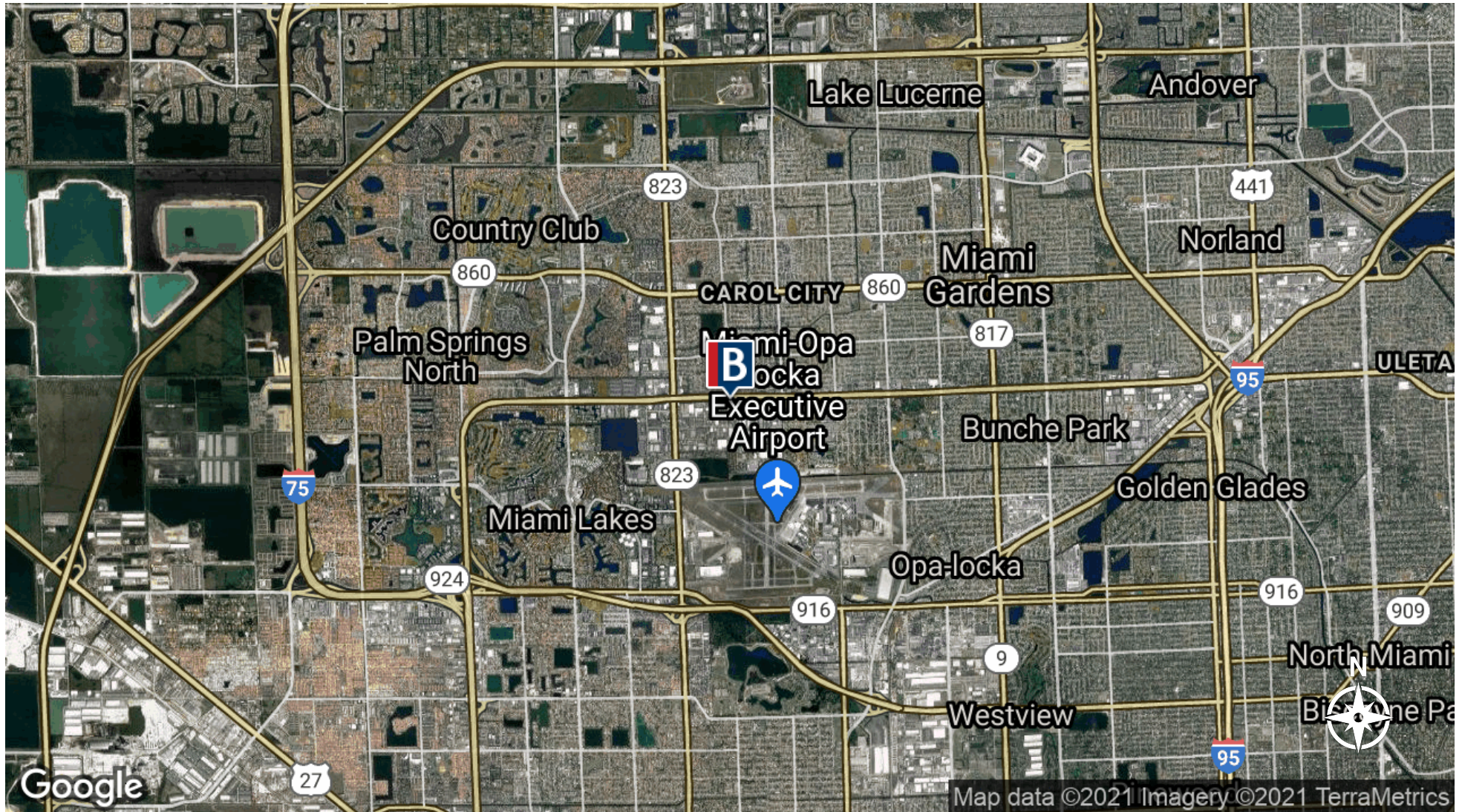

Lawrence Oxenberg
Sales Associate
954.652.2017
loxenberg@bergercommercial.com

Jonathan Thiel
Senior Sales Associate
954.652.2020
jthiel@bergercommercial.com

Main Office
550 S. Andrews Avenue Suite 400
Ft. Lauderdale, FL 33301
954.358.0900

Palm Beach County Office
2240 Woolbright Road, Suite 300
Boynton Beach, FL 33426
561.613.0900

5151 NW 165th Street, Miami, FL 33014

Map



Lawrence Oxenberg
Sales Associate
954.652.2017
loxenberg@bergercommercial.com

Jonathan Thiel
Senior Sales Associate
954.652.2020
jthiel@bergercommercial.com

Main Office
550 S. Andrews Avenue Suite 400
Ft. Lauderdale, FL 33301
954.358.0900

Palm Beach County Office
2240 Woolbright Road, Suite 300
Boynton Beach, FL 33426
561.613.0900