



OFFICE SPACE FOR LEASE 500 WOODRUFF

500-510 W. Woodruff Avenue | Idaho Falls, ID 83401

COMMERCIAL



GREAT LOCATION ON WOODRUFF AVE

FOR LEASE | 2,001 - 2,450 SF

PROPERTY INFORMATION

Submarket:	North Idaho Falls	Parking:	4.8/1,000
Bldg Type:	Office	Available:	Immediately
Bldg Size:	15,804 SF	Lease Type:	NNN

AVAILABLE SPACE

SPACE	RSF	RATE
Suite 500	2,450 SF	Contact Agent for Lease Rates
Suite 502	2,001 SF	

CONTACT

Brent Wilson, CLS

✉ brent@tokcommercial.com

Brian Wilson

✉ brian@tokcommercial.com

208.227.8148

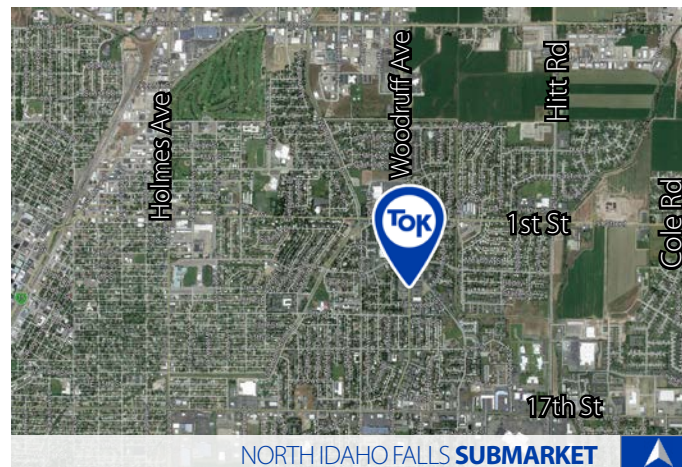

NORTH IDAHO FALLS SUBMARKET

LISTING COMMENTS

High-end office suite near major employers.

Great street visibility at the intersection of Woodruff & John Adams.

Tenant Improvements negotiable.

Contact agent for lease rates.



OFFICE SPACE FOR LEASE 500 WOODRUFF

500-510 W. Woodruff Avenue | Idaho Falls, ID 83401

COMMERCIAL

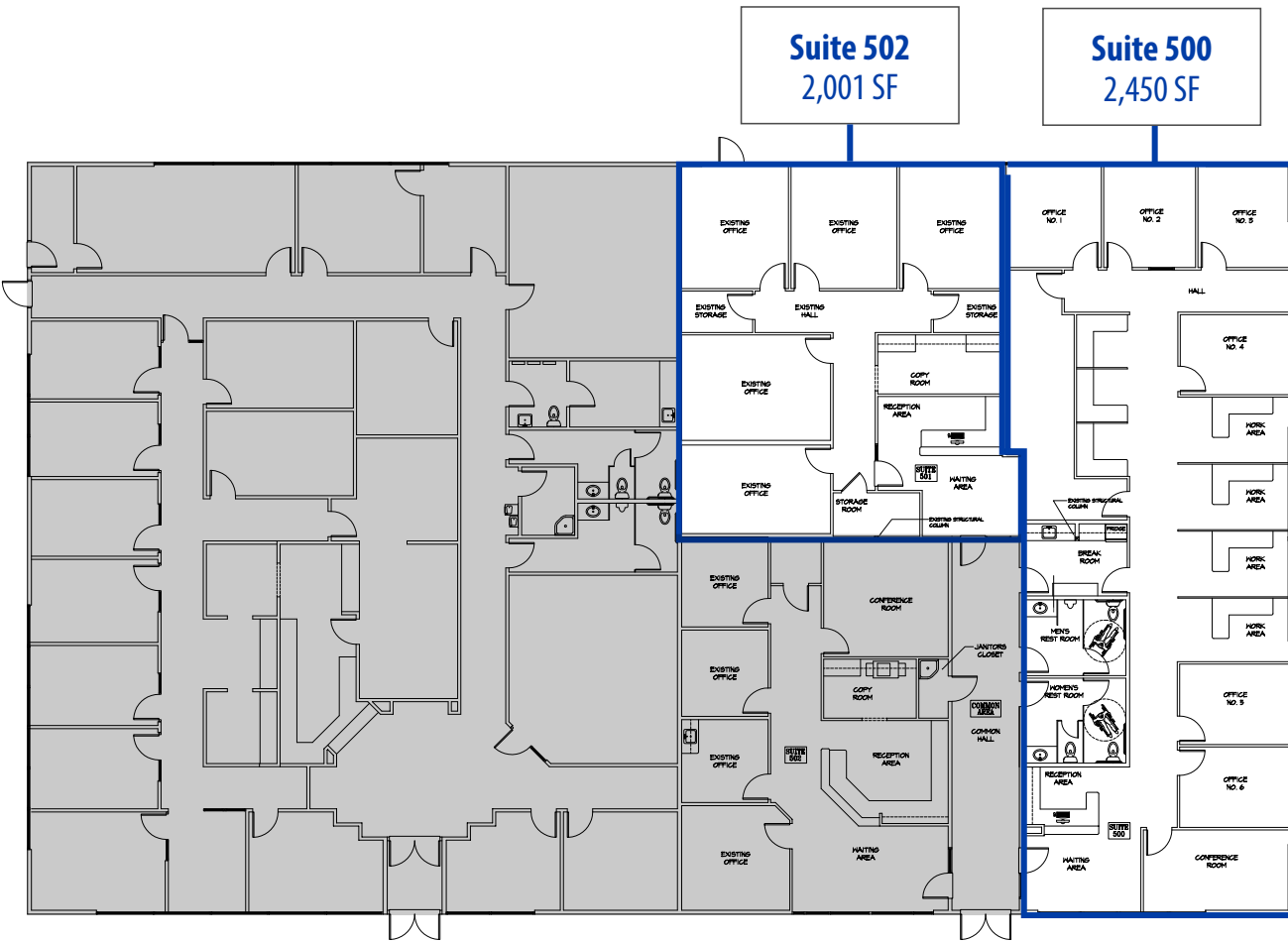

Suite 502 | Interior



Suite 502 | Interior

January 12, 2021

This information was obtained from sources believed reliable but cannot be guaranteed. Any opinions or estimates are used for example only.



OFFICE SPACE FOR LEASE
500 WOODRUFF

500-510 W. Woodruff Avenue | Idaho Falls, ID 83401

COMMERCIAL

**AERIAL
LOCATOR**

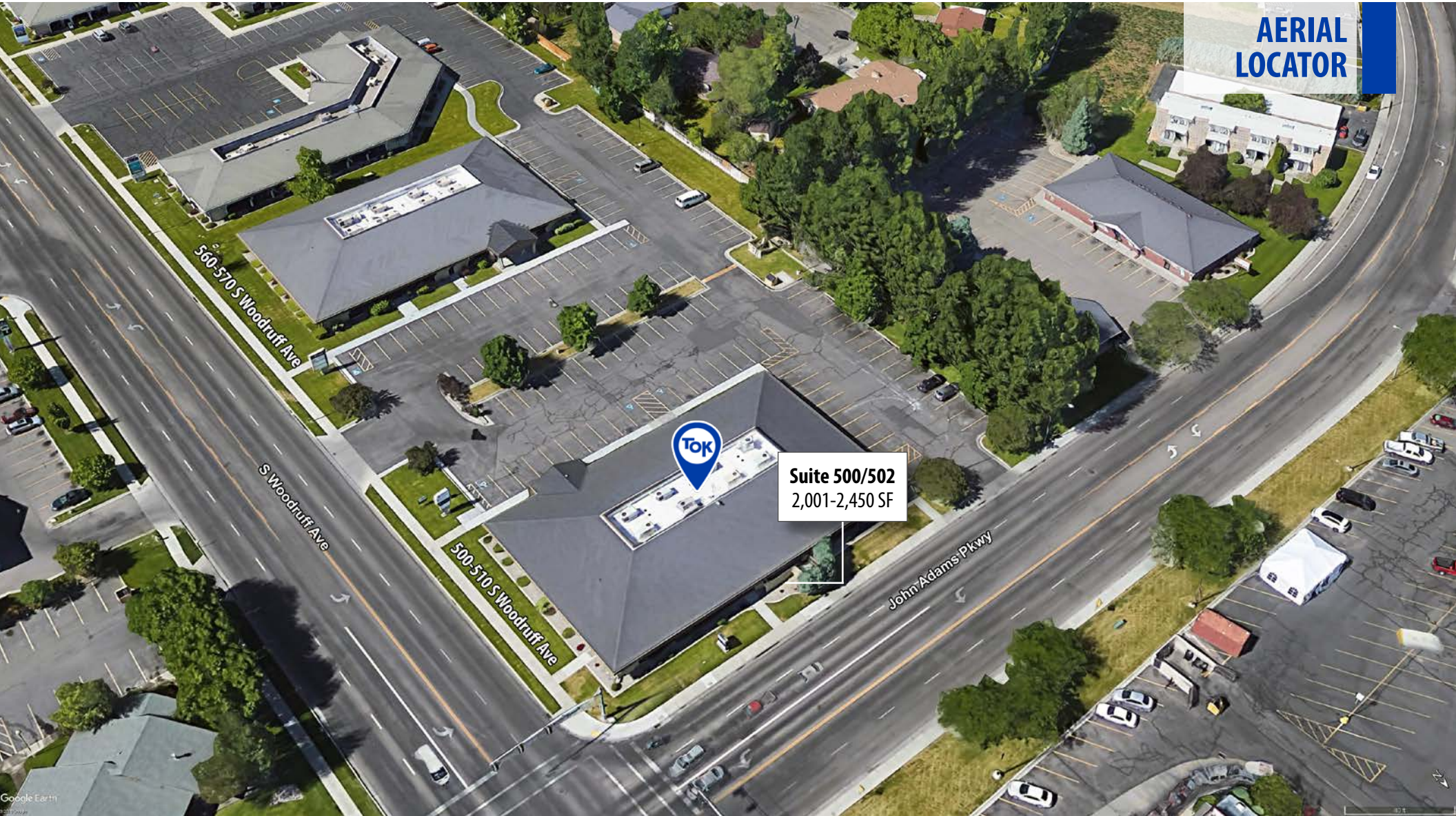

Suite 500/502
2,001-2,450 SF

January 12, 2021

This information was obtained from sources believed reliable but cannot be guaranteed. Any opinions or estimates are used for example only.

tokcommercial.com



OFFICE SPACE FOR LEASE 500 WOODRUFF

500-510 W. Woodruff Avenue | Idaho Falls, ID 83401

COMMERCIAL

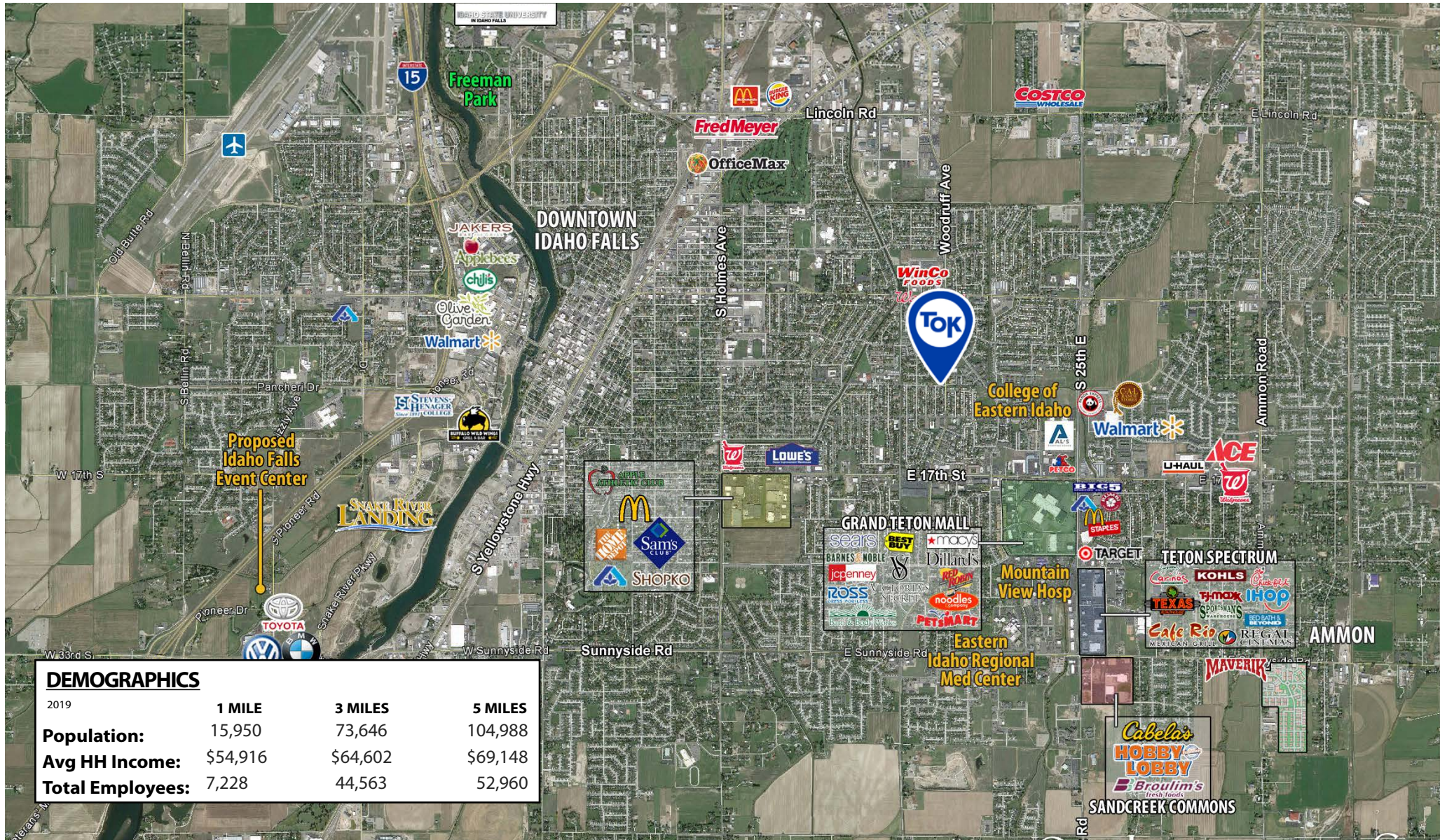

DEMOGRAPHICS

2019	1 MILE	3 MILES	5 MILES
Population:	15,950	73,646	104,988
Avg HH Income:	\$54,916	\$64,602	\$69,148
Total Employees:	7,228	44,563	52,960