



OFFICE SPACE FOR LEASE CAPITOL GATEWAY I

1109 W. MYRTLE STREET | BOISE 83702

COMMERCIAL



[CLICK TO VIEW
PROPERTY VIDEO](#)

CONVENIENTLY LOCATED

FOR LEASE | 11,374 SQ FEET

CONTACT

Peter Oliver, SIOR, CCIM

208.947.0816

peter@tokcommercial.com

Mike Greene, SIOR, CCIM

208.947.0835

mikeg@tokcommercial.com

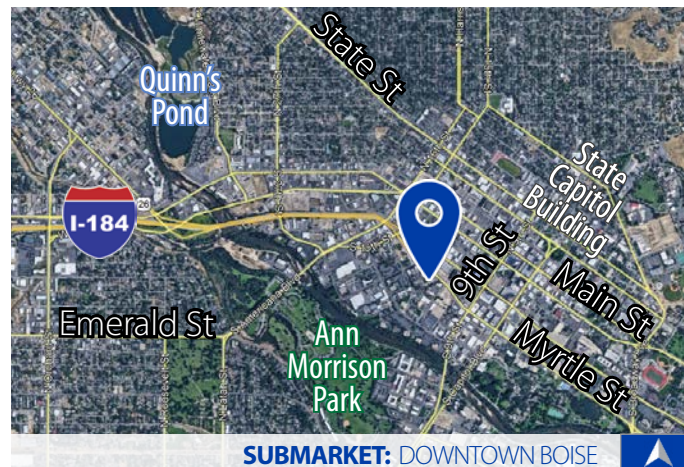

SUBMARKET: DOWNTOWN BOISE

PROPERTY INFORMATION

Submarket:	Downtown	Lease Term:	5 years
Bldg Type:	Office	Lease Type:	FLSV
Bldg Size:	31,290 SF	TI Allowance:	Negotiable
Parking:	3:1000	Available:	Immediately

AVAILABLE SPACE

SPACE	RSF	RATE
Suite 300	11,374 SF (Divisible)	\$23.00/SF

PROPERTY HIGHLIGHTS

- Excellent visibility.
- Potential on-building signage.
- Shower/locker facilities available.
- Easy access just off the I-184 connector.
- Direct access to Greenbelt via Pioneer Pathway.
- Great views of the foothills and Downtown Boise.
- Downtown location with FREE parking (ratio - 3:1000).**



OFFICE SPACE FOR LEASE CAPITOL GATEWAY I

1109 W. MYRTLE STREET | BOISE 83702

COMMERCIAL

THIRD FLOOR
11,374 SF AVAILABLE (DIVISIBLE)

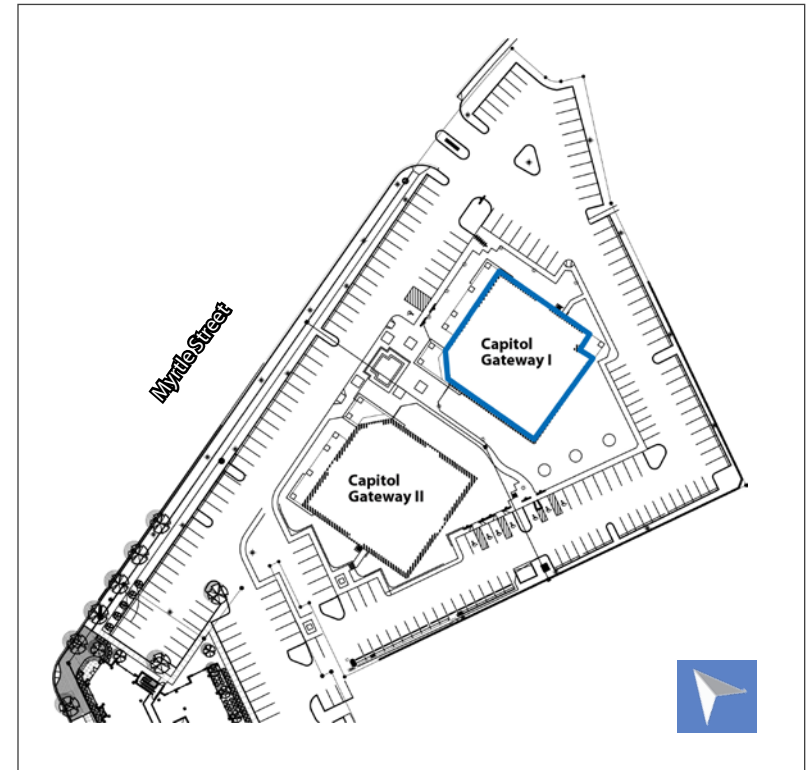
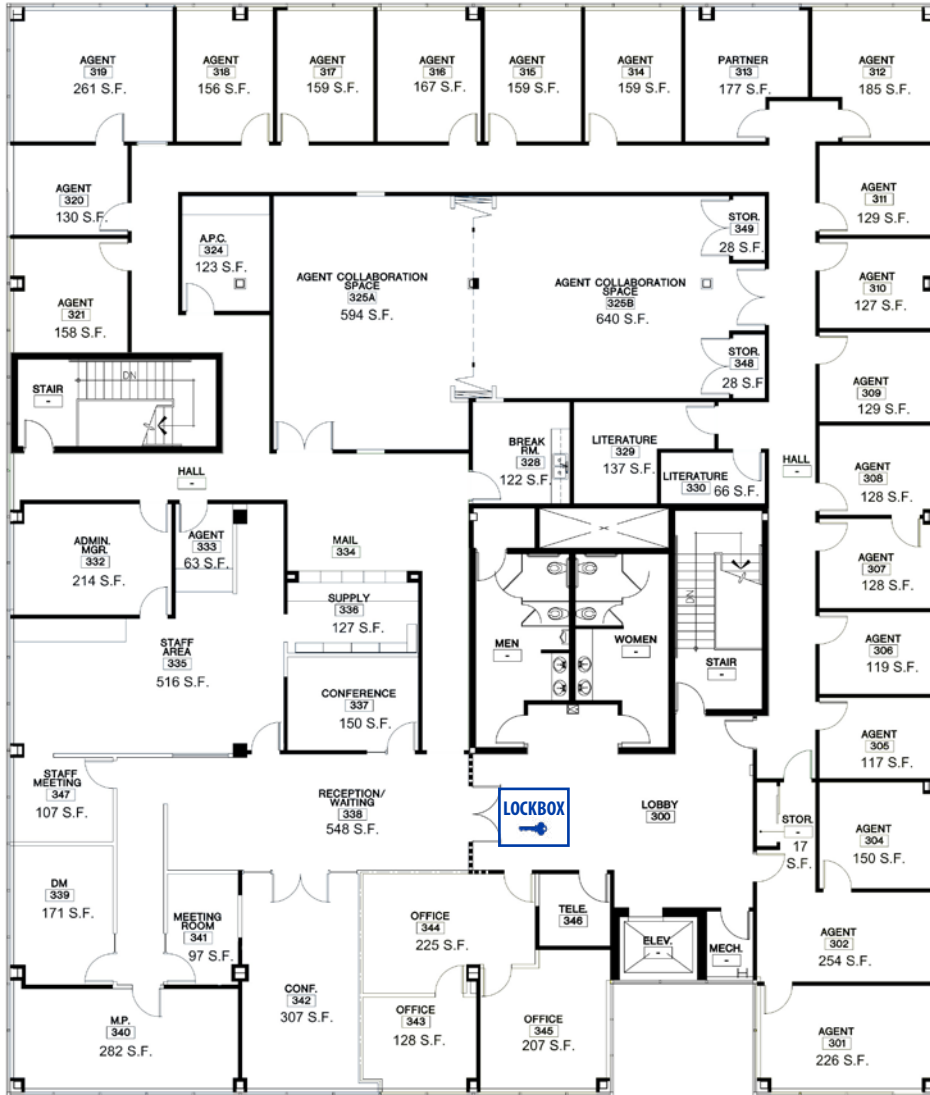



OFFICE SPACE FOR LEASE
CAPITOL GATEWAY I
1109 W. MYRTLE STREET | BOISE 83702





OFFICE SPACE FOR LEASE
CAPITOL GATEWAY I
1109 W. MYRTLE STREET | BOISE 83702





OFFICE SPACE FOR LEASE **CAPITOL GATEWAY I**

1109 W. MYRTLE STREET | BOISE 83702

COMMERCIAL



**CLICK TO VIEW
PROPERTY VIDEO**



OFFICE SPACE FOR LEASE CAPITOL GATEWAY I

1109 W. MYRTLE STREET | BOISE 83702

COMMERCIAL

AERIAL MAP | Great location in Downtown Boise

