

231 FIFTH AVE

Park Slope

Retail for Lease
300 SF

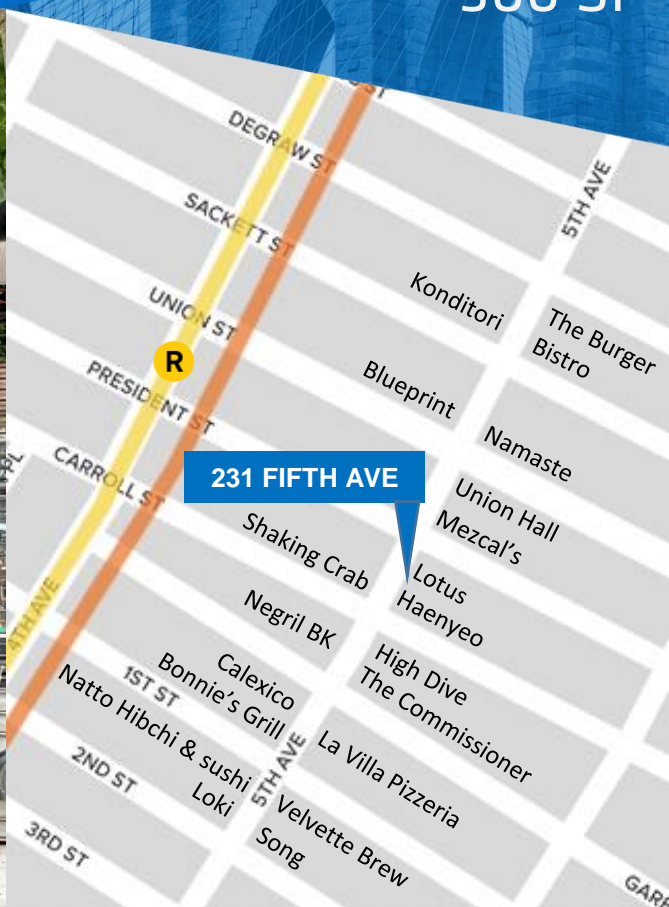
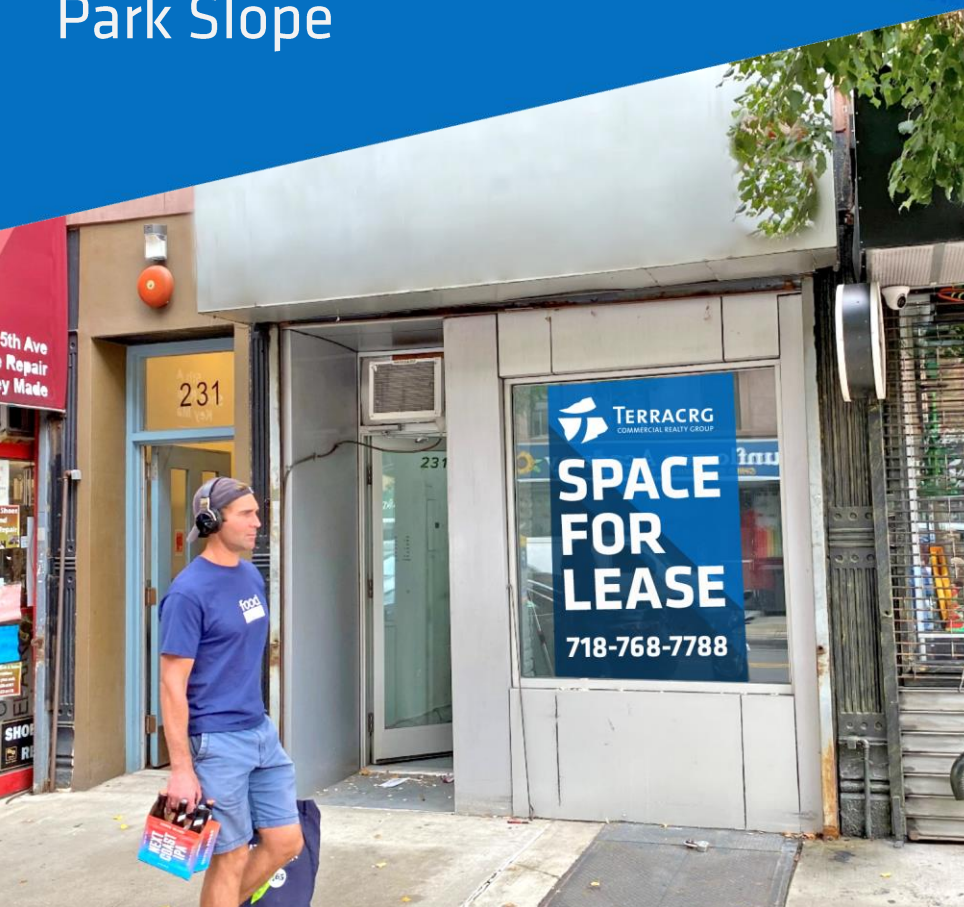

SUMMARY

This is a unique opportunity for a very efficient space on Park Slope's premier retail corridor. Surrounded by schools and playgrounds, this space is ideal for a bakery, café, and boutique store. Join neighborhood tenants like al di la, Shaking Crab, Kos Kaffe, and Union Hall.

The site is located within one of Brooklyn's most coveted residential neighborhoods, and just one block from Berkeley Carroll School with easy access to the Barclays Center.

HIGHLIGHTS

- 11 ft ceiling
- High-traffic location
- Strong co-tenancy
- Prime retail & restaurant row

LEASABLE AREA

300 SF

CEILING HEIGHT

11 Feet

CROSS STREETS

President & Carroll Streets

PRICING & TERMS

Upon request

AVAILABILITY

Immediate

TRANSPORTATION



NEIGHBORING TENANTS



calexico



Haenyeo

NEGRIL BK

al di la Trattoria



For more information, contact exclusive agents:

(718) 768-7788

Peter Schubert
pschubert@terracrgr.com

Abbie Cheng
acheng@terracrgr.com

Bill Strassman
wstrassman@terracrgr.com

George Hewitt
ghewitt@terracrgr.com

231 FIFTH AVE

Park Slope

Retail for Lease
300 SF

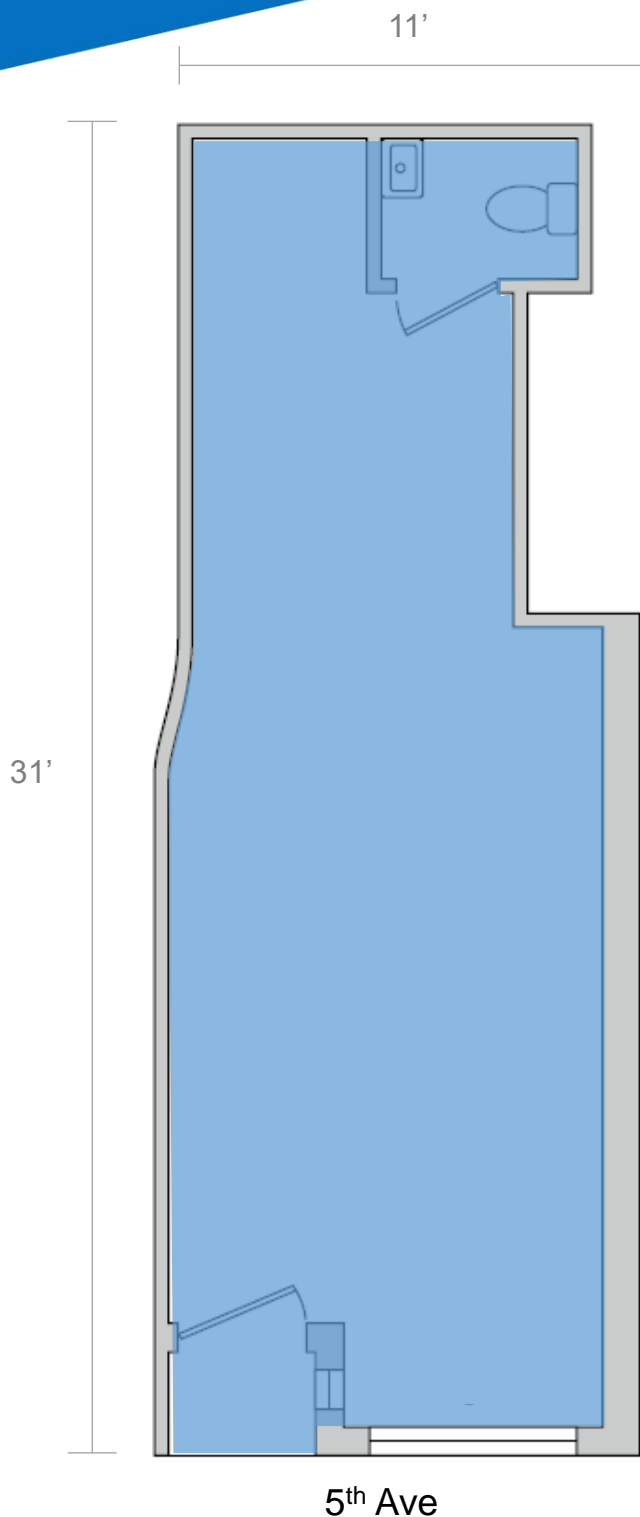

The information provided herein has either been given to us by the owner of the property or was obtained from sources we deem reliable. We do not guarantee the accuracy of any information. All zoning, existing square feet of buildings, available buildable square feet, permitted uses and any other information provided herein must be independently verified. The value of any real estate investment is dependent upon a variety of factors including income, vacancy rates, expense estimates, tax brackets and general market assumptions, all of which should be evaluated by your tax advisor and/or legal counsel. Prospective buyer and tenants should carefully verify each item of information herein.



For more information, contact
exclusive agents:

(718) 768-7788

Peter Schubert
pschubert@terracrgr.com

Abbie Cheng
acheng@terracrgr.com

Bill Strassman
wstrassman@terracrgr.com

George Hewitt
ghewitt@terracrgr.com