

**5400 DATE AVENUE
SACRAMENTO, CA**

FOR LEASE

6,324 SF - 10,118 SF AVAILABLE

ETHAN CONRAD
PROPERTIES INC.



COMPLETELY REMODELED

FOR MORE INFORMATION CONTACT:

Race Merritt

DRE: #01700659

race@ethanconradprop.com

916.779.1000

ETHAN CONRAD PROPERTIES, INC.

1300 NATIONAL DRIVE, SUITE 100 | SACRAMENTO CA, 95834 | FAX: 916.779.1200

www.ethanconradprop.com

PROPERTY DETAILS:

Landmark property with great I-80 freeway visibility.
Co-tenants include CycleGear, Sacramento
Exercise Equipment, Goodwill, 5.11 Tactical,
Sleep Train, Defy Extreme Air Sports and White Lotus
Banquet Hall.

DEMOGRAPHICS:	1 mile	3 mile	5 mile
2018 Population (est):	25,686	155,964	362,748
2018 Avg. HH Income:	\$48,620	\$65,676	\$71,593
Daily Traffic Count:	Madison Ave at Date Ave 51,745		

**FEATURES:**

- 817 feet of freeway frontage with an average of 217,000 cars per day
- Easy access to I-80 via Madison Avenue
- Location in close proximity to American River College
- Abundant parking
- Large pylon sign with excellent visibility on I-80 near Madison Avenue available

LEASE RATES:

Suite D: \$11,352.00 (\$1.89 PSF, NNN)
Suite H: \$11,393.00 (\$1.09 PSF, NNN)

NNN costs are approximately \$0.31 PSF equating to approx. 35% less than would be typical.

Race Merritt

DRE: #01700659

race@ethanconradprop.com

ETHAN CONRAD PROPERTIES, INC.

1300 NATIONAL DRIVE, SUITE 100 | SACRAMENTO CA, 95834 | 916.779.1000

www.ethanconradprop.com

The information contained herein has been obtained from sources we believe to be reliable. However, we cannot guarantee, warrant or represent its accuracy and all information is subject to error, change or withdrawal. An interested party and their advisors should conduct an independent investigation of the property to determine to your satisfaction the suitability of the property for your needs.

SITE PLAN

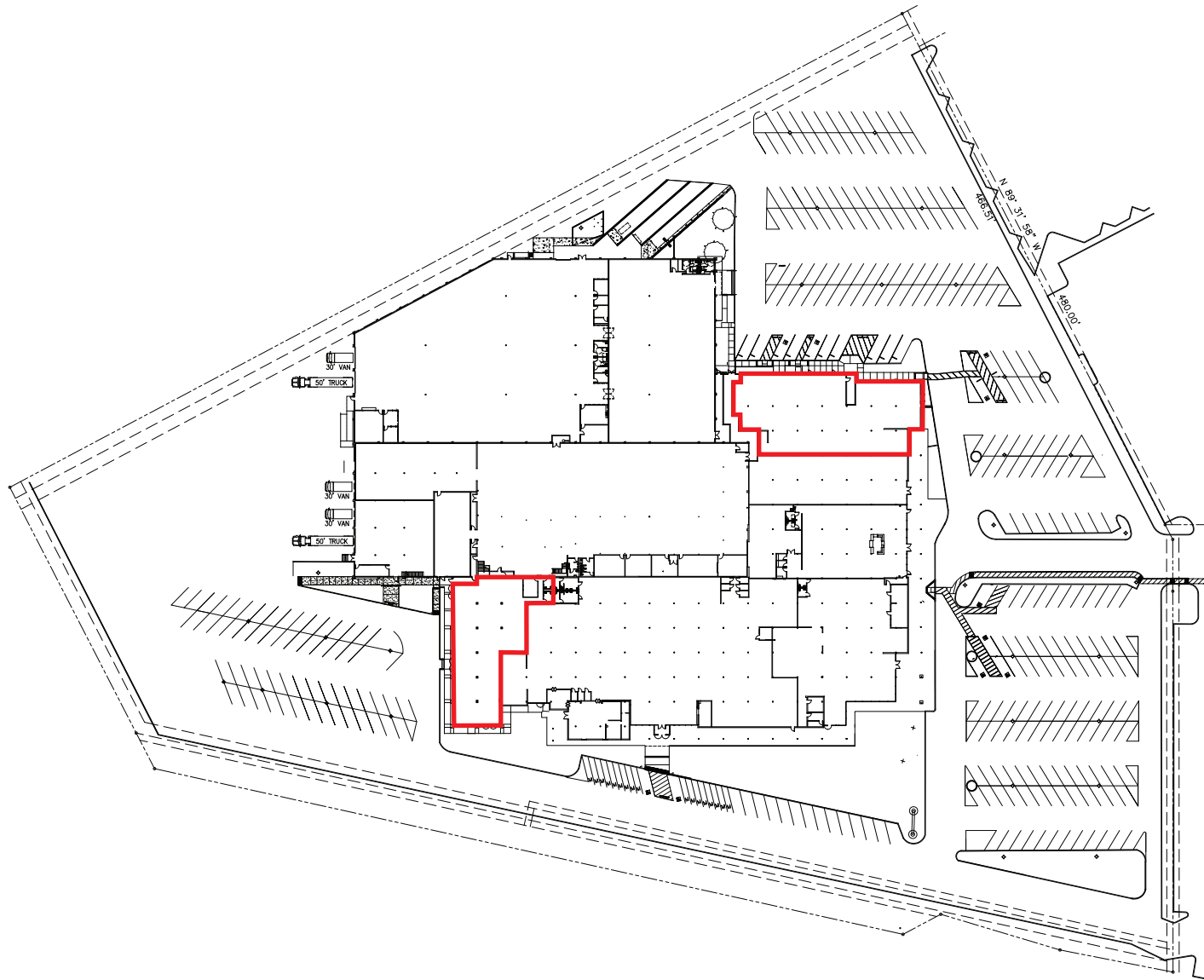
**Race Merritt**

DRE: #01700659

race@ethanconradprop.com

ETHAN CONRAD PROPERTIES, INC.

1300 NATIONAL DRIVE, SUITE 100 | SACRAMENTO CA, 95834 | 916.779.1000

www.ethanconradprop.com

The information contained herein has been obtained from sources we believe to be reliable. However, we cannot guarantee, warrant or represent its accuracy and all information is subject to error, change or withdrawal. An interested party and their advisors should conduct an independent investigation of the property to determine to your satisfaction the suitability of the property for your needs.

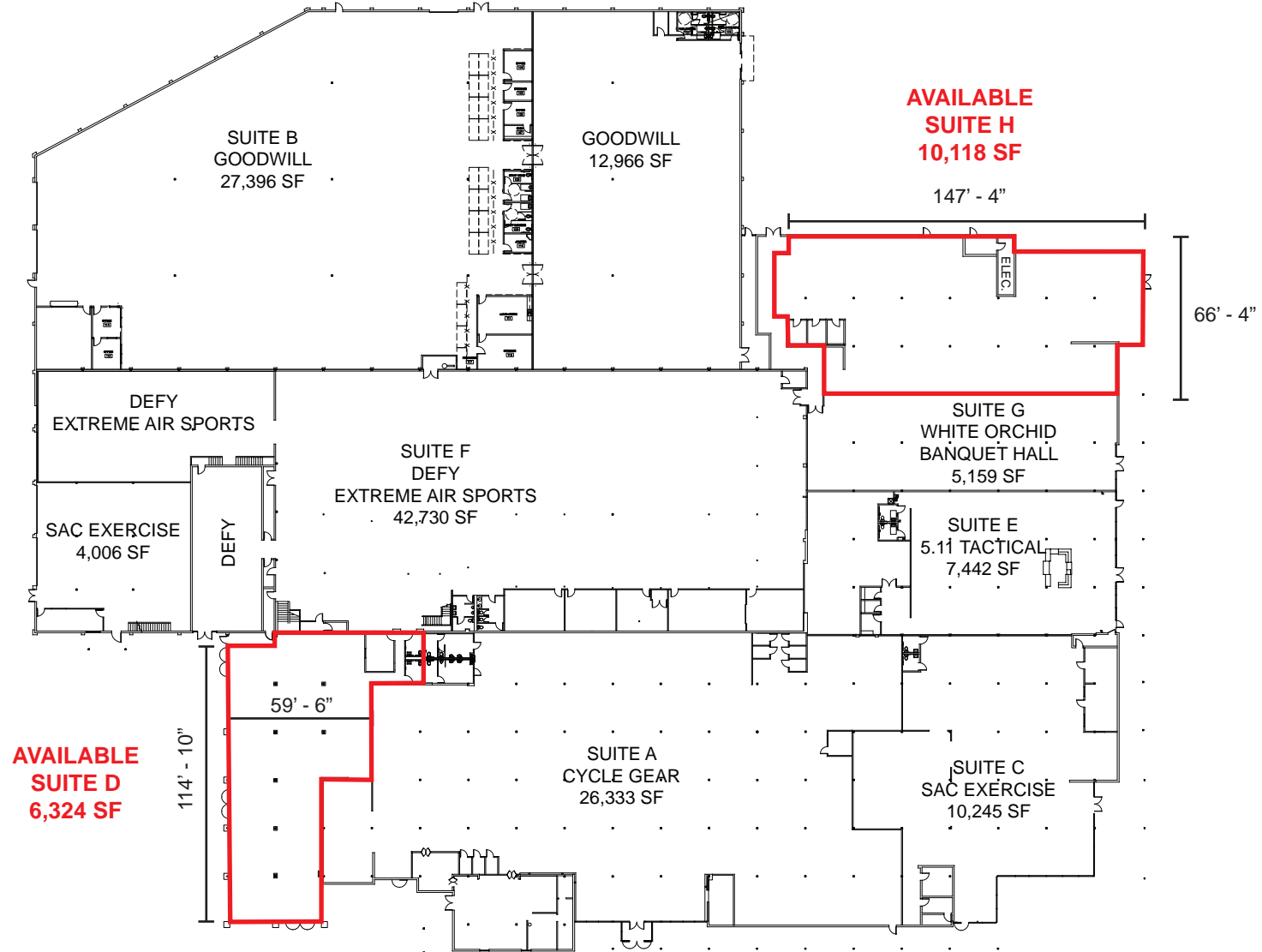
**Race Merritt**

DRE: #01700659

race@ethanconradprop.com

ETHAN CONRAD PROPERTIES, INC.

1300 NATIONAL DRIVE, SUITE 100 | SACRAMENTO CA, 95834 | 916.779.1000

www.ethanconradprop.com

The information contained herein has been obtained from sources we believe to be reliable. However, we cannot guarantee, warrant or represent its accuracy and all information is subject to error, change or withdrawal. An interested party and their advisors should conduct an independent investigation of the property to determine to your satisfaction the suitability of the property for your needs.

**Race Merritt**

DRE: #01700659

race@ethanconradprop.com

ETHAN CONRAD PROPERTIES, INC.

1300 NATIONAL DRIVE, SUITE 100 | SACRAMENTO CA, 95834 | 916.779.1000

www.ethanconradprop.com

The information contained herein has been obtained from sources we believe to be reliable. However, we cannot guarantee, warrant or represent its accuracy and all information is subject to error, change or withdrawal. An interested party and their advisors should conduct an independent investigation of the property to determine to your satisfaction the suitability of the property for your needs.

FOR LEASE

5400 DATE AVENUE
SACRAMENTO, CA



Race Merritt

DRE: #01700659

race@ethanconradprop.com

The information contained herein has been obtained from sources we believe to be reliable. However, we cannot guarantee, warrant or represent its accuracy and all information is subject to error, change or withdrawal. An interested party and their advisors should conduct an independent investigation of the property to determine to your satisfaction the suitability of the property for your needs.

ETHAN CONRAD PROPERTIES, INC.

1300 NATIONAL DRIVE, SUITE 100 | SACRAMENTO CA, 95834 | 916.779.1000

www.ethanconradprop.com