

New Owner, New Property Management Company



M.D. Medical Tower

8121 National Avenue Midwest City, OK 73110

WIGGIN
PROPERTIES, LLC

M.D. Medical Tower

8121 National Avenue Midwest City, OK 73110

WIGGIN
PROPERTIES, LLC

At-a-Glance

Address:	8121 National Ave Midwest City, OK 73110
Type:	Multi-tenant, Medical Office
Class:	B
Building Size:	68,285 SF
Stories:	4
Submarket:	South Oklahoma City
Parking:	352 spaces
Management:	Locally owned and managed

Available Space

Ground Floor	Ste. 100	1,904 RSF
	Ste. 105	1,469 RSF
	Ste. 108	7,172 RSF
	Max Contiguous	10,545 RSF
2nd Floor	Ste. 205	1,427 RSF
	Ste. 206	1,891 RSF
	Ste. 208	1,844 RSF
	Max Contiguous	5,162 RSF
3rd Floor	Ste. 305	2,540 RSF
4th Floor	Ste. 401	1,499 RSF
	Ste. 402	2,064 RSF
	Ste. 405	1,582 RSF
	Ste. 407	4,371 RSF
	Max Contiguous	9,516 RSF



M.D. Medical Tower

M.D. Medical Tower is a 68,825 square foot, four-story medical office building located adjacent to the Midwest City Hall municipal complex and within a half mile of AllianceHealth Midwest hospital. Wiggin Properties has initiated plans to invest more than \$1 million dollars to modernize the building's lobbies, common areas, exterior appeal and mechanical systems.

- The medical office building is anchored by traffic-generator Oklahoma Heart Hospital which provides echocardiograms, ultrasounds, x-rays and cardiac catheterization lab services at M.D. Medical Tower;
- Controlled key-pad access providing after-hours and weekend access for tenants;
- Four-story atrium/lobby, common areas and exterior upgrades scheduled to be completed in 2021;
- **More than \$1 million dollars in improvements underway.**

Nick Bentley and Grant Stewart, CCIM 405.842.0100

This material is provided for information purposes only. It is from sources believed to be reliable. However, Wiggin Properties makes no warranties or representations, expressed or implied, as to the accuracy or sufficiency of the information. It is presented subject to errors, omissions, changes or withdrawal without notice. Square footage is provided by the local County Assessor or the Owner. Photos and graphics with copyrights by Costar, Google, Wiggin Properties and independent contractors are used with permission.

M.D. Medical Tower

8121 National Avenue Midwest City, OK 73110

WIGGIN
PROPERTIES, LLC

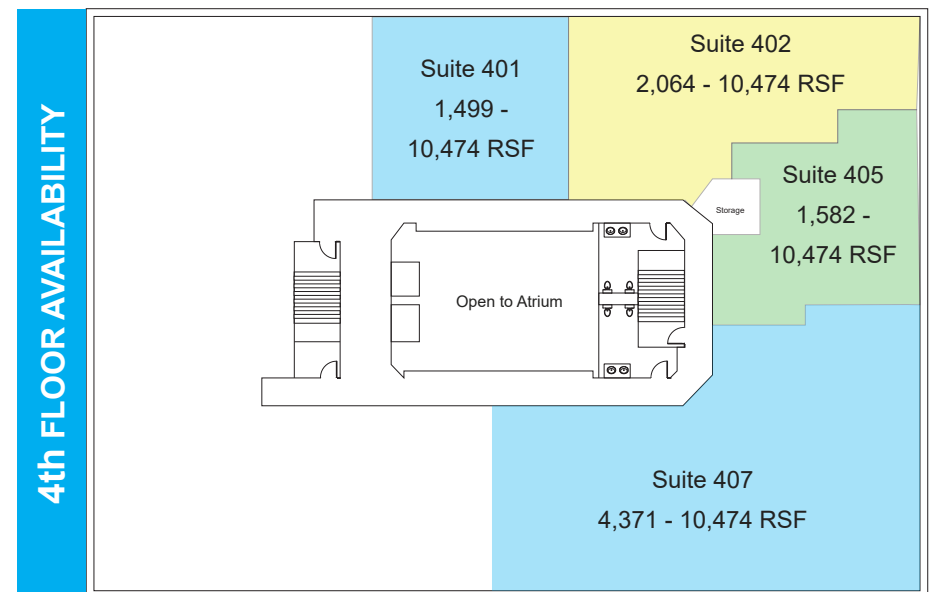
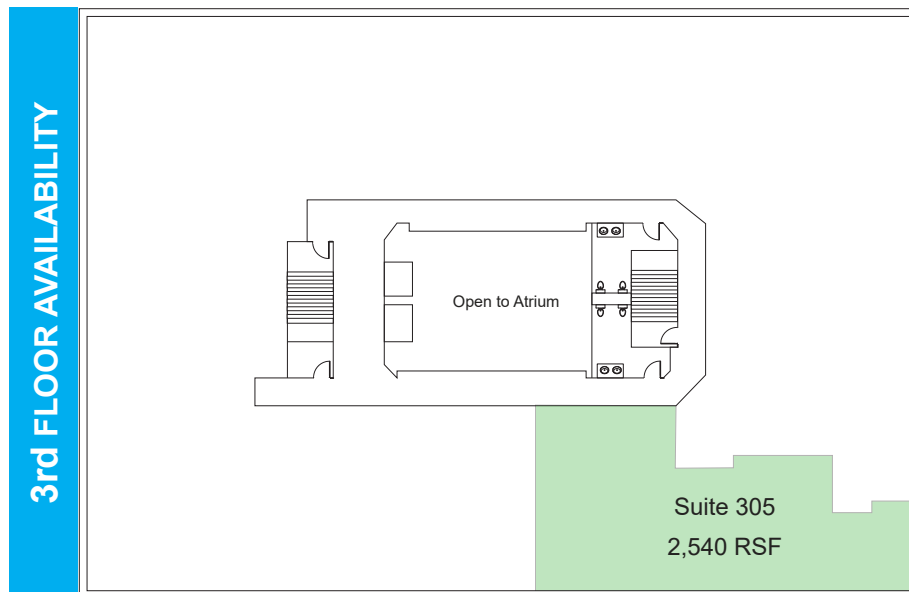
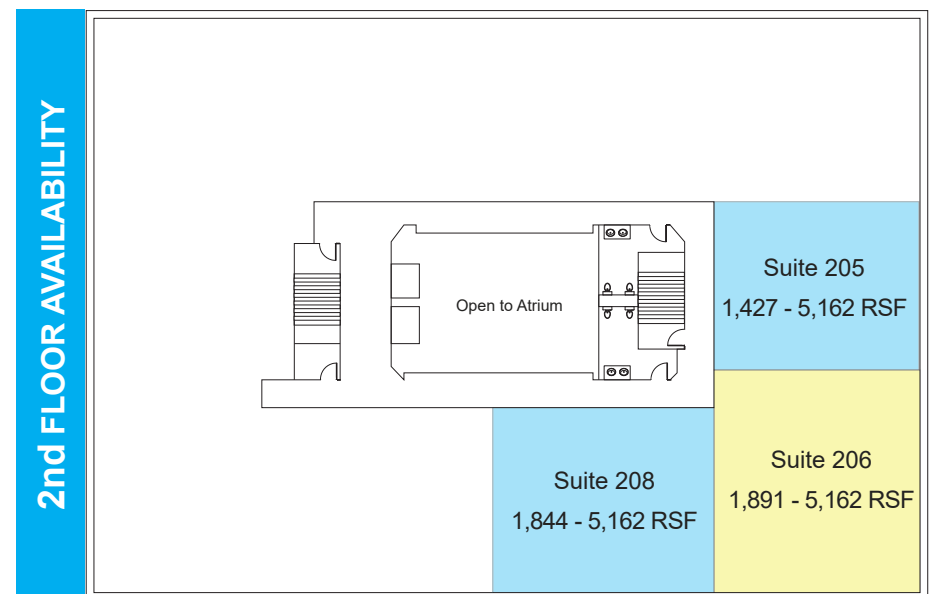
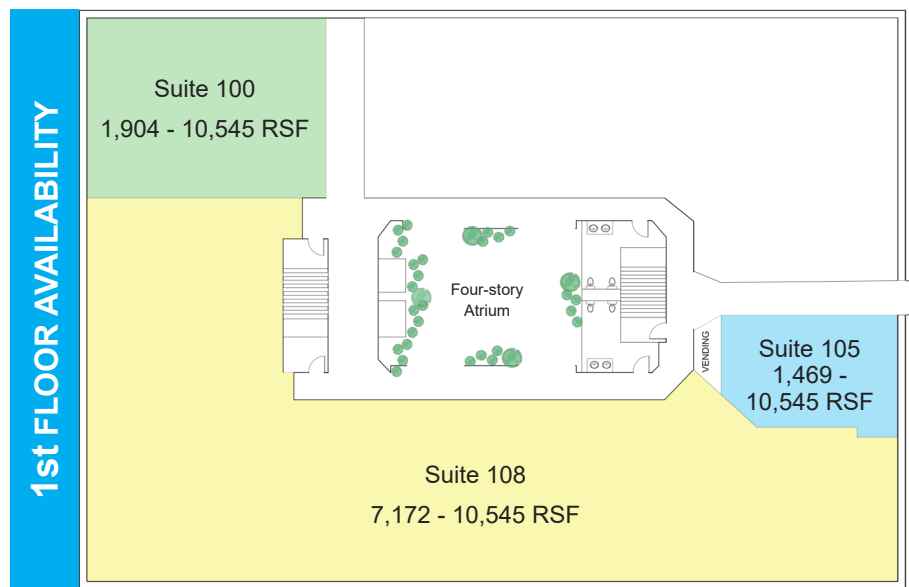

wigginprop.com/mdmedical

Nick Bentley and Grant Stewart, CCIM 405.842.0100

This material is provided for information purposes only. It is from sources believed to be reliable. However, Wiggin Properties makes no warranties or representations, expressed or implied, as to the accuracy or sufficiency of the information. It is presented subject to errors, omissions, changes or withdrawal without notice. Square footage is provided by the local County Assessor or the Owner. Photos and graphics with copyrights by Costar, Google, Wiggin Properties and independent contractors are used with permission.

Prime Location to Grow or Expand a Medical or Dental Practice

M.D. Medical Tower sits along National Avenue in Midwest City. The half mile road connects M.D. Medical Tower to AllianceHealth Midwest, a 255-bed acute care hospital; Inspire Specialty Hospital, a 31-bed, long-term acute care hospital; Landmark Cancer Center; Midwest City Municipal Complex; Midwest City Library and Midwest City Senior Center. The property is 2 miles north of Tinker Air Force Base, Oklahoma's largest single-site employer with more than 26,000 military and civilian personnel.

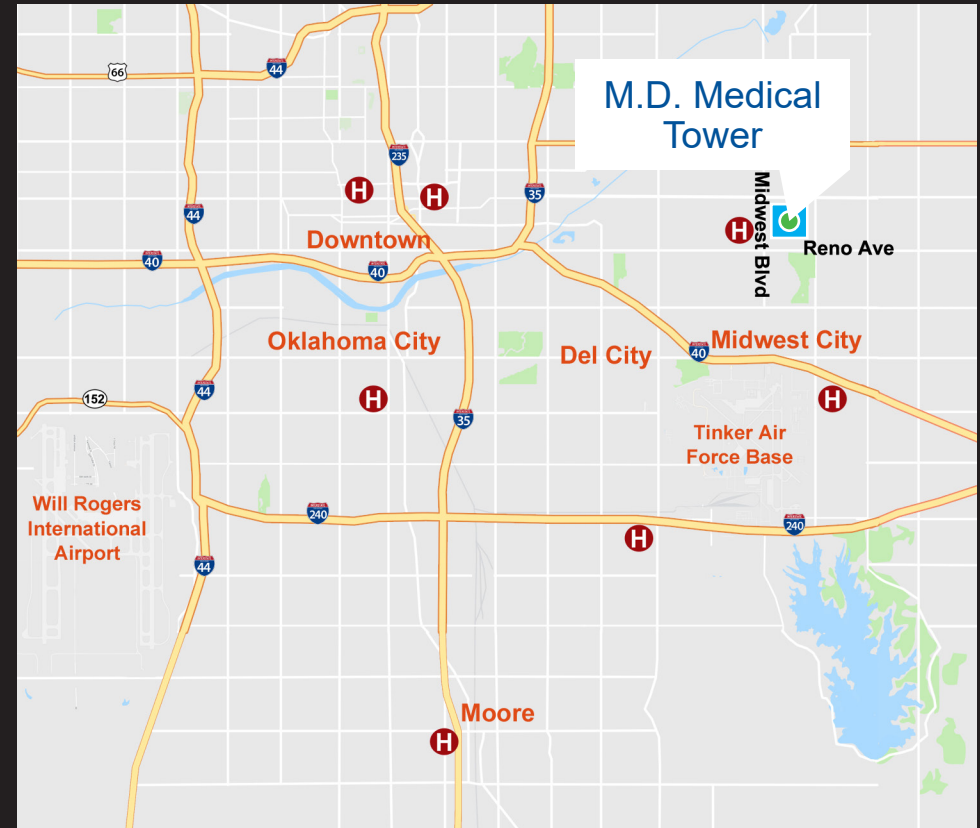
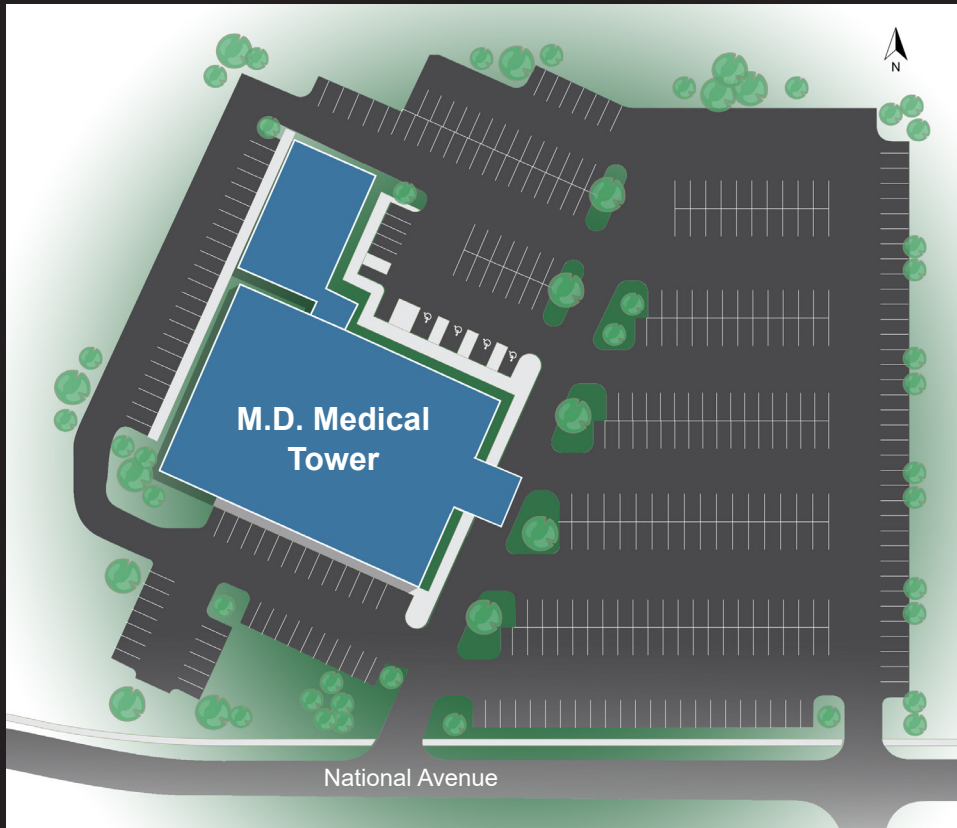

WIGGIN
PROPERTIES, LLC

M.D. Medical Tower

8121 National Avenue Midwest City, OK 73110

405.842.0100

A
CORE
Network Partner