

Office Building for Sale

# 9430-9434 Cedar Lake Ave

Oklahoma City, OK 73131

**WIGGIN**  
PROPERTIES, LLC

40 YEARS STRONG

Investment Opportunity: Occupy one suite, lease second to help pay for investment.



## Office Building for Sale

9430-9434 Cedar Lake Ave, Oklahoma City

- Building Size:** 6,200 SF
- Price:** \$990,000
- Suite 9434:** 3,486 SF MOL (1st Floor: 2,286 SF | 2nd Floor: 1,200 SF)  
7 offices, reception area, kitchen, workroom and second-story open/flex space
- Suite 9430:** 2,712 SF MOL  
6 offices, reception area, kitchen, workroom and safe room
- Amenities:** Class A finishes with high, 10' ceilings on first floor and 9' ceilings on second. Also features a safe room.
- Built:** 2005
- Covered Parking:** 8 covered parking spots and abundant free surface parking for clients

Call Nick Bentley or David Huffman, CCIM, at **405.842.0100**

[nbentley@wigginprop.com](mailto:nbentley@wigginprop.com) | [dhuffman@wigginprop.com](mailto:dhuffman@wigginprop.com) | [wigginprop.com](http://wigginprop.com)

This material is provided for information purposes only. It is from sources believed to be reliable. However, Wiggin Properties makes no warranties or representations, expressed or implied, as to the accuracy or sufficiency of the information. It is presented subject to errors, omissions, changes or withdrawal without notice. Square footage is provided by the local County Assessor or the Owner. Photos and graphics with copyrights by Costar, Google, Wiggin Properties and independent contractors are used with permission.

Office Building for Sale

# 9430-9434 Cedar Lake Ave

Oklahoma City, OK 73131

**WIGGIN**  
PROPERTIES, LLC

40 YEARS STRONG

## Location

This professional office park sits along the northwest corner of W Britton Rd and N Kelley Ave in Oklahoma City just minutes away from the city's major Interstates and cross-town connections. This location makes it an easy commute for both Edmond and Oklahoma City residents and businesses, due to the quick accessibility to the entire north-side and Edmond following these routes...

- 1 mile to Broadway Extension
- 1 mile to I-35
- 2 miles to I-44
- 2.5 miles to Kirkpatrick Turnpike



## First Story Plan

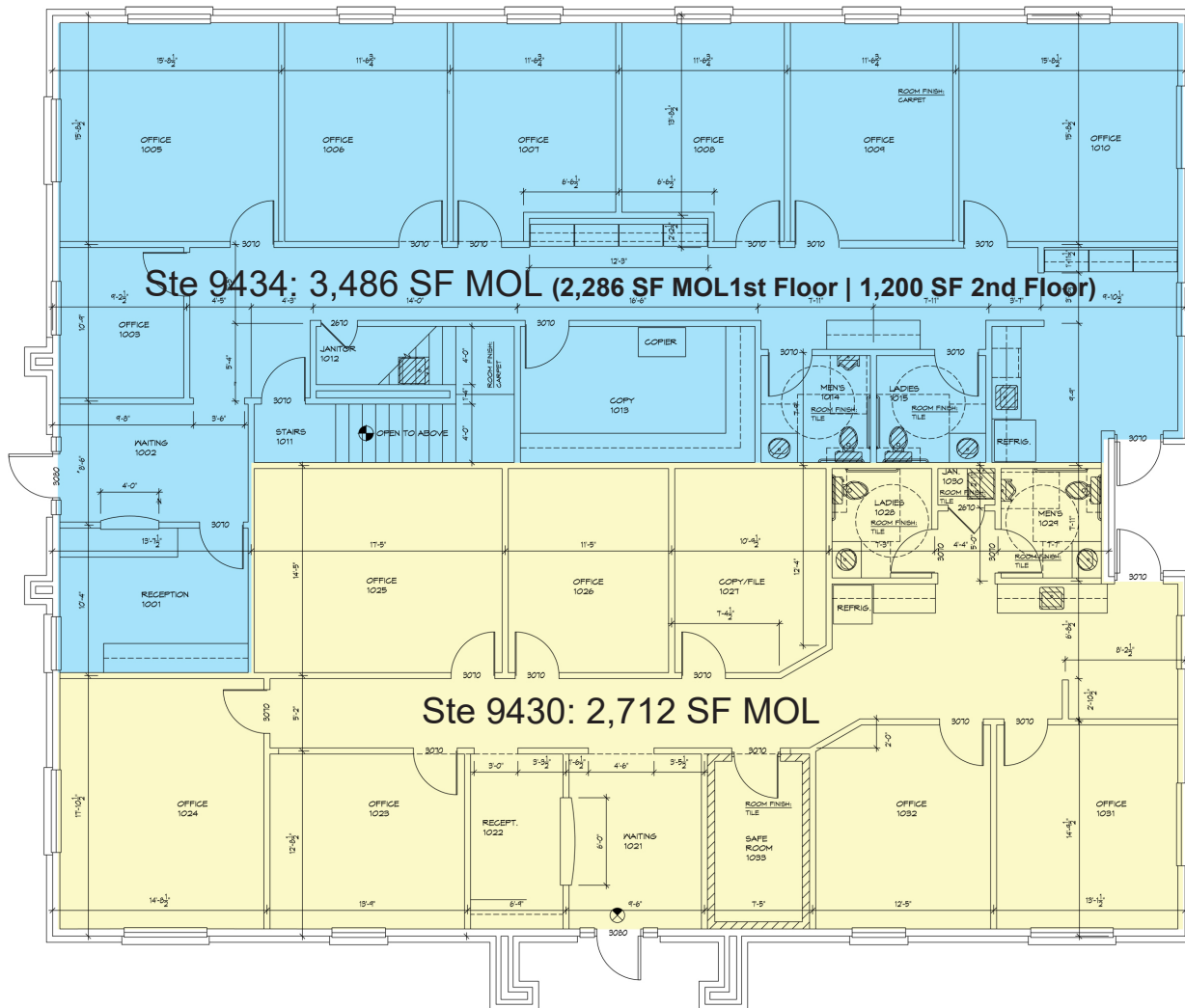

Call Nick Bentley or David Huffman, CCIM, at **405.842.0100**

[nbentley@wiginprop.com](mailto:nbentley@wiginprop.com) | [dhuffman@wiginprop.com](mailto:dhuffman@wiginprop.com) | [wiginprop.com](http://wiginprop.com)

This material is provided for information purposes only. It is from sources believed to be reliable. However, Wiggin Properties makes no warranties or representations, expressed or implied, as to the accuracy or sufficiency of the information. It is presented subject to errors, omissions, changes or withdrawal without notice. Square footage is provided by the local County Assessor or the Owner. Photos and graphics with copyrights by Costar, Google, Wiggin Properties and independent contractors are used with permission.