



**FOR GROUND LEASE OR BUILD-TO-SUIT**  
**APPROVED FOR ±6,250 SF SHOPS WITH DRIVE-THRU ENDCAP**  
*NWC Fifth St. and Palm Ave., Highland*



## FEATURES:

- Available for Ground Lease or Build-to-Suit
- Proposed Freestanding Building Suitable for Single or Multi-Tenant Retail
- Available Restaurant Endcap with Drive-Thru
- Divisible to ±1,250 SF
- Great Corner Location at Signalized Intersection of Major Traffic Corridors
- Excellent Visibility and Access
- High traffic intersection



**ESTIMATED 2019 POPULATION**  
 3 Mile Radius  
**84,117**



**ADJ. DAYTIME DEMOGRAPHICS**  
 3 Mile Radius  
**52,755**



**AVERAGE HOUSEHOLD INCOME**  
 3 Mile Radius  
**\$73,402**



**TRAFFIC COUNTS**  
 On 5th St. **25,950K CPD**      On Palm Ave. **16,900K CPD**

Source: Regis Online 2019 & City of Highland



**JEFF STANLEY | 951.276.3612**  
**DRE#: 01016436 | jstanley@leeriverside.com**



**SITE PLAN**

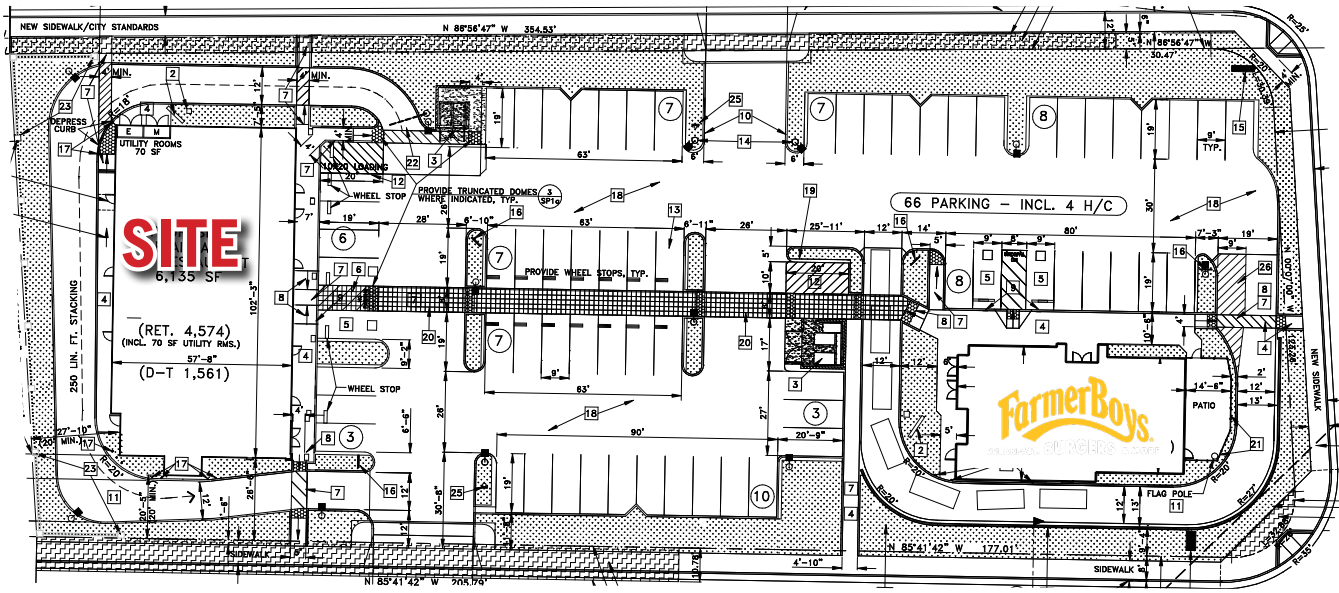

**LEE & ASSOCIATES**  
COMMERCIAL REAL ESTATE SERVICES

**JEFF STANLEY | 951.276.3612**  
DRE#: 01016436 | [jstanley@leeriverside.com](mailto:jstanley@leeriverside.com)

*No warranty or representation has been made to the accuracy of the foregoing information. Terms of sale or lease and availability are subject to change or withdrawal without notice. Lee & Associates Commercial Real Estate Services, Inc. - Riverside. 3240 Mission Inn Avenue - Riverside, CA 92507 | Corporate DRE#: 01048055*