

# ±6,279 SF FOR SUBLEASE EXCELLENT WAREHOUSE SPACE

18499 PHANTOM WEST, UNIT 7 | VICTORVILLE, CA



## PROPERTY FEATURES

- » Multimodal Logistic Center
- » Air Cargo Services
- » Minutes from I-15 & U.S. 395
- » Less than 100 Miles from the Ports of Los Angeles and Long Beach
- » Optimal Location for Interstate and International Distribution
- » Abundant Skilled Workforce at Competitive Rates
- » Municipalized Utilities/Low Cost Reliable Power
- » Competitive Operating Costs/Lowest in the Region
- » Project-Wide Expansion Opportunities
- » Onsite Property Management.



## CONTACT ME

JACK HOGAN  
(949) 724-4738  
jhogan@lee-associates.com  
DRE# 01274996

 **LEE &  
ASSOCIATES**  
**NEWPORT BEACH**

DISCLAIMER: The information contained herein has been obtained from the property owner or other third party and is provided to you without verification as to accuracy. We (Lee & Associates, its brokers, employees, agents, principals, officers, directors and affiliates) make no warranty or representation regarding the information, property, or transaction. You and your attorneys, advisors and consultants should conduct your own investigation of the property and transaction.

±6,279 SF FOR SUBLEASE  
**EXCELLENT WAREHOUSE SPACE**

18499 PHANTOM WEST, UNIT 7 | VICTORVILLE, CA

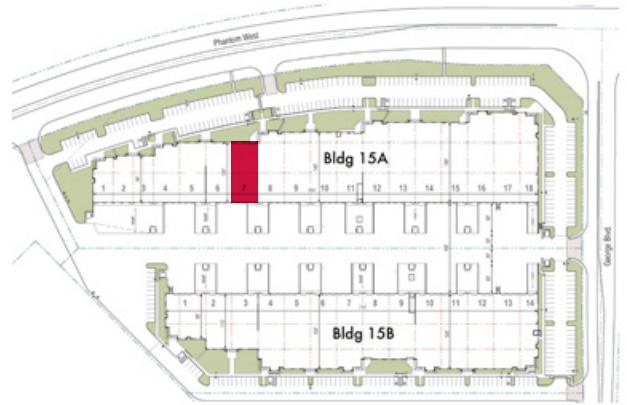
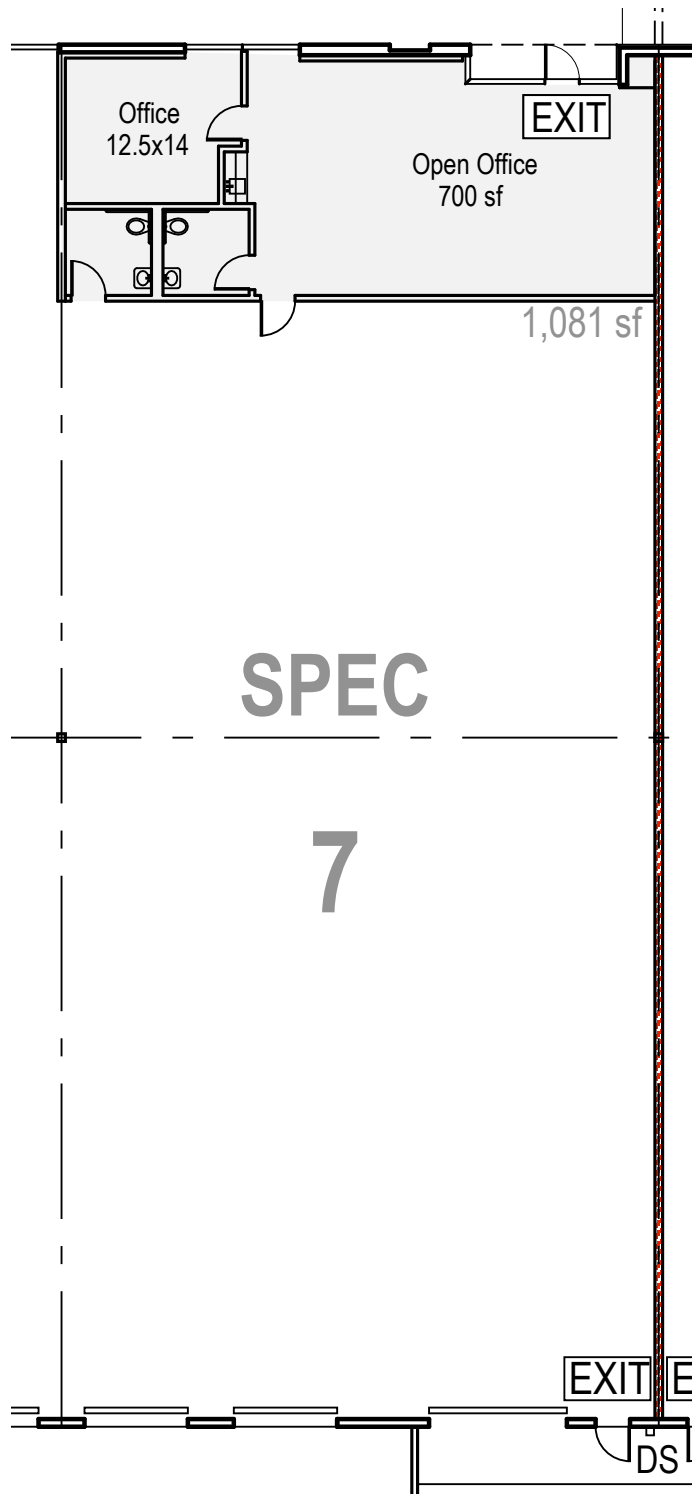

**CONTACT ME**

JACK HOGAN  
(949) 724-4738  
jhogan@lee-associates.com  
DRE# 01274996



DISCLAIMER: The information contained herein has been obtained from the property owner or other third party and is provided to you without verification as to accuracy. We (Lee & Associates, its brokers, employees, agents, principals, officers, directors and affiliates) make no warranty or representation regarding the information, property, or transaction. You and your attorneys, advisors and consultants should conduct your own investigation of the property and transaction.