

OFFICE/MEDICAL BUILDING



1353 OLD TEMESCAL ROAD • CORONA, CA 92881



PROPERTY FEATURES

- Freestanding Multi-Tenant Office Building
- Approved for Medical Use
- Great Visibility
- Frontage on Old Temescal Rd
- 5:1,000 SF Parking Ratio
- Easy Access to I-15 and 91 Freeways
- Contact Agent For Future Availability



For Further Information Please Contact:

LES COPELIN
951.276.3629

lcopepin@lee-associates.com
License ID# 00995220

No warranty or representation has been made to the accuracy of the foregoing information. Terms of sale or lease and availability are subject to change or withdrawal without notice. Lee & Associates Commercial Real Estate Services, Inc. -Riverside, Corp. DRE# 01048055

OFFICE/MEDICAL SPACE AVAILABLE

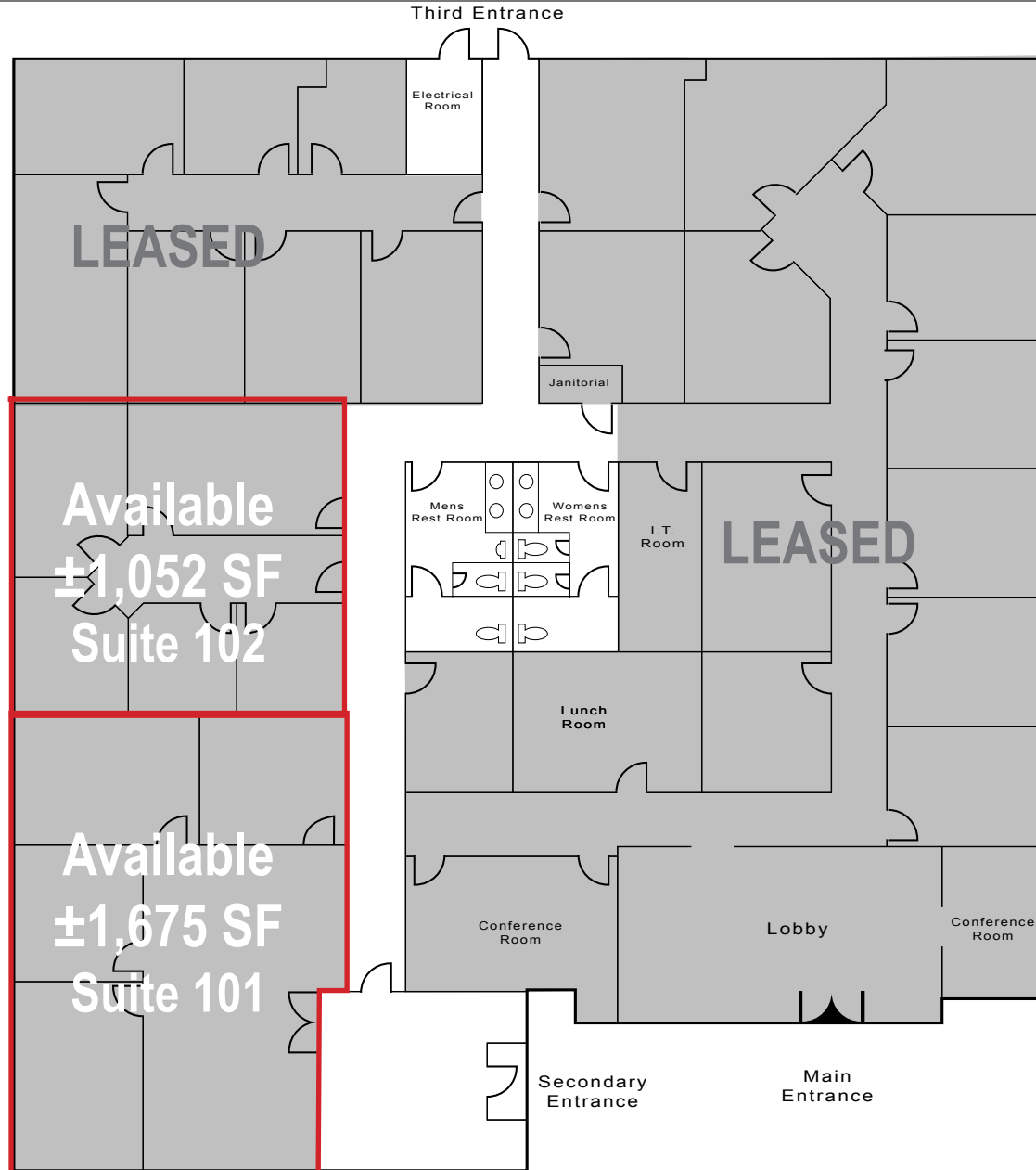

AVAILABLE SPACE

SUITE	± SF	DESCRIPTION
101	1,675	Contact Agent for More Details (Can be combined for ±2,727 RSF)
102	1,052	Contact Agent for More Details (Can be combined for ±2,727 RSF)

1353 OLD TEMESCAL ROAD • CORONA, CA 92881



For Further Information Please Contact:

LES COPELIN
951.276.3629

lcopelin@lee-associates.com
License ID# 00995220

No warranty or representation has been made to the accuracy of the foregoing information. Terms of sale or lease and availability are subject to change or withdrawal without notice. Lee & Associates Commercial Real Estate Services, Inc. -Riverside, Corp. DRE# 01048055