

CROSSROADS CORPORATE CENTER

PREMIER CLASS "A" OFFICE CAMPUS

25230 & 25250 HANCOCK AVENUE | MURRIETA, CA

FUTURE PHASES III & IV OFFICE BUILDING DEVELOPMENT

FUTURE PHASE
±78,032 SQ. FT.
25250 HANCOCK AVENUE
MURRIETA, CA 92562



FUTURE PHASE
±39,018 SQ. FT.
25230 HANCOCK AVENUE
MURRIETA, CA 92562



PROPERTY FEATURES:

- Crossroads Corporate Center, ±273,121 SF master planned four building office campus, Phases III & IV currently available.
- Phases III & IV are Fully Entitled Future Buildings, only requiring construction documents which substantially reduces the cost and development time frame.
- Existing Phases I & II consist of two 4-story office buildings totaling ±153,000 SF, currently ±90% occupied.
- Fully Entitled
- Excellent Murrieta location at the "Golden Triangle", confluence of the I-15 and 215 freeways, bordering City of Temecula. Crossroads is visible from both freeways bordering along the 215 freeway.
- Minutes from County Courthouses, Hospitals, Financial Institutions, Restaurants and other services.
- Prominent Building & Freeway Monument Signage Available.
- Build to Suit Opportunities

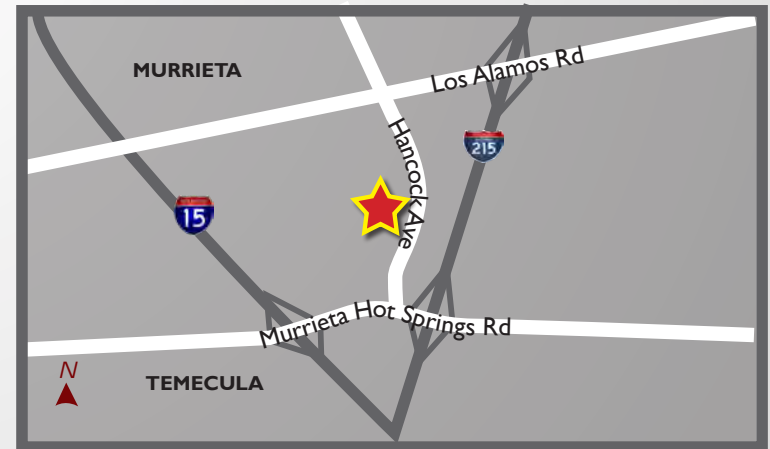

LEE & ASSOCIATES
COMMERCIAL REAL ESTATE SERVICES

25240 Hancock Avenue, Suite 100
Murrieta, CA 92562
P: 951.445.4500 F: 951.445.4527
www.lee-associates.com

FOR MORE INFORMATION,
PLEASE CONTACT:

MARY PIPER
(951) 445-4516
mpiper@lee-associates.com
Lic.#01268829

CROSSROADS CORPORATE CENTER

PREMIER CLASS "A" OFFICE CAMPUS

25230 & 25250 HANCOCK AVENUE | MURRIETA, CA

FUTURE PHASES III & IV OFFICE BUILDING DEVELOPMENT



LEE & ASSOCIATES
COMMERCIAL REAL ESTATE SERVICES

25240 Hancock Avenue, Suite 100
Murrieta, CA 92562
P: 951.445.4500 F: 951.445.4527
www.lee-associates.com

FOR MORE INFORMATION,
PLEASE CONTACT:

MARY PIPER
(951) 445-4516
mpiper@lee-associates.com
Lic.#01268829

No warranty or representation has been made to the accuracy of the foregoing information. Terms of sale or lease and availability are subject to change or withdrawal without notice. Lee & Associates Commercial Real Estate Services, Inc. - Riverside. 25240 Hancock Avenue, Suite 100 - Murrieta, CA 92562 | Corporate ID# 01048055

CROSSROADS CORPORATE CENTER

PREMIER CLASS "A" OFFICE CAMPUS

25230 & 25250 HANCOCK AVENUE | MURRIETA, CA

FUTURE PHASES III & IV OFFICE BUILDING DEVELOPMENT



MURRIETA TOWN CENTER

25220 HANCOCK AVENUE
±76,500 SQ. FT.
EXISTING OFFICE BUILDING



25240 HANCOCK AVENUE
±76,500 SQ. FT.
EXISTING OFFICE BUILDING

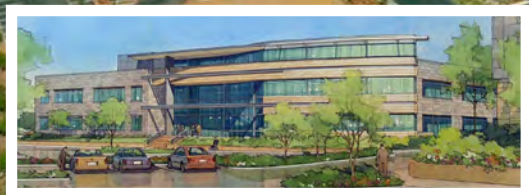

25230 HANCOCK AVENUE
FUTURE ±39,018 SQ. FT.
OFFICE BUILDING

25250 HANCOCK AVENUE
FUTURE ±78,032 SQ. FT.
OFFICE BUILDING

HANCOCK AVENUE

 **LEE & ASSOCIATES**
COMMERCIAL REAL ESTATE SERVICES

25240 Hancock Avenue, Suite 100
Murrieta, CA 92562
P: 951.445.4500 F: 951.445.4527
www.lee-associates.com

FOR MORE INFORMATION,
PLEASE CONTACT:

MARY PIPER
(951) 445-4516
mpiper@lee-associates.com
Lic.#01268829

No warranty or representation has been made to the accuracy of the foregoing information. Terms of sale or lease and availability are subject to change or withdrawal without notice. Lee & Associates Commercial Real Estate Services, Inc. - Riverside. 25240 Hancock Avenue, Suite 100 - Murrieta, CA 92562 | Corporate ID# 01048055