

FOR LEASE OR SALE BRAND NEW - FIRST CLASS TRUCK YARD

1549 INDUSTRIAL DRIVE, STOCKTON, CA

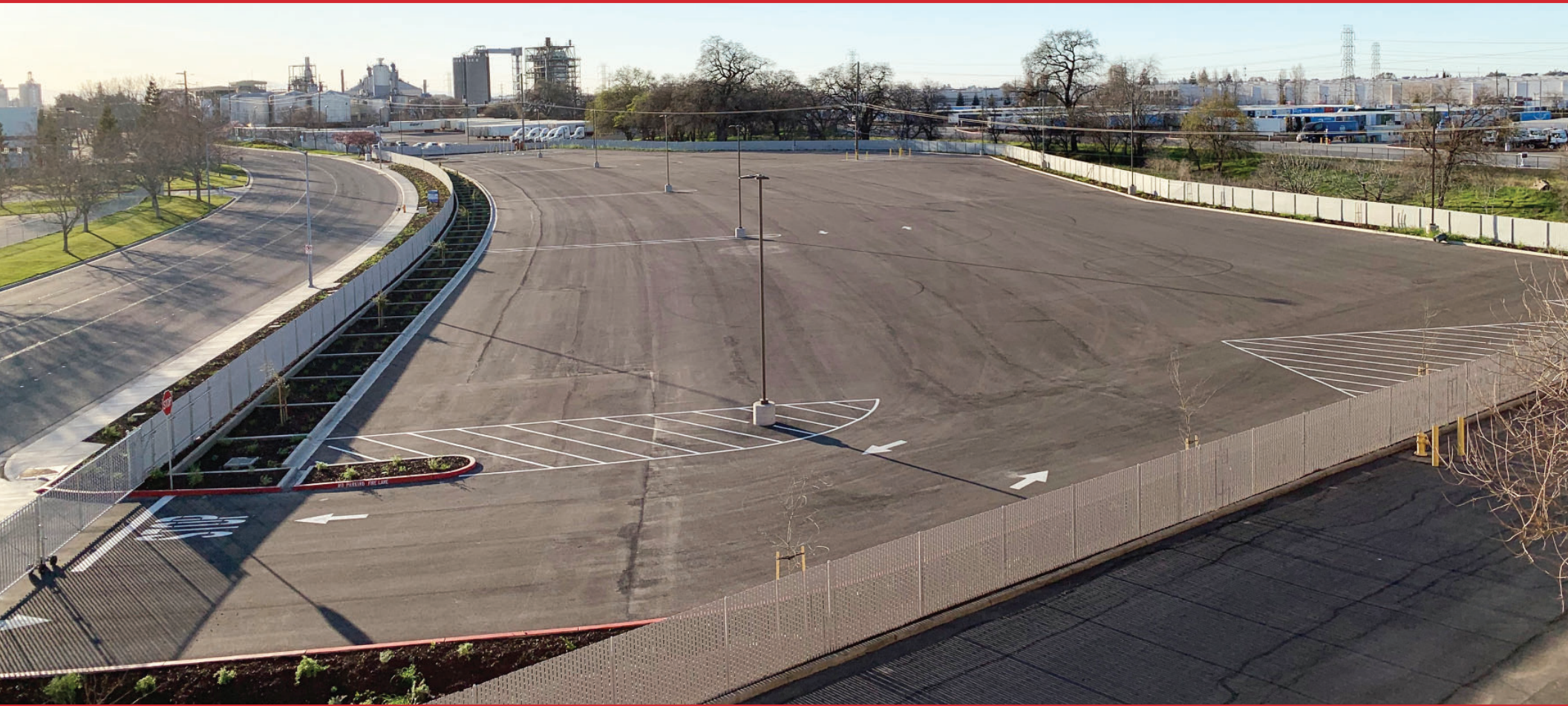

- **APN:** 177-320-09
- **Parcel Size:** 4.06± Acres
- **Yard:** Fenced, screened, paved and lit with two (2) gated entrances
- **Zoning:** IG, General Industrial (City of Stockton)

PRICING:

LEASE: \$26,500.00 PER MONTH, NNN

SALE: CONTACT AGENT FOR PRICING

Jim Martin, SIOR

BRE #01214270

jmartin@lee-associates.com

D 209.983.4088

C 925.352.6948

Guy Grace

BRE #02045756

ggrace@lee-associates.com

D 209.982.4444

C 925.360.8610

FOR LEASE OR SALE BRAND NEW - FIRST CLASS TRUCK YARD

1549 INDUSTRIAL DRIVE, STOCKTON, CA

SITE PLAN

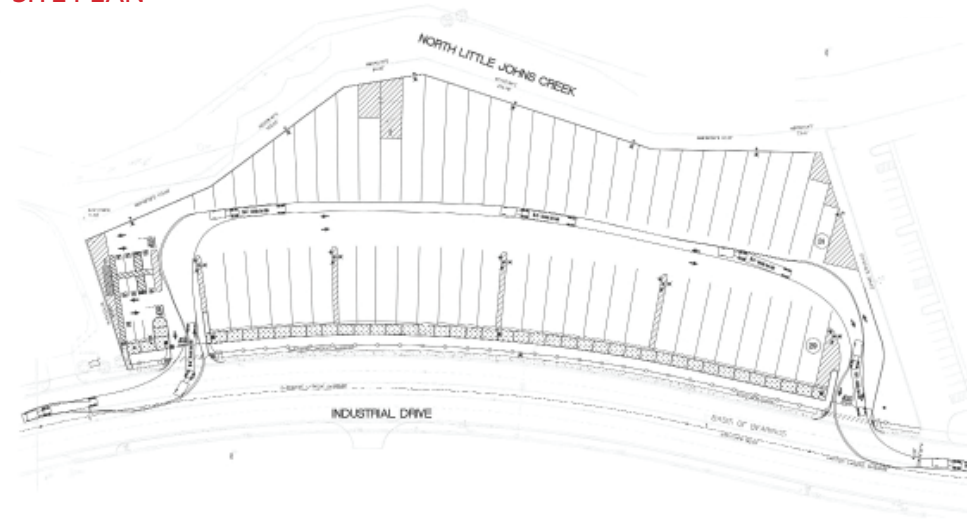

FEATURES:

- Completed January 2020
- Offering up to 283± Trailer Parking Positions
- Located north of the Stockton Metropolitan Airport with commercial airline service (Alegiant, United) and freight service (Fed Ex, Amazon Prime)
- Ideally located between I-5 and Hwy 99 with excellent access to each via STAA Truck Route approved Arch/Sperry connector and French Camp/I-5 or Arch Road/Hwy 99 interchanges.
- Immediately surrounded by and adjacent to some of the world's most recognizable companies, including Amazon (615,440± SF), Whirlpool (452,000± SF), Trader Joe's (770,000± SF), Raley's (545,000± SF), BMW (437,000± SF), Home Depot (195,000± SF), Bed, Bath and Beyond (1,004,000± SF), Dollar Tree (825,000± SF)

FOR LEASE OR SALE BRAND NEW - FIRST CLASS TRUCK YARD

1549 INDUSTRIAL DRIVE, STOCKTON, CA

LEE & ASSOCIATES
COMMERCIAL REAL ESTATE SERVICES



All information furnished regarding property for sale, rental or financing is from sources deemed reliable, but no warranty or representation is made to the accuracy thereof and same is submitted to errors, omissions, change of price, rental or other conditions prior to sale, lease or financing or withdrawal without notice. No liability of any kind is to be imposed on the broker herein.

FOR LEASE OR SALE BRAND NEW - FIRST CLASS TRUCK YARD

1549 INDUSTRIAL DRIVE, STOCKTON, CA

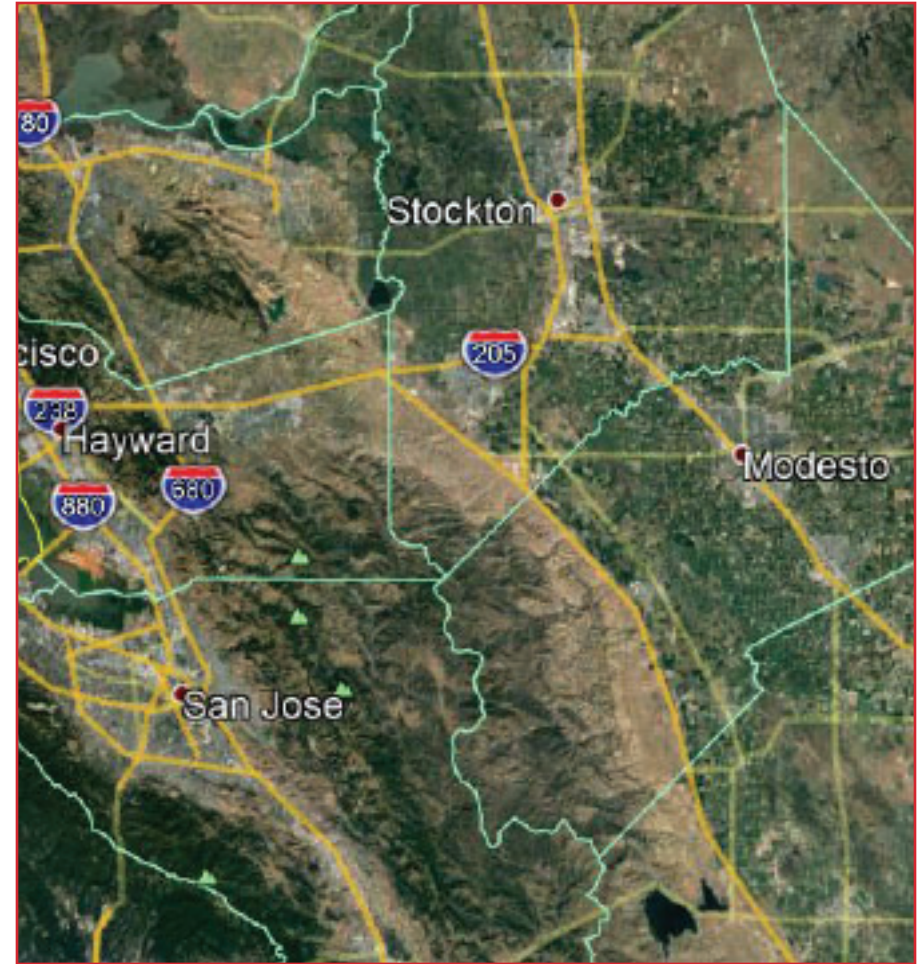
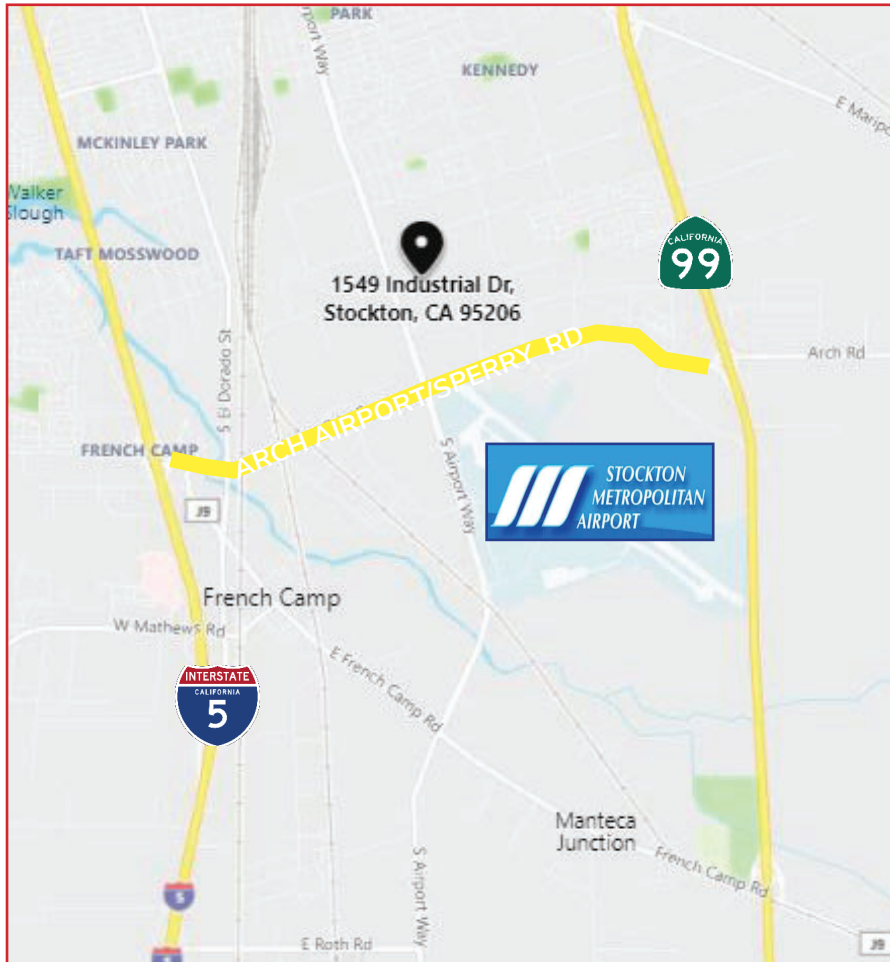

Mileage to Freeways:

- Highway 4: 2.7 miles
- Interstate 5: 3.3 miles
- Highway 99: 3.6 miles
- Highway 120: 10 miles

Mileage to Intermodal Yards:

- BNSF (Stockton): 4.7± Miles
- UPRR (Manteca): 4.7± Miles

Jim Martin, SIOR

BRE #01214270
jmartin@lee-associates.com
D 209.983.4088
C 925.352.6948

Guy Grace

BRE #02045756
ggrace@lee-associates.com
D 209.982.4444
C 925.360.8610