

**FOR SALE**

**NNN LEASED INVESTMENT**



**8112 Milliken Ave., Suite 103, Rancho Cucamonga, California 91730**

FOR MORE INFORMATION PLEASE CONTACT:

**Brian Melkesian**, Senior Vice President

909.373.2943

[bmelkesian@lee-assoc.com](mailto:bmelkesian@lee-assoc.com)

DRE #01839590

**Greg Martin**, Senior Vice President

909.373.2904

[gmartin@lee-assoc.com](mailto:gmartin@lee-assoc.com)

DRE #01001749

**Lee & Associates® - Ontario**  
3535 Inland Empire Blvd, Ontario, CA 91764 | 909.989.7771 | [lee-assoc.com](http://lee-assoc.com)  
Corp ID 00976995

All information furnished regarding property for sale, rental or financing is from sources deemed reliable, but no warranty or representation is made to the accuracy thereof and same is submitted to errors, omissions, change of price, rental or other conditions prior to sale, lease or financing or withdrawal without notice. No liability of any kind is to be imposed on the broker herein.

# FOR SALE

# NNN LEASED INVESTMENT

## PROPERTY FEATURES:

- 100% Leased NNN Investment
- ±4,126 SF 2-Tenant Medical Condo
- ±5% CAP Rate
- 100% Long Term Leased with Annual Net Income in Excess of \$100,000
- Modern Construction with Many High End Improvements

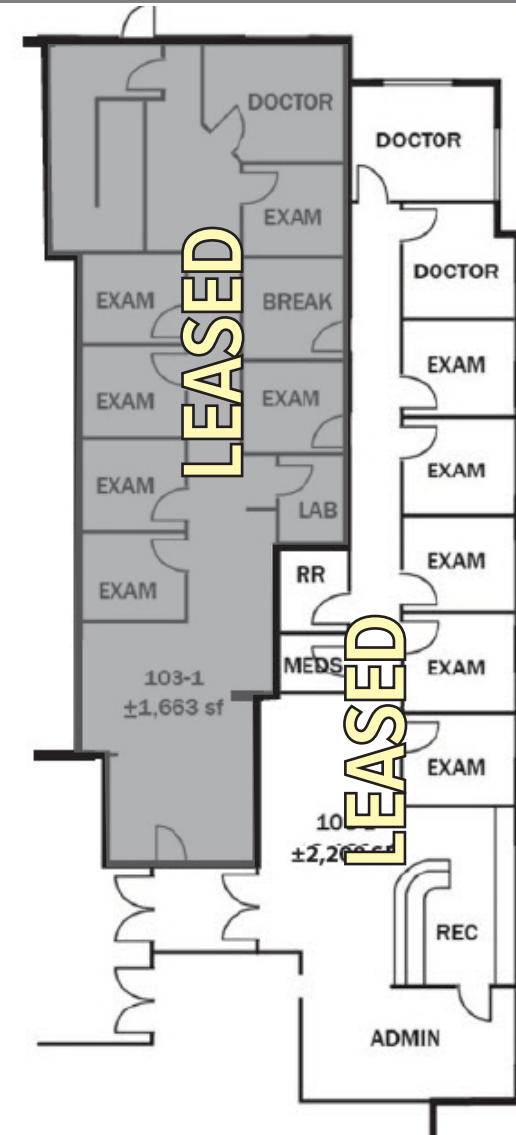
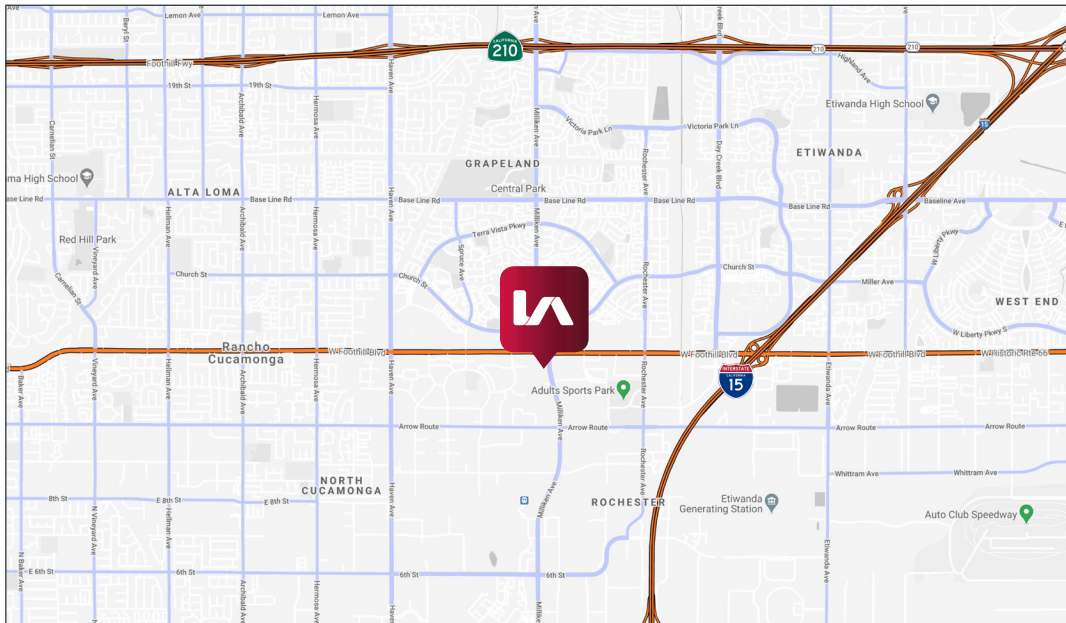

FOR MORE INFORMATION PLEASE CONTACT:

**Brian Melkesian**, Senior Vice President  
909.373.2943  
bmelkesian@lee-assoc.com  
DRE #01839590

**Greg Martin**, Senior Vice President  
909.373.2904  
gmartin@lee-assoc.com  
DRE #01001749

Lee & Associates® - Ontario  
3535 Inland Empire Blvd, Ontario, CA 91764 | 909.989.7771 | lee-assoc.com  
Corp ID 00976995

All information furnished regarding property for sale, rental or financing is from sources deemed reliable, but no warranty or representation is made to the accuracy thereof and same is submitted to errors, omissions, change of price, rental or other conditions prior to sale, lease or financing or withdrawal without notice. No liability of any kind is to be imposed on the broker herein.

# FOR SALE

# NNN LEASED INVESTMENT

## RENT ROLL

Suite	S.F.	Tenant	Lease Start	Lease End	Lease Rate	C.A.M. Fee	Property Taxes & Insurance	Rent Increase
103-1	±1,917	Day Creek Optometry	7/1/2016	2/28/2029	\$3,942.50	NNN	NNN	3% Annually (July 2021)
103-2	±2,209	Lindora, LLC	1/1/2019	2/29/2024	\$4,450.68	NNN	NNN	3% Annually (January 2022)
	±4,162				\$8,393.18 Month			Current NOI ±\$100,718.16



FOR MORE INFORMATION PLEASE CONTACT:

**Brian Melkesian**, Senior Vice President

909.373.2943

[bmelkesian@lee-assoc.com](mailto:bmelkesian@lee-assoc.com)

DRE #01839590

**Greg Martin**, Senior Vice President

909.373.2904

[gmartin@lee-assoc.com](mailto:gmartin@lee-assoc.com)

DRE #01001749

**Lee & Associates® - Ontario**  
3535 Inland Empire Blvd, Ontario, CA 91764 | 909.989.7771 | [lee-assoc.com](http://lee-assoc.com)  
Corp ID 00976995

All information furnished regarding property for sale, rental or financing is from sources deemed reliable, but no warranty or representation is made to the accuracy thereof and same is submitted to errors, omissions, change of price, rental or other conditions prior to sale, lease or financing or withdrawal without notice. No liability of any kind is to be imposed on the broker herein.