



**BLACK CREEK GROUP**

# Perris DC III

1330 NANDINA AVENUE, PERRIS, CA

251,366 Leasable SQ FT | Class A Warehouse Facility



## BUILDING HIGHLIGHTS

- +/- 251,366 SF on +/-23.96 Gross Acres of Land
- 223 Trailer Stalls
- ESFR Sprinkler System
- 32' Minimum Warehouse Clearance
- 37 Dock High Doors (9' x 10')
- 2 Grade Level Doors (12' x 14')
- Secured Concrete Truck Court
- Adjacent to March Air Reserve Base
- Direct I-215 Freeway Access

**CHRIS DEVRIES**

DRE# 01867314

chris.devries@colliers.com

949-724-5504

**IAN DEVRIES**

DRE# 01019686

ian.devries@colliers.com

949-724-5509



**DONALD KAZANJIAN**

DRE# 00860886

dkazanjian@lee-assoc.com

909-373-2929



**BLACK CREEK GROUP**

# Perris DC III

1330 NANDINA AVENUE, PERRIS, CA

251,366 Leasable SQ FT | Class A Warehouse Facility

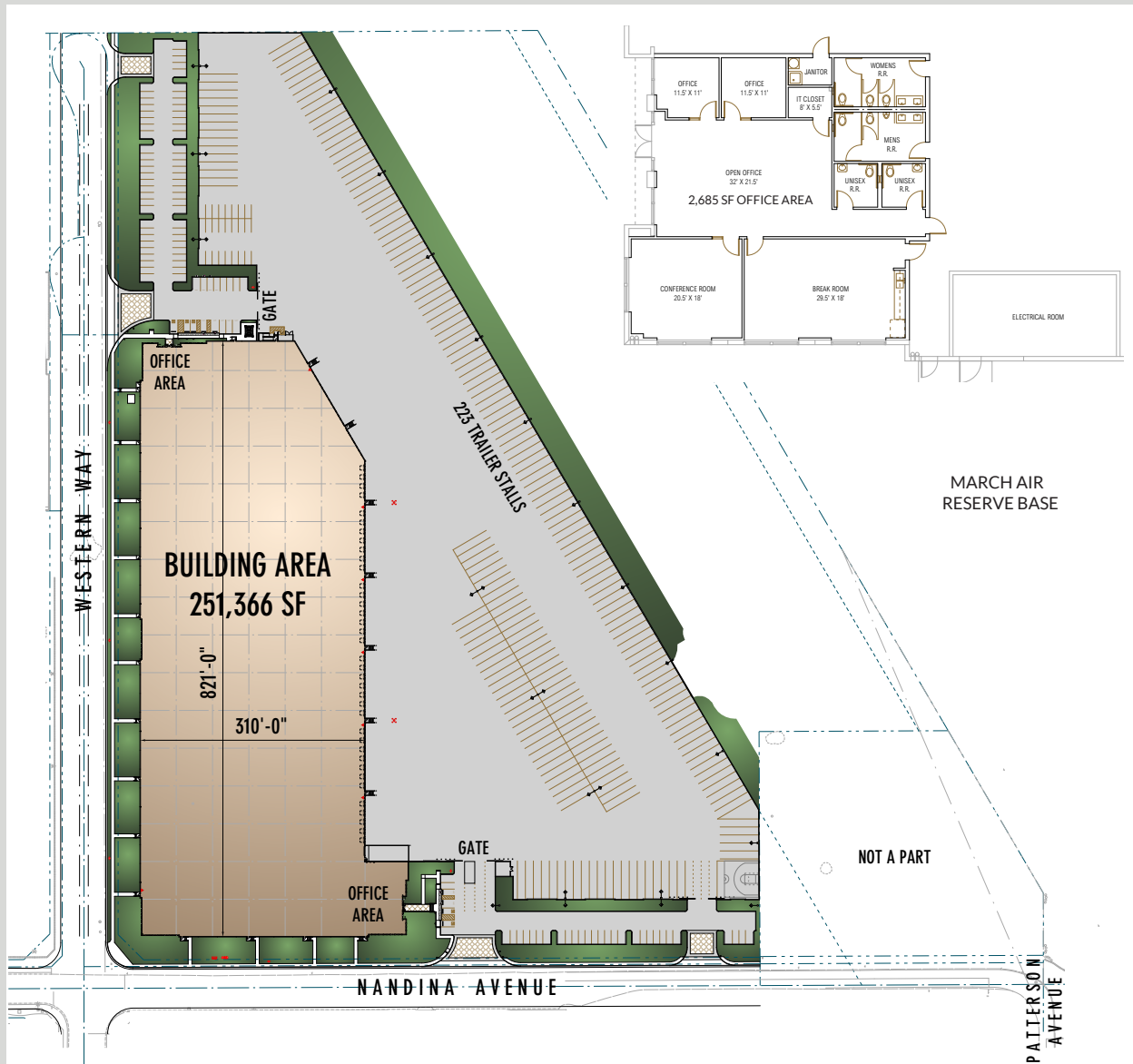

**CHRIS DEVRIES**

DRE# 01867314

chris.devries@colliers.com

949-724-5504

**IAN DEVRIES**

DRE# 01019686

ian.devries@colliers.com

949-724-5509



**DONALD KAZANJIAN**

DRE# 00860886

dkazanjian@lee-assoc.com

909-373-2929





BLACK CREEK GROUP

# Perris DC III

1330 NANDINA AVENUE, PERRIS, CA

251,366 Leasable SQ FT | Class A Warehouse Facility



CHRIS DEVRIES

DRE# 01867314

chris.devries@colliers.com

949-724-5504

IAN DEVRIES

DRE# 01019686

ian.devries@colliers.com

949-724-5509



DONALD KAZANJIAN

DRE# 00860886

dkazanjian@lee-assoc.com

909-373-2929