

# AVAILABLE FOR LEASE

±93,280 SF INDUSTRIAL BUILDING



**15220** CANARY AVENUE  
LA MIRADA | CALIFORNIA

## PROPERTY FEATURES:

- ±93,280 square foot industrial building
- ±4,980 square feet of office space
- ±162,479 square foot parcel
- Large fenced yard
- Shop restrooms
- Fully fire sprinklered
- Clear height:
  - 47,200 SF - 14' min. clearance
  - 46,080 SF - 21' min. clearance
- 1,200 & 400 amp electrical panels
- 7 dock high doors & 1 ground level door
- Rail spur possible

### For More Information, Contact:

**SCOTT SMITH**

Senior Vice President

License ID# 00796049

714.478.7405

ssmith@lee-associates.com

**JUSTIN SMITH**

Senior Vice President

License ID# 01504494

949.790.3151

jbsmith@lee-associates.com

**GRANT LABOUNTY**

Associate

License ID# 02086573

949.790.3120

glabounty@leeirvine.com

# AVAILABLE FOR LEASE

±93,280 SF INDUSTRIAL BUILDING

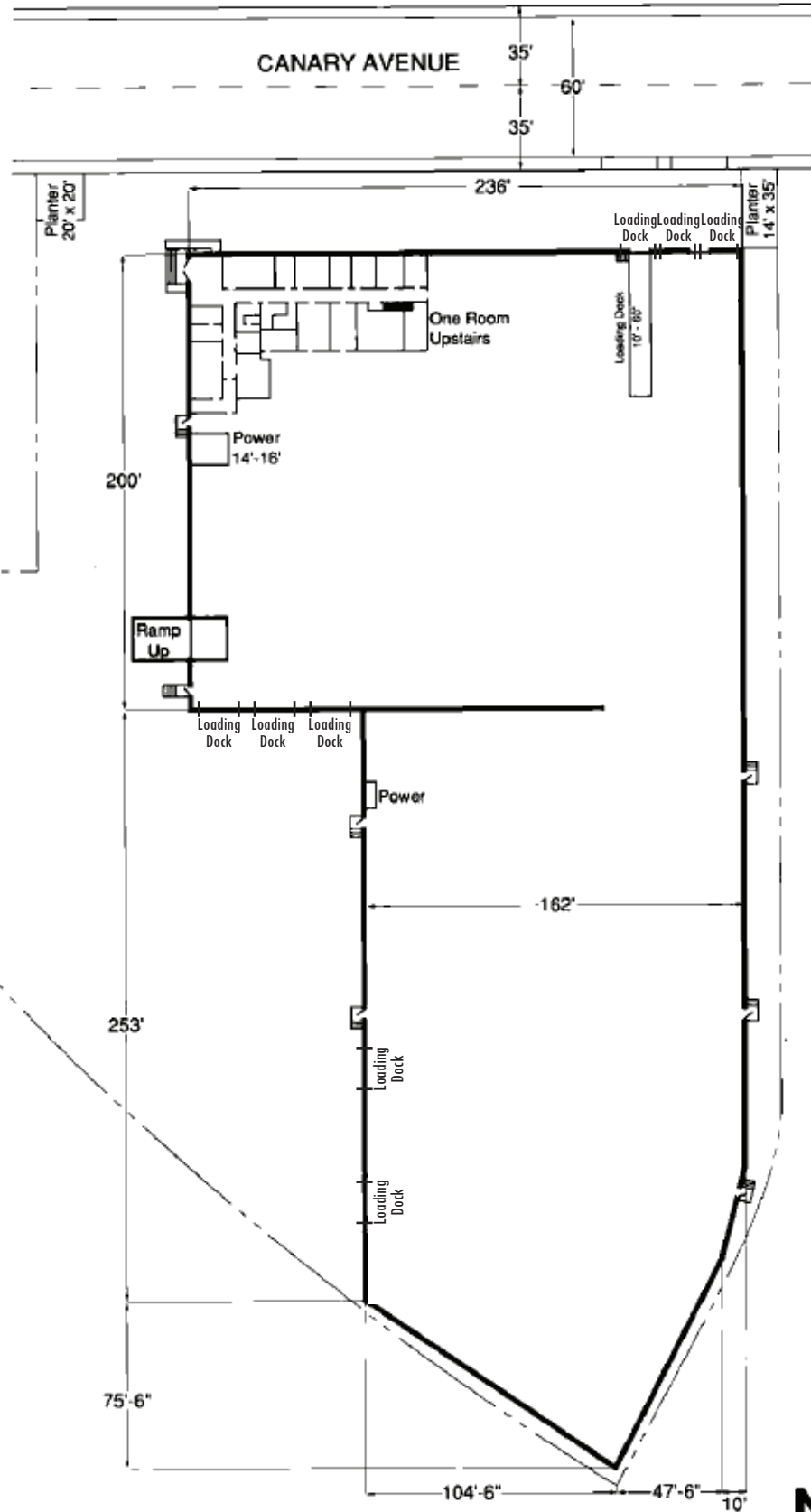

**For More Information, Contact:**

**SCOTT SMITH**

Senior Vice President  
 License ID# 00796049  
 714.478.7405  
 ssmith@lee-associates.com

**JUSTIN SMITH**

Senior Vice President  
 License ID# 01504494  
 949.790.3151  
 jbsmith@lee-associates.com

**GRANT LABOUNTY**

Associate  
 License ID# 02086573  
 949.790.3120  
 glabounty@leeirvine.com

# AVAILABLE FOR LEASE

±93,280 SF INDUSTRIAL BUILDING

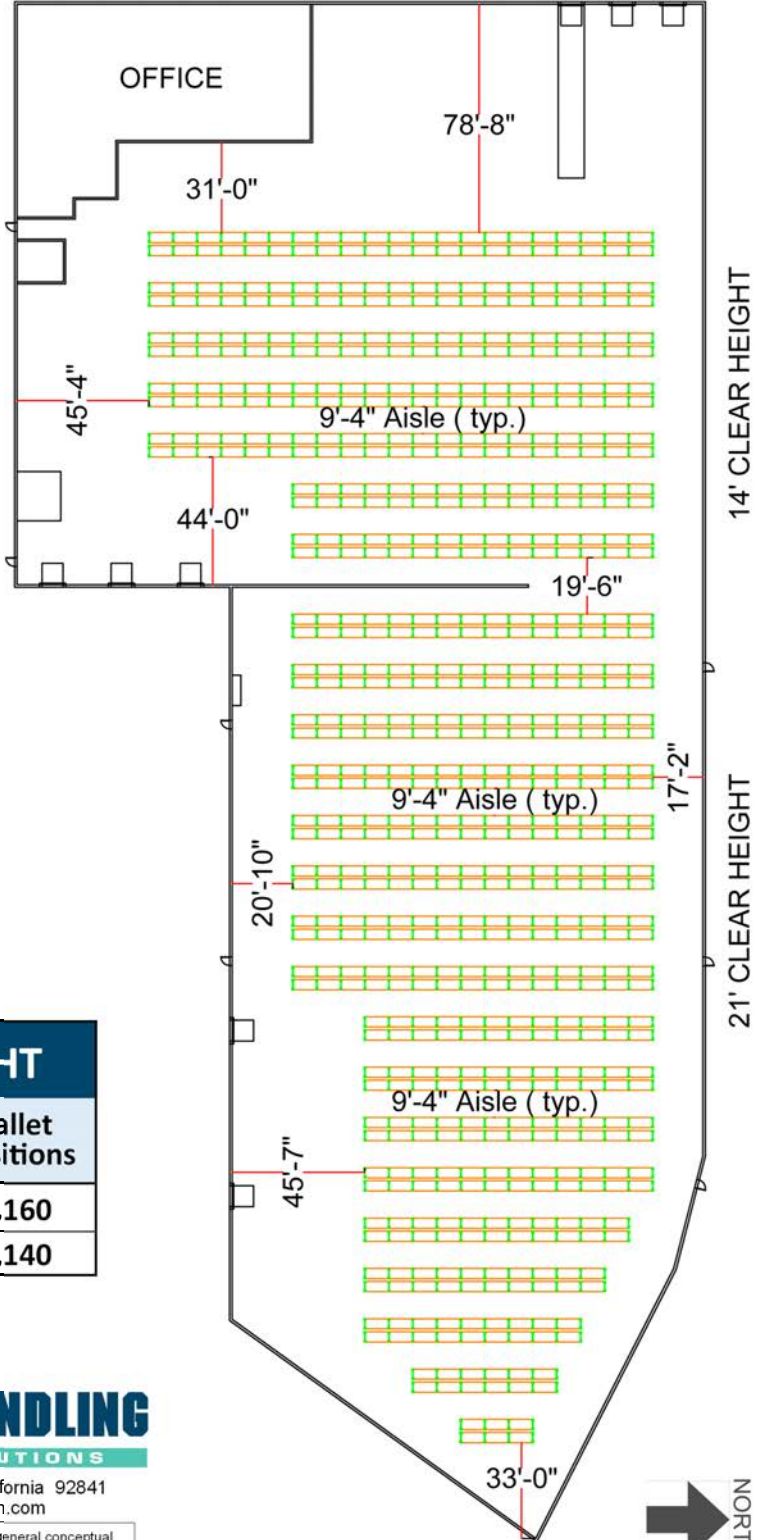
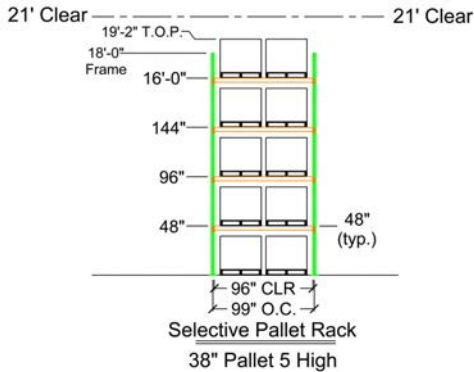
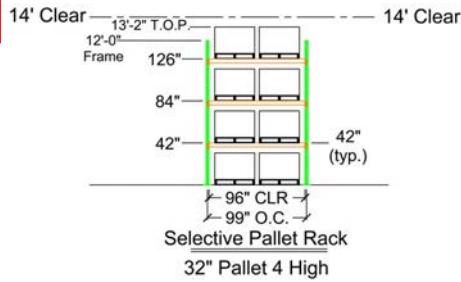

## 14' & 21' CLEAR HEIGHT

Clear Height	Number of Bays	Pallet Height	Pallet Positions
14'	270	32"	2,160
21'	414	38"	4,140

## CATALINA MATERIAL HANDLING

RACKING AND STORAGE SOLUTIONS

7351 Garden Grove Blvd, Unit B \* Garden Grove, California 92841  
 Tel: 562.997.1911 \* Email: fwelch@catalinamh.com

Disclaimer: the contained racking layout and elevation drawings illustrate general conceptual possibilities for marketing purposes only. Please contact Catalina Material Handling for specific design considerations of company products, forklift equipment and other design criteria.